

J. MICHAEL CAREY
City Clerk

FRANK T. MARTINEZ
Executive Officer

When making inquiries
relative to this matter
refer to File No.

01-1833

CD 9

January 7, 2003

Bureau of Engineering,
Land Development Group (with original resolution)
Councilmember Perry
Board of Public Works
Chief Legislative Analyst

RE: VACATION OF A PORTION OF AN L-SHAPED ALLEY EASTERLY OF MCKINLEY AVENUE
AND SOUTHERLY OF 42nd STREET

At the meeting of the Council held November 22, 2002, the following
action was taken:

Attached report adopted.....	_____
Motion adopted to approve attached report.....	_____
Motion adopted to approve attached communication.....	_____ X
Findings adopted.....	_____ X
Resolution adopted.....	_____ X
Categorically exempt.....	_____ X
Generally exempt.....	_____

J. Michael Carey

City Clerk
SW

steno\011833

CITY OF LOS ANGELES

CALIFORNIA



JAMES K. HAHN
MAYOR

Office of the
CITY CLERK
Council and Public Services
Room 395, City Hall
Los Angeles, CA 90012
Council File Information - (213) 978-1043
General Information - (213) 978-1133
Fax: (213) 978-1040

HELEN GINSBURG
Chief, Council and Public Services Division

PLACE IN FILES

JAN 15 2003

DEPUTY *nm*

FF *cut*
1/15/03



Rule 70

PUBLIC WORKS COMMITTEE

Report/Communication for Signature

Council File Number 01-1833

Committee Meeting Date 11-13-02

Council Date 11-22-02

COMMITTEE MEMBER	YES	NO	ABSENT
Councilmember Jan Perry, Chair	✓		
Councilmember Tom LaBonge			✓
Councilmember Pacheco			✓

Remarks vacate alley near McKinley & 42nd

Cynthia Landis, Legislative Assistant ★★★★★ Telephone 213-978-1074

COMMUNICATION

#67

File No. 01-1833

	<u>Yes</u>	<u>No</u>
Public Comments		XX

Recommendations for Council action:

1. FIND that this vacation is categorically exempt from the California Environmental Quality Act of 1970 pursuant to Article VII, Class 5(3) of the City's Environmental Guidelines.
2. ADOPT the FINDINGS of the City Engineer dated September 10, 2002, as the Findings of Council.
3. ADOPT the City Engineer's report dated September 10, 2002, that subject to the conditions enumerated therein, vacation proceedings (VAC-E1400772) BE INSTITUTED for the vacation of the public right-of-way for a portion of the L-shaped alley adjacent to Lots 4 through 6, John Taylor Tract and Lots 20 through 22, Mettlers Central Avenue Tract, lying easterly of McKinley Avenue and southerly of 42nd Street.
4. ADOPT the accompanying RESOLUTION TO VACATE No. 02-1400772 for this vacation.

Fiscal Impact Statement: The City Engineer reports that as of May 13, 2002, an estimated \$1,649.87 in charges have been expended in the investigation and processing of this proceeding. Approximately \$1,300 will be required from the General Fund to complete these proceedings. Since Los Angeles Administrative Code (LAAC), Section 7.46, exempts all governmental agencies from payment of fees, the processing of this report will be absorbed by the Bureau of Engineering.

On November 13, 2002, the Chair of the Public Works Committee considered a report of the City Engineer relative to initiating vacation proceedings for a portion of an L-shaped alley easterly of McKinley Avenue and southerly of 42nd Street.

The petitioner, the Los Angeles Unified School District (LAUSD), owner of the properties shown outlined in yellow on the map attached to the Council File, is requesting vacation of the public alley areas shown colored blue on said map. The petitioner plans to consolidate the vacation areas with its adjoining properties for an elementary school site. This vacation was approved by the City Planning Director on September 14, 2001. Pursuant to California Streets and Highways Code, Section 8334(b), this vacation can be processed under summary vacation proceedings since the areas lie within properties under one ownership and does not continue through such ownership or end touching the property of another.

Inasmuch as no opposition was expressed at the meeting, the Chair of the Public Works Committee concurred with the Department's recommendations without discussion and forwarded the matter to Council for its consideration.

Respectfully submitted,

COUNCILMEMBER JAN PERRY, Chair
Public Works Committee

CD 9

CAL
11/15/02
#011833

Mo.
ADOPTED
to App. Commun. Reclam.
NOV 22 2002

LOS ANGELES CITY COUNCIL
Finding & Resol. Adopted
Cat. Exempt. Approved

RESOLUTION TO VACATE NO. 02-1400772
(California Streets and Highways Code
Section 8334(b))

Vacation of the L-shaped alley (portion of) easterly of McKinley Avenue and southerly of 42nd Street.

The Council of the City of Los Angeles hereby finds and determines that the portion of the L-shaped alley adjacent to Lots 4 through 6, John Taylor Tract and Lots 20 through 22, Mettlers Central Avenue Tract, lying easterly of McKinley Avenue and southerly of 42nd Street is unnecessary for present or prospective public alley purposes subject to the reservation and exception of a permanent easement for public utility purposes; and

That the vacation thereof will not cut off all access to any of the real properties adjoining said public alleys; and the public interest, convenience and necessity require the summary vacation of said public alleys pursuant to Section 8334(b) of the California Streets and Highways Code.

The City Council hereby elects to proceed under this provision of said Code Section; and hereby resolves that said public alleys be and the same are vacated; and

The particular portions of the public alleys which are to be vacated and said permanent easement and right for public utility facilities to be reserved therefrom are described herein as follows:

That certain portion of the L-shaped alley 20 feet and 12 feet wide as shown on the maps of John Taylor Tract and Mettlers Central Avenue Tract, recorded in Book 8, page 108 and in Book 6, page 196, both of Maps, respectively, in the County Recorder of Los Angeles County, adjoining Lots 4, 5 and 6, of said John Taylor Tract, and Lots 20, 21 and 22 of said Mettlers Central Avenue Tract, bounded northerly by a line parallel with and distant 7 feet southerly measured at right angles from the northerly line of said Lot 6, John Taylor Tract; and bounded easterly by the southerly prolongation of the westerly line of the easterly 20 feet of said Lot 20, Mettlers Central Avenue Tract.

RESERVING and EXCEPTING therefrom, an easement for public utility purposes for the use of Pacific Bell over the entire vacation areas described hereinabove.

The City Clerk shall certify this Resolution and affix the City seal, and shall transmit a sealed copy of this Resolution to the Land Development Group of the Bureau of Engineering for recordation in the office of the County Recorder of Los Angeles County, upon compliance with the conditions for the vacation.

IT IS THEREFORE RESOLVED that from and after the recordation of this Resolution, the areas described hereinabove are vacated.

I certify that the foregoing Resolution was adopted by the Council of the City of Los Angeles at its meeting of
NOV 22 2002 , by a majority vote of all its members.

J. MICHAEL CAREY, City Clerk

Approved as to form and legality

By Elaine Iune
Deputy

Rockard J. Delgadillo, City Attorney

By Christy Numano-Hiura 9-6-02
Deputy Date

CHRISTY NUMANO-HIURA

Council File No. 01-1833



COUNCIL VOTE

Nov 22, 2002 11:31:16 AM, #4

Items for Which Public Hearings Have Not Been Held - Items 23-41
Voting on Item(s): 24-40
Roll Call

BERNSON	Absent
GALANTER	Yes
GARCETTI	Absent
GREUEL	Yes
HAHN	Absent
HOLDEN	Yes
LABONGE	Yes
*MISCIKOWSKI	Yes
PACHECO	Yes
PERRY	Yes
REYES	Yes
RIDLEY-THOMAS	Yes
WEISS	Yes
ZINE	Yes
PADILLA	Absent

Present: 11, Yes: 11 No: 0

PUBLIC WORKS COMMITTEE

SUGGESTED NOTIFICATION OF COUNCIL ACTION

Council File No. 01-1833

- ☒ Council Member(s) 9
- ☐ Petitioner/Communicant _____
- ☒ Board of Public Works (Mail Stop 465) _____
- ☐ Bureau of Accounting (Mail Stop 470) _____
- ☐ Bureau of Contract Administration (Mail Stop 480) _____
- ☒ Bureau of Engineering (Mail Stop 901) Land Development Group
w/avg nso
- ☐ Bureau of Street Services (Mail Stop 550) _____
- ☐ Bureau of Street Lighting (Mail Stop 545) _____
- ☐ Fire Department _____
- ☐ Police Department _____
- ☐ Controller _____
- ☐ Mayor (with/without file) _____
- ☒ Chief Legislative Analyst _____
- ☐ City Administrative Officer _____
- ☐ City Attorney (with / without file) _____
- ☐ City Clerk _____
- ☐ DOT, Liability Claims Management & Citywide Investigation Section (Mail Stop 725)
- ☐ _____
- ☐ _____

J. MICHAEL CAREY
City Clerk

FRANK T. MARTINEZ
Executive Officer

When making inquiries
relative to this matter
refer to File No.

CITY OF LOS ANGELES

CALIFORNIA



JAMES K. HAHN
MAYOR

Office of the
CITY CLERK
Council and Public Services
Room 395, City Hall
Los Angeles, CA 90012
Council File Information - (213) 978-1043
General Information - (213) 978-1133
Fax: (213) 978-1040

HELEN GINSBURG
Chief, Council and Public Services Division

C.F. 01-1833

November 6, 2002

TO WHOM IT MAY CONCERN:

The subject of the attached report from the City Engineer will be considered by the Public Works Committee of the City Council, City of Los Angeles at 9 A.M. or shortly thereafter on Wednesday, November 13, 2002, in Room 1050, City Hall (10th Floor), 200 North Spring Street, Los Angeles, CA 90012. Entrance to City Hall is from Main Street. Please allow time to pass through the security measures in place at the entrance.

If you cannot attend, but wish to have your opinion considered at the meeting, I must receive your mailed or faxed letter at the following address by no later than 8 A.M., Wednesday, November 13:

Council of the City of Los Angeles
Attn: Public Works Committee
City Hall
200 North Spring Street
Los Angeles, CA 90012

FAX: 213-978-1079

Cynthia A. Landis
Deputy City Clerk
(213) 978-1074

J. MICHAEL CAREY
City Clerk

FRANK T. MARTINEZ
Executive Officer

When making inquiries
relative to this matter
refer to File No.

CITY OF LOS ANGELES

CALIFORNIA



JAMES K. HAHN
MAYOR

Office of the
CITY CLERK
Council and Public Services
Room 395, City Hall
Los Angeles, CA 90012

Council File Information - (213) 978-1043
General Information - (213) 978-1133
Fax: (213) 978-1040

HELEN GINSBURG
Chief, Council and Public Services Division

01-1833

CD 9

September 18, 2002

PUBLIC WORKS COMMITTEE

Let the Race

In accordance with Council Rules, communication from the Bureau of Engineering relative to Vacation Request and Resolution to Vacate - L-shaped alley (portion of) easterly of McKinley Avenue and southerly of 42nd Street, was referred on September 18, 2002, to the PUBLIC WORKS COMMITTEE.

J. Michael Carey

City Clerk
amm



BOARD OF PUBLIC WORKS
MEMBERS

VALERIE LYNNE SHAW
PRESIDENT

ELLEN STEIN
VICE-PRESIDENT

JANICE WOOD
PRESIDENT PRO-TEMPORE

ADRIANA RUBALCAVA
COMMISSIONER

RONALD LOW
COMMISSIONER

JAMES A. GIBSON
SECRETARY

Department of Public Works
Bureau of Engineering
Land Development Group
201 North Figueroa Street, Ste. 200
Los Angeles, CA 90012

Honorable Jan Perry, Chair
Public Works Committee

Transmittal:

Transmitted herewith, is the City Engineer's report dated
September 10, 2002 for Council review and approval of:

VACATION REQUEST - VAC-E1400772 - Council File No. 01-1833 -
L-shaped Alley (Portion of) Easterly of McKinley Avenue and
Southerly of 42nd Street.

RECOMMENDATIONS:

1. Adopt the findings by the City Engineer on the attached City
Engineer report relative to initiating vacation proceedings.
This will include, but is not limited to the following:
 - a. This vacation is exempt from the California
Environmental Quality Act of 1970 pursuant to Article
VII, Class 5(3) of the City's Environmental Guidelines.
 - b. This vacation will be in substantial conformance with
the General Plan pursuant to City Charter Section 556
and determine that the vacation areas are not needed
for nonmotorized transportation facilities in
conformance with Section 892 of the California Streets
and Highways Code, and not necessary for present or
prospective public use per Section 8324 of the
California Streets and Highways Code.
2. Adopt the City Engineer report dated September 10, 2002
with the conditions contained therein.
3. Fiscal Impact Statement:

Section 7.46 of the Administrative Code exempts all
governmental agencies from payment of fees, processing

CITY OF LOS ANGELES
CALIFORNIA



JAMES K. HAHN
MAYOR

DEPARTMENT OF
PUBLIC WORKS

BUREAU OF
ENGINEERING

VITALY B. TROYAN, P.E.
CITY ENGINEER

650 SOUTH SPRING ST., SUITE 200
LOS ANGELES, CA 90014-1911
213-847-8766

<http://eng.lacity.org>

SEP 10 2002

Council File# 01-1833 -
Council District No. 9 -
Contact Person: Fred Viado
Phone # (213) 977-6954.

RECEIVED
CITY CLERK'S OFFICE
302 SEP 13 AM 9:01
CITY CLERK
DEPUTY

PUBLIC WORKS

SEP 18 2002



of this report will be absorbed by the Bureau of Engineering. Maintenance of the public easements by City forces will be eliminated.

4. There were no written objections to the vacation submitted for this project. Los Angeles Unified School District proposes to consolidate the vacation areas for an elementary school site.

Attachment:



Edmond Yew, Manager
Land Development Group

EY/FV/gt
H:\ldg\gtwp136

Office of the City Engineer
Los Angeles, California

To the Public Works Committee
Of the Honorable Council
Of the City of Los Angeles

SEP 10 2002

Honorable Members:

C. D. No. 9

SUBJECT:

Vacation Request and Resolution to Vacate - VAC-E1400772 -
Council File No. 01-1833 - L-shaped Alley (Portion of) Easterly
of McKinley Avenue and Southerly of 42nd Street.

RECOMMENDATIONS:

- A. That summary street vacation proceedings pursuant to the Public Streets, Highways and Service Easements Vacation Law be instituted for the vacation of the public rights-of-way indicated below and shown colored blue on the attached Exhibit "A":

A Portion of the L-shaped alley adjacent to Lots 4 through 6, John Taylor Tract and Lots 20 through 22, Mettlers Central Avenue Tract, lying easterly of McKinley Avenue and southerly of 42nd Street.
- B. That the Council find that the vacation is exempt from the California Environmental Quality Act of 1970, pursuant to Article VII, Class 5(3), of the City's Environmental Guidelines.
- C. That, in conformance with Section 556 of the City Charter, the Council make the findings that the vacation is in substantial conformance with the purposes, intent and provisions of the General Plan as determined by the Director of Planning on September 14, 2001.
- D. That, in conformance with Section 892 of the California Streets and Highways Code, the Council determine that the vacation areas are not needed for nonmotorized transportation facilities.
- E. That, in conformance with Section 8324 of the California Streets and Highways Code, the Council determines that the vacation areas are not necessary for present or prospective public use.
- F. That the Council adopt the City Engineer's report with the conditions contained therein.

- G. That Resolution to Vacate No. 02-1400772 for this vacation be adopted by the City Council.
- H. That following Council adoption, Resolution to Vacate No. 02-1400772, be transmitted to the Land Development Group for further processing and that the City Engineer be permitted to make minor amendments to the Resolution to reflect the actual vacation area limits and the easement and right being reserved by the Resolution.
- I. That the Resolution to Vacate not be recorded until the conditions established for the vacation are complied with.

FISCAL IMPACT STATEMENT

As of May 13, 2002, an estimated \$1,649.87 in charges have been expended in the investigation and processing of this proceeding. Approximately \$1,300.00 will be required from the General Fund to complete these proceedings. Since the Section 7.46 of the Administrative Code exempts all governmental agencies from payment of fees, the processing of this report will be absorbed by the Bureau of Engineering.

NOTIFICATION:

That notification of the time and place of the Public Works Committee meeting to consider this request be sent to:

- 1. Los Angeles Unified School District
Attn: Scot Graham, Director of Real Estate
355 S. Grand Avenue, Suite #500
Los Angeles, CA 90071
- 2. Creative Neighbors Always Sharing, Inc.
8224 S. Broadway
Los Angeles, CA 90003
- 3. Jorge Espindola
977 East 42nd Place
Los Angeles, CA 90011
- 4. Sarah Munoz
992 East 42nd Street
Los Angeles, CA 90011

CONDITIONS FOR STREET VACATION:

The Conditions specified in this report are established as the requirements to be complied with by the petitioner for this vacation. Vacation proceedings in which the conditions have not been completed within 180 days of the Council's action on the City Engineer's report, shall be terminated, with no further Council action.

1. That a 7-foot wide strip of land be dedicated as public street along the southerly side of 42nd Street easterly of the north-south alley to be vacated adjoining the petitioner's properties to complete a 32-foot wide half street dedication.
2. That the petitioner dedicate a 20-foot wide replacement alley connecting 42nd Street to the westerly terminus of the offsite unvacated portion of the east-west alley.
3. That the following improvements be constructed adjoining the petitioner's properties in a manner satisfactory to the City Engineer:
 - a) Construct a 20-foot and variable width replacement alley with standard alley improvements including a concrete longitudinal gutter along the centerline of the 20-foot wide replacement alley dedication.
 - b) Construct standard street improvements along the southerly side of 42nd Street to complete a 22-foot half roadway including a 10-foot wide concrete sidewalk, curb and gutter, a type II driveway from the alley being vacated to the existing improvements to the east.
 - c) Close off any unused driveways, repair any broken and/or offgrade sidewalk, curb and gutter and trim uprooting tree roots and reconstruct sidewalk to grade along the southerly side of 42nd Street.
 - d) Repair any broken and/or offgrade sidewalk, curb and gutter along the northerly side of 42nd Place.
 - e) Construct a handicapped access ramp at the southeast corner of McKinley Avenue and 42nd Street.

- f) Repair any broken and/or offgrade sidewalk, curb and gutter along the easterly side of McKinley Avenue.
 - g) Construct a standard driveway apron or close off the alley being vacated at 42nd Street with standard street improvements including sidewalk, curb and gutter.
- 4. That arrangements be made with Pacific Bell for the removal of affected facilities or the providing of easements or rights for the protection of affected facilities to remain in place.
 - 5. That street lighting facilities be installed as may be required by the Bureau of Street Lighting.
 - 6. That street trees be planted and tree wells be installed as may be required by the Street Tree Division of the Bureau of Street Services.

TRANSMITTALS:

- 1. Council File No. 01-1833, with application dated July 11, 2001, from Scot Graham of Los Angeles Unified School District.
- 2. Resolution to Vacate No. 02-1400772.

DISCUSSION:

Request: The petitioner, the Los Angeles Unified School District, owners of the properties shown outlined in yellow on Exhibit "A", is requesting the vacation of the public alley areas shown colored blue.

The petitioner plans to consolidate the vacation areas with their adjoining properties for an elementary school site.

Resolution to Vacate: The Resolution to Vacate will be recorded upon compliance with the conditions established for this vacation.

Zoning and Land Use: The properties adjoining the alleys being vacated to the north and to the south are zoned (Q)C2-1VL and (Q)R3-1, respectively and are presently vacant lots. The properties to the west are zoned M1-1VL and are also vacant lots.

Description of Areas to be Vacated: The areas sought to be vacated are the unimproved alleys (L-shaped) adjacent to Parcel A, Parcel Map L.A. No. 4240. The alleys being vacated are fenced off with chain-link fence.

Adjoining Street and Alley: 42nd Street is an improved local street dedicated 50 feet and 57 feet in width with a 34-foot wide roadway, curbs and sidewalks on both sides. McKinley Avenue is an improved local street dedicated 60 feet in width with a 40-foot wide roadway, curbs and sidewalks on both sides.

Surrounding Properties: The adjoining owners, Lots 19 and 26, Mettler's Central Avenue Tract, have been notified of the proposed street vacation.

Effects of Vacation on Circulation and Access: The vacation of the alleys should have no adverse effect on vehicular circulation or access, since the alleys are unimproved and fenced off on both ends.

The alleys are also not needed for the use of pedestrians, bicyclists or equestrians.

Objections to the Vacation: There were no written objections to the vacation submitted for this project.

Reversionary Interest: No determinations of the underlying fee interest of the vacation areas have been made as to title or reversionary interest.

Dedications and Improvements: It will be necessary that the petitioner provides for the dedications and improvements as outlined under Conditions.

Sewers and Storm Drains: There are no existing sewer and storm drain facilities within the areas proposed to be vacated.

Public Utilities: Pacific Bell maintains facilities in the areas proposed to be vacated. Southern California Gas Company did not respond to the Bureau of Engineering's referral letter dated August 28, 2001.

Tract Map: Since the required dedication can be acquired by separate instruments and the necessary improvements can be constructed under separate permit processes, the requirement for the recordation of a new tract map could be waived.

City Department of Transportation: The Department of Transportation states that based on traffic considerations, the vacation is not opposed if a 20-foot wide north-south alley is

constructed connecting 42nd Street to the westerly terminus of the unvacated portion of the east-west alley, together with a corner cut at the northeast corner where the two alleys intersect. In addition, that through the requirements of a tract map or by other means, provisions are made for (1) lot consolidation, (2) driveway and access approval by the Department of Transportation, (3) any additional dedications and improvements necessary to bring all adjacent streets into conformance with the City's Standard Street Dimensions.

City Fire Department: The Fire Department has no objection to this vacation.

Department of City Planning: The Director of Planning, on September 14, 2001, recommended that the vacation be approved.

Summary Vacation: Pursuant to Section 8334(b) of the California Streets and Highways Code, this vacation could be processed under summary vacation proceedings since the vacation areas lie within properties under one ownership and does not continue through such ownership or end touching the property of another.

Conclusion: The vacation of the public alleys (L-shaped) as shown colored blue on the attached Exhibit "A" could be conditionally approved based upon the following:

1. They are unnecessary for present or prospective public use.
2. They are not needed for vehicular circulation or access.
3. They are not needed for nonmotorized transportation purposes.

Respectfully submitted,



Edmond Yew, Manager
Land Development Group
Bureau of Engineering

EY/FV/gt
H:\ldg\GTWP136

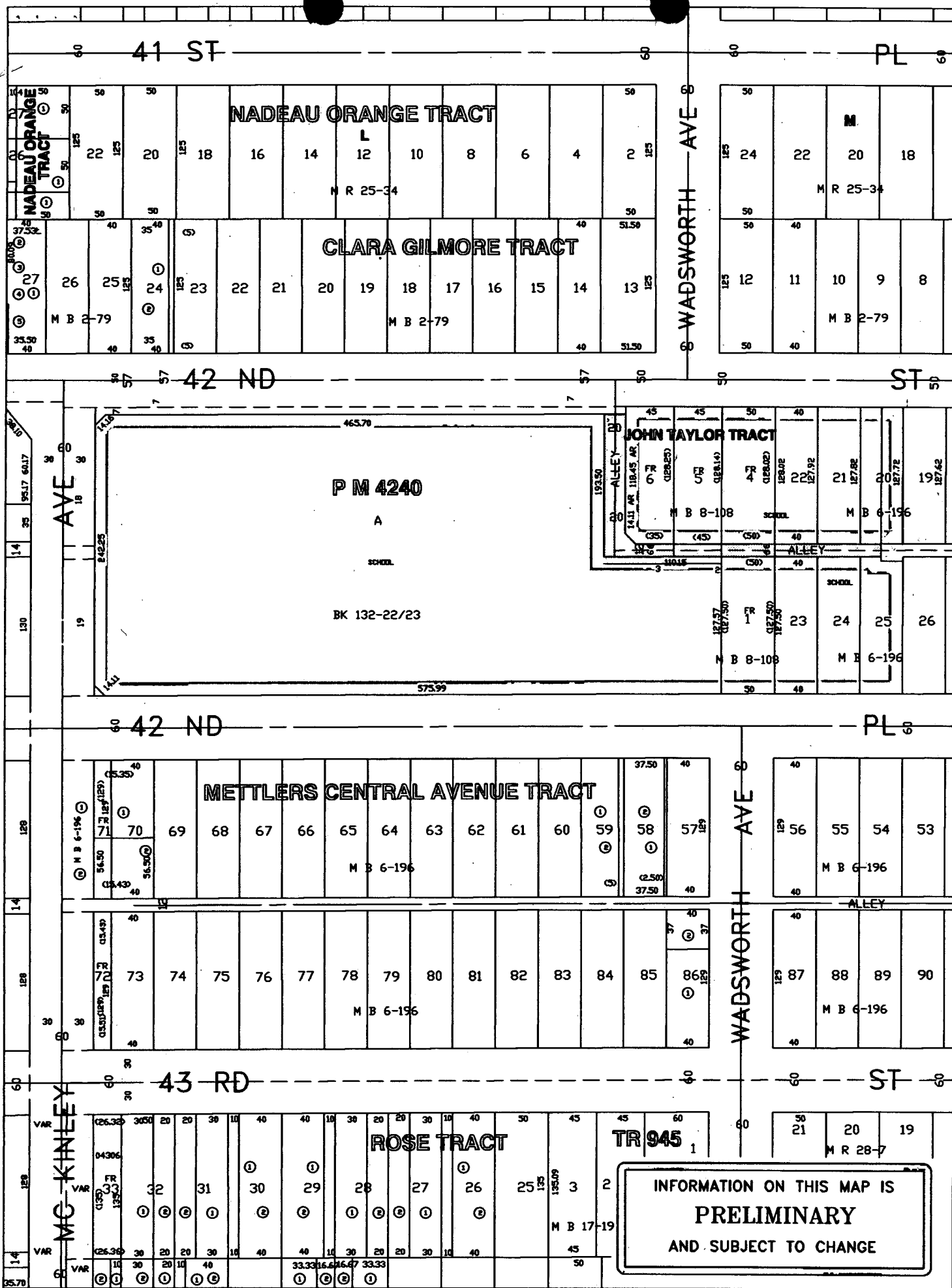

TITLE: L-SHAPED ALLEY (PORTION OF) EASTERLY OF MC KINLEY AVENUE AND SOUTHERLY OF 42ND STREET.

WORK OEDER NO. VAC- E1400772
COUNCIL FILE NO. 01-1833
COUNCIL DIST. 9 DIV. INDEX 164
ENG. DIST. CENTRAL T.G. 674-E3
DISTRICT MAP 114 A 209



CITY OF LOS ANGELES
DEPT. OF PUBLIC WORKS
VITALY B. TROYAN
CITY ENGINEER

gh

CITY OF LOS ANGELES
INTER-DEPARTMENTAL CORRESPONDENCE

Date: 7/29/02

To: Edmund Yew, Manager
Land Development Group
634 S. Spring St., Ste.400
Stop 901

Kerney & Marine, Jr.
From: Kerney Marine, Jr., Manager
Private Development Division
Bureau of Street Lighting

SUBJECT: STREET LIGHTING REQUIREMENTS FOR DISCRETIONARY ACTIONS

CASE No.: VAC E1400772 *Mc KINLEY*
Por/o L-shaped A/E/o Mickingley Av & S/o 42nd St

The Bureau of Street Lighting's recommended condition of approval for the subject city planning case is as follows:

Required -(1) 42nd St., (1) 42nd Place; if street widening, relocate/upgrade existing lights -(4) 42nd St., (4) 42nd Place.

These street lighting requirements are estimates and may be modified slightly during the plan check process based on illumination calculations. All projects are subject to the Proposition 218 ballot process which will be conducted by this Bureau after construction is complete.

ESTIMATED CONSTRUCTION COST:

NO Street Widening	\$7,200
Street Widening REQUIRED	\$26,800
TOTAL CONSTRUCTION COST	\$34,000

ESTIMATED PLAN CHECK FEES: \$2,700

CITY OF LOS ANGELES
INTER-DEPARTMENTAL CORRESPONDENCE

772 gh

October 17, 2001

TO: Vitaly B. Troyan, City Engineer
Department of Public Works, Bureau of Engineering

Attention: Edmond Yew

FROM: Fire Department

SUBJECT: **STREET VACATION NO. E1400772**
(Alley Easterly of McKinley Ave.)

Subject property has been investigated by members of the Fire Department.

RECOMMENDATION:

The Fire Department has no objection to this vacation.

WILLIAM R. BAMATTRE
Fire Chief

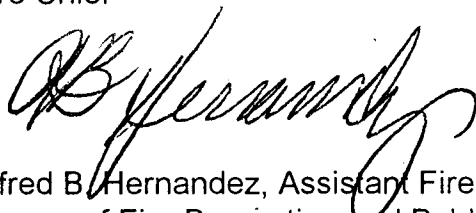

Alfred B. Hernandez, Assistant Fire Marshal
Bureau of Fire Prevention and Public Safety

ABH:RS:gm
c:St Vac-E1400772

RECEIVED
DEVELOPMENT SERVICES DIV.
LAND DEVELOPMENT SECTION
01 OCT 23 AM 10:11

772 *jk*

CITY OF LOS ANGELES
INTER-DEPARTMENTAL CORRESPONDENCE

42nd St &
McKinley Ave.

Date: October 24, 2001

To: Edmond Yew, Manager
Land Development Group
Bureau of Engineering

From: *Robert T. Takasaki*
Robert T. Takasaki, Senior Transportation Engineer
Department of Transportation

Subject: **L-SHAPED ALLEY (PORTION OF) EASTERLY OF MCKINLEY AVENUE
AND SOUTHERLY OF 42ND STREET - VAC-E1400772**

Based on a recent field investigation and traffic considerations, the vacation of the area shaded in blue on your map is not opposed if a 20-foot wide north-south alley is constructed connecting 42nd Street to the westerly terminus of the unvacated portion of the east-west alley, with a corner cut at the northeast corner where the two alleys intersect. In addition, that through the requirements of a tract map or by other means, provisions are made for (1) lot consolidation, (2) driveway and access approval by the Department of Transportation and (3) any additional dedications and improvements necessary to bring all adjacent streets into conformance with the City's Standard Street Dimensions.

V1400772.WPD

cc: Council District No. 9
Southern District, DOT

RECEIVED DIV.
DEVELOPMENT SERVICES
AND DEVELOPMENT SECTION
01 NOV 15 AM 11:49

BOARD OF PUBLIC WORKS
MEMBERS

—
ELLEN STEIN
PRESIDENT
VALERIE LYNNE SHAW
VICE-PRESIDENT
MARIBEL MARIN
PRESIDENT PRO-TEM
STEVEN CARMONA
WOODY FLEMING
—
JAMES A. GIBSON
SECRETARY

CITY OF LOS ANGELES
CALIFORNIA



JAMES K. HAHN
MAYOR

772 *jk*
DEPARTMENT OF
PUBLIC WORKS
BUREAU OF
ENGINEERING

VITALY B. TROYAN, P.E.
CITY ENGINEER
650 SOUTH SPRING ST., SUITE 200
LOS ANGELES, CA 90014-1911

714614

The Metropolitan Water District
of Southern California
Attention Chief Engineer
P.O. Box 54153
Los Angeles, CA 90054

L-shaped Alley (Por/o) Ely/o
McKinley Ave. & Sly/o 42nd St. -
VAC-E1400772.

AUG 28 2001

NOTICE OF PROPOSED VACATION

This office is investigating the following:

- (x) A request for the vacation of the area(s) shown colored blue on the attached map.
- () The vacation of the area(s) shown colored green.

You must notify this office in writing within 45 days of the above date at the address shown below if there are in-place public utility facilities in the vacation area that are in use and require protection. If we do not receive your written response within 45 days of the above date, we will assume you do not object to the vacation of the requested area as shown on the attached map and you do not maintain any facilities within this area.

Further information concerning the vacation may be obtained from Gus Dembegiotes of the Street Vacation Investigation Section on telephone (213) 485-5368 or in 634 S. Spring Street, Suite 400, Los Angeles, CA 90014, Stop number 901.

Edmond Yew, by k-z
Edmond Yew, Manager
Land Development Group
Bureau of Engineering

EY/FV/gt

Enc.

METROPOLITAN HAS NO EXISTING OR PROPOSED
FACILITIES WITHIN THE AREA AND HAS NO OBJECTION
TO THE VACATION.

Signed: *Eusana M. Walters*

OCT 5 2001

Date: _____

RECEIVED
DEVELOPMENT SERVICES DIV.
LAND DEVELOPMENT SECTION
01 OCT 16 AM 10:32

Pacific Bell Telephone Company
41 S. Chester Avenue
Room 202
Pasadena, California 91106

PACIFIC BELL

772 Jh
SBC
global
network

October 4, 2001

Mr. Edmond Yew
City of Los Angeles
Land Development Group
634 South Spring Street, Suite 400
Los Angeles, CA 90014

RE: Vacation No.: VAC-E1400772

Dear Mr. Yew:

This is with reference to your letter of August 28, 2001, regarding the proposed vacation of L-shaped alley (Por/o) Ely/o McKinley Ave. & Sly/o 42nd St. - Vacation District - VAC-E1400772.

Pacific Bell currently maintains communication facilities within the subject area, as shown on the attached map, and asks that an easement be obtained over the entire area. Therefore, we do object to this proceeding until a reservation for our facilities can be included within the Resolution.

Our suggestion for the appropriate language is:

"An easement for Pacific Bell Telephone Company to from time to time construct, maintain, operate, replace, remove, and renew such aerial and underground communication facilities (including ingress thereto and egress therefrom) consisting of poles, anchors, guys, cables, wires, crossarms, conduits, manholes, handholes, markers, pedestals, terminal equipment cabinets, electrical conductors and necessary fixtures and appurtenances."

We will require a copy of the recorded Resolution once the vacation is completed in order to maintain our records.

Thank you for notifying Pacific Bell Telephone Company.

Sincerely,

Gloria Muñoz

Gloria Muñoz
Right of Way Manager
(626) 356-7328

Enclosure

E1400772

RECEIVED
DEVELOPMENT SERVICES DIV.
LAND DEVELOPMENT SECTION
01 OCT 11 AM 10:04

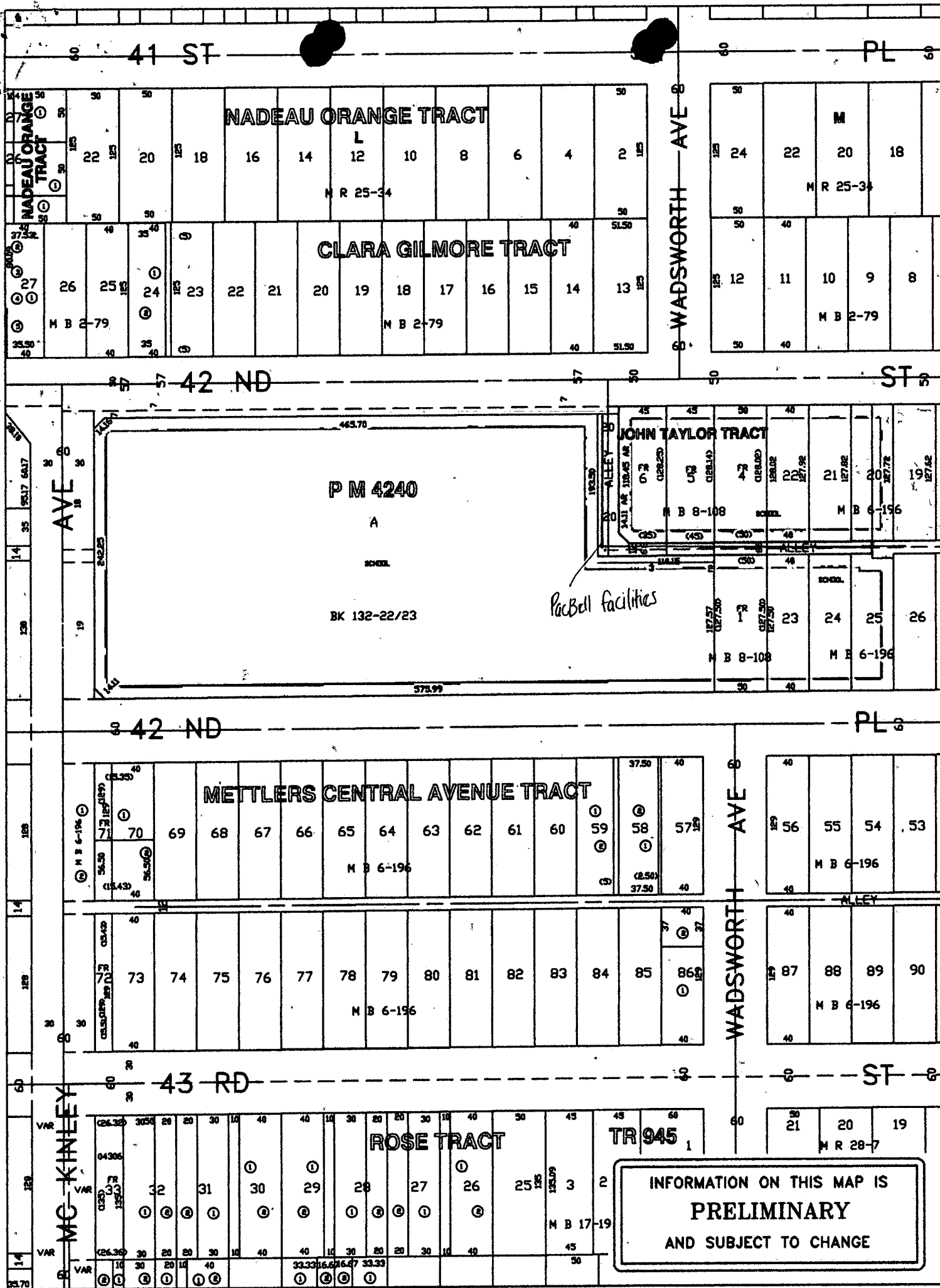

TITLE: L-SHAPED ALLEY (PORTION OF) EASTERLY OF MC KINLEY AVENUE AND SOUTHERLY OF 42ND STREET.

WORK OEDER NO. VAC- E1400772
COUNCIL FILE NO. _____
COUNCIL DIST. 9 DIV. INDEX 164
ENG. DIST. CENTRAL T.G. 674-E3
DISTRICT MAP 114 A 209



CITY OF LOS ANGELES
DEPT. OF PUBLIC WORKS
VITALY B. TROYAN
CITY ENGINEER



Community Planning Bureau

City Hall, Room 667 • 200 N. Spring Street, • Los Angeles, CA 90012



Council District: 9
Plan Area: Southeast Los Angeles

TO: Edmund Yew, Manager
Land Development Group
Bureau of Engineering

FROM: Los Angeles City Planning Commission

SUBJECT: VACATION OF PUBLIC RIGHT-OF-WAY - VAC-E1400772

PROJECT LOCATION: L-Shaped Alley (Portion Of) Easterly of McKinley Avenue and Southerly of 42nd Street

CHARTER SECTIONS 556 AND 558

The proposed project is in substantial conformance with the purposes, intent and provisions of the City's General Plan and the Southeast Los Angeles Community Plan, an element of the General Plan, in that it would serve the public interest and the objectives of the Community Plan, and would not adversely impact the surrounding community.

The environmental (CEQA) status of the proposed project, as determined by the Lead Agency, is:

Categorical Exemption - Article VII, Class 5(3)

RECOMMENDATION

Under the authority granted by Section 559 of the City Charter and the City Planning Commission action of July 27, 2000 delegating authority to the Director of Planning to act on behalf of the Commission on certain matters, I approve the subject project and recommend that it be approved by the City Council.

CON HOWE
Director of Planning

By: 
David Gay, Principal City Planner

Date: 9/18/01

RECEIVED
DEVELOPMENT SERVICES DIV.
DEVELOPMENT SECTION
SEP 18 PM 2:08

CITY OF LOS ANGELES
INTER-DEPARTMENTAL CORRESPONDENCERECEIVED
CITY OF LOS ANGELES

AUG 30 2001

CITY PLANNING DEPT.
PLANNING COMMISSION

Date:

AUG 28 2001

To: City Planning Commission
221 N. Figueroa Street, Room 1600From: *Edmond Yew*
Edmond Yew, Manager
Land Development Group
Bureau of Engineering
Stop 901Subject: L-shaped Alley (Portion of) Easterly of McKinley
Avenue and Southerly of 42nd Street - VAC-E1400772.

This office is investigating the following:

- (x) A request for the vacation of the area(s) shown colored blue on the attached map.
- () The vacation of the area(s) shown colored green.

Your report and recommendation only as to whether the proposed vacation is consistent with the General Plan pursuant to Section 15.00 of the Municipal Code is requested for inclusion in my report to the Public Works Committee of the City Council. Your response to this letter must be received within 50 days of the date of this letter in accordance with with Section 15D of the Municipal Code. If we do not receive your written response within the allotted time, our report will state that your office has failed to respond within the 50-day time limit.

This vacation area should also be reviewed as to its need for nonmotorized transportation facilities as required under Section 892 of the State streets and Highways Code.

Environmental Considerations:

- (x) This vacation is exempt from the California Environmental Quality Act of 1970, pursuant to Article VII, Class 5(3) of the City's Guidelines.
- () Environmental Impact Report is being prepared by the applicant.
- () No environmental determination has been made for the project at this time. However, your report is requested only in terms of whether the street vacation is consistent with the purpose and intent of the General Plan.

EY/FV/gt

Enc.

APPLICATION FOR VACATION OF PUBLIC RIGHT OF WAY
ORIGINAL - (No copies or faxes)

DATE: July 11, 2001

PROJECT LOCATION AND DESCRIPTION:

- (1) Area proposed to be vacated is: Alley Easterly of McKinley Avenue
(Street/Avenue/Boulevard/alley/walk: N/S/E/W of)
and is located between:
42nd Street and 42nd Place
(Street, Avenue, Boulevard or other limit) (Street, Avenue, Boulevard or other limit)
- (2) The vacation area lies within or is shown on:
- (a) Engineering District: (check appropriately)
(x) Central () Harbor () Valley () West Los Angeles
- (b) Council District No. 9
- (c) District Map. No. 114-B-209
- (d) Thomas Guide Reference: 674, E-3
(Page No.) (Letter/Number at intersection pt.)
- (3) Area (in sq. ft.) of the proposed vacation area is approx. 5,621 sq. ft.
- (4) Purpose of vacation (future use of vacation area) is: Consolidation of
properties for an elementary school site.
- (5) Vacation is in conjunction with: (Check appropriately)
(x) Revocable Permit () Tract Map () Parcel Map () Zone Change
() Other: See 4

PETITIONER / APPLICANT:

- (6) Petitioner(s): Los Angeles Unified School District
Print Name(s) of Petitioner(s) in full - Name or Company Name
- Signature(s): Scot Graham, Director of Real Estate
- (7) Mailing Address: 355 S. Grand Avenue, Suite 500, Los Angeles, CA 90071
- (8) Daytime phone number of petitioner is: (213) 633-7535
FAX number: (213) 633-7546
E-mail Address: _____
- (9) Petitioner is: (check appropriately) () Owner OR (x) Representative of Owner

OWNERSHIPS:

- (10) Name(s) and address of the Owner(s) applying for vacation is/are:
Same as above
- _____

- Print Name(s) and Address of Owner(s) in Full Signature(s)
(If Owner is Petitioner, Indicate "Same as above")

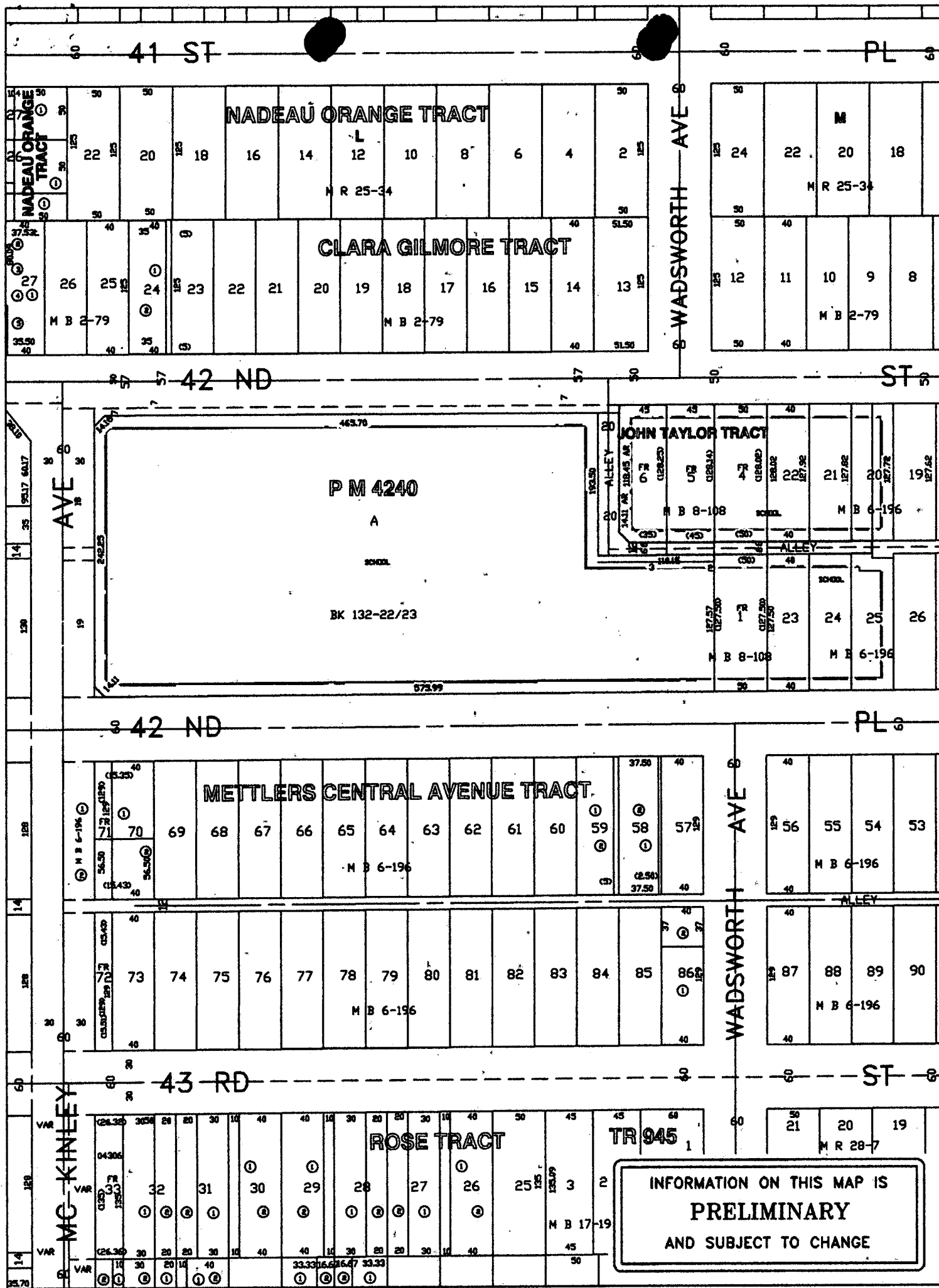

TITLE: L-SHAPED ALLEY (PORTION OF) EASTERLY OF MC KINLEY AVENUE AND SOUTHERLY OF 42ND STREET.

WORK ORDER NO. VAC- E1400772
 COUNCIL FILE NO. _____
 COUNCIL DIST. 9 DIV. INDEX 164
 ENG. DIST. CENTRAL T.G. 674-E3
 DISTRICT MAP 114 A 209



CITY OF LOS ANGELES
 DEPT. OF PUBLIC WORKS
 VITALY B. TROYAN
 CITY ENGINEER

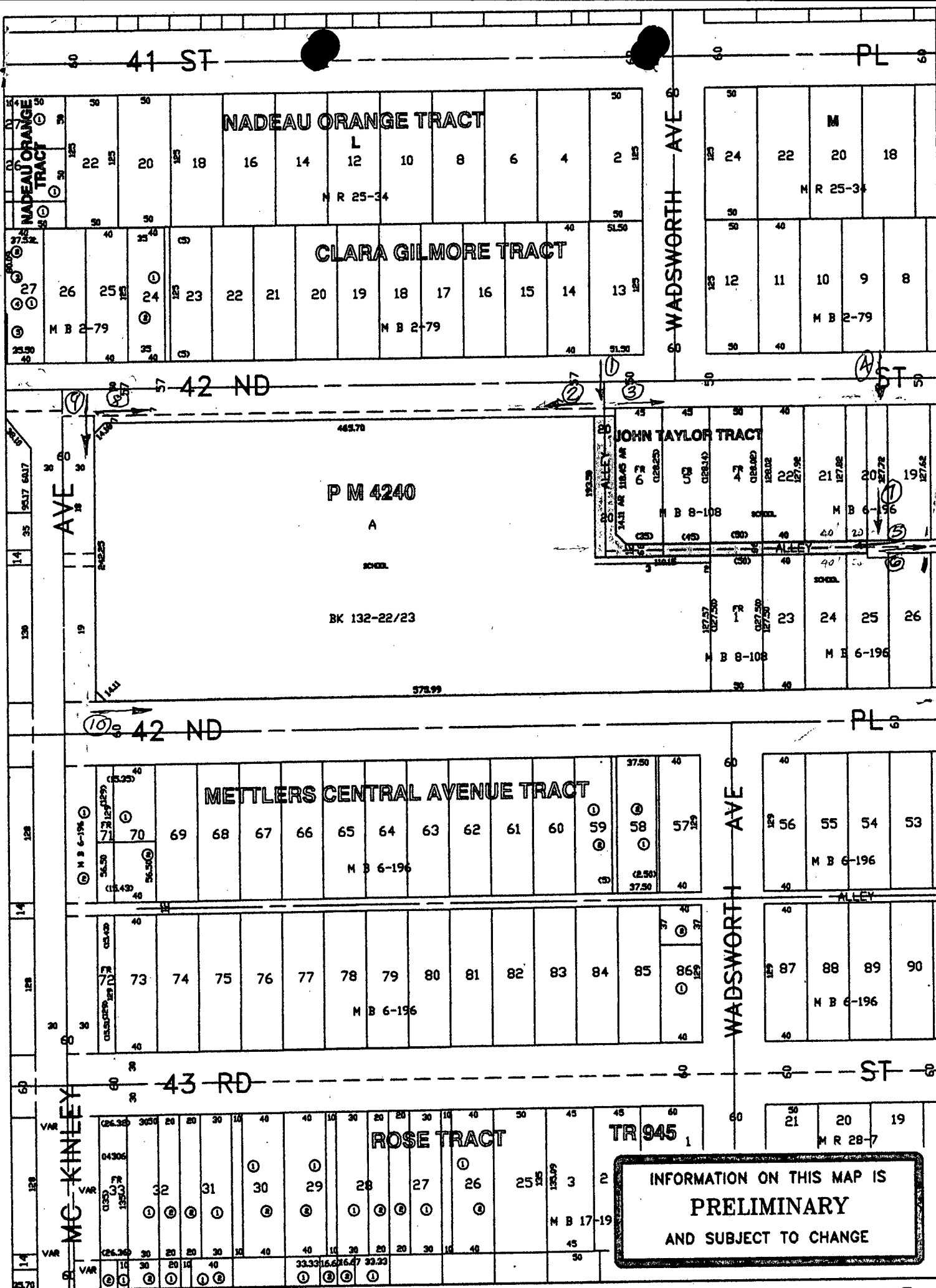

TITLE: L-SHAPED ALLEY (PORTION OF) EASTERLY OF MC KINLEY AVENUE
AND SOUTHERLY OF 42ND STREET.

WORK OEDER NO. VAC- E1400772
COUNCIL FILE NO. _____
COUNCIL DIST. 9 DIV. INDEX 164
ENG. DIST. CENTRAL T.G. 674-E3
DISTRICT MAP 114 A 209



CITY OF LOS ANGELES
DEPT. OF PUBLIC WORKS

VITALY B. TROYAN
CITY ENGINEER



① N-S LEG OF THE L-SHAPED ALLEY
BEING VACATED LOOKING SLY FROM
42 ND ST.



② SLY SIDE OF 42 ND ST. LOOKING
WLY FROM THE ALLEY.



③ SLY SIDE OF 42ND ST. LOOKING
ELY FROM THE ALLEY.



④ 20-FOOT UNIMPROVED ^{ALLEY} LOCATED AT
THE ELY HALF OF LOT 20, JOHN
TAYLOR TRACT, LOOKING SLY FROM
42ND ST.



⑤ ELY END OF E-W LEG OF THE L-SHAPED ALLEY BEING VACATED LOOKING WLY FROM ^{THE} 20-FOOT UNIMPROVED ALLEY.



⑥ WLY END OF THE 12-FOOT ALLEY LOOKING ELY FROM THE 20-FOOT UNIMPROVED ALLEY.



⑦ SLY END OF THE 20-FOOT UNIMPROVED ALLEY LOCATED AT THE ELY HALF OF LOT 20, JOHN TAYLOR TRACT.



⑧ SLY SIDE OF 42ND ST. LOOKING ELY FROM MCKINEY AVE.



(9) ELY SIDE OF MCKINNEY AVE
LOOKING SLY FROM 42ND ST.



(10) NLY SIDE OF 42ND PLACE
LOOKING ELY FROM MCKINNEY AVE

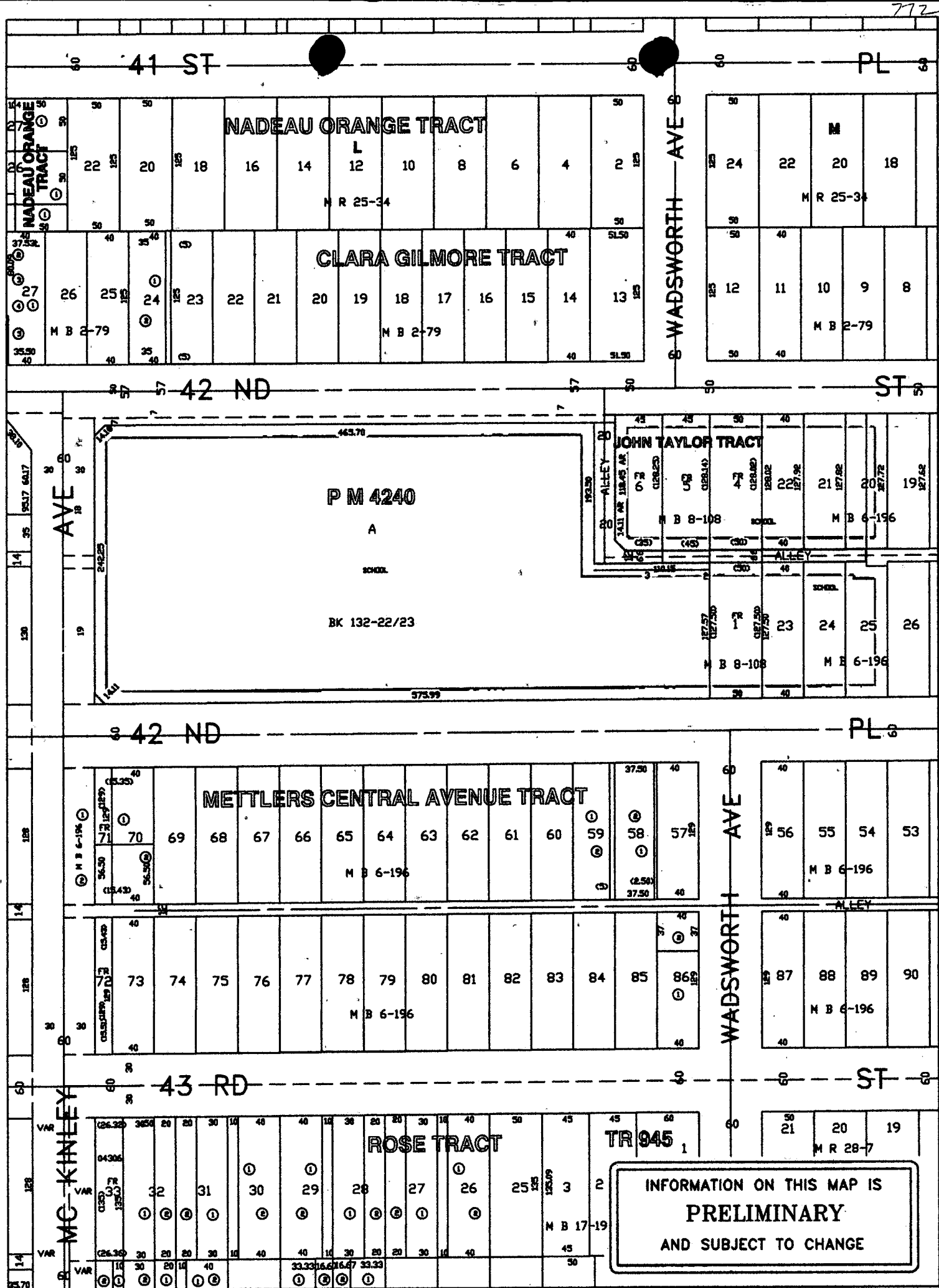

TITLE: L-SHAPED ALLEY (PORTION OF) EASTERLY OF MC KINLEY AVENUE
AND SOUTHERLY OF 42ND STREET.

WORK OEDER NO. VAC- E1400772
COUNCIL FILE NO. _____
COUNCIL DIST. 9 DIV. INDEX 164
ENG. DIST. CENTRAL T.G. 674-E3
DISTRICT MAP 114 A 209

CITY OF LOS ANGELES
DEPT. OF PUBLIC WORKS
DATE 9-20-01
C.S.D. No Done
C.S.D. INVOLVED
ACTION REQUIRED
VITAB. B. TROYAN
CITY ENGINEER

EXHIBIT A

CITY OF LOS ANGELES
INTER-DEPARTMENTAL CORRESPONDENCE

DATE: September 6, 2001

REF: PSB-756-01

TO: Edmond Yew, Manager
Land Development Group
Department of Public Works, Bureau of Engineering

FROM: Dennis E. Frady, Assistant General Manager
Public Safety Bureau
Information Technology Agency

Dennis E. Frady

SUBJECT: **L-SHAPED ALLEY (PORTION OF) EASTERLY OF MCKINLEY AVENUE
AND SOUTHERLY OF 42ND STREET - VAC-E1400772;
ITA W.O. 620916G.**

The Information Technology Agency (ITA) has no facilities within the proposed vacation area.

If there are any questions regarding this matter please contact Tom Quon, Communications Engineering Associate at (213) 847-2381.

DEF:TA:tq

Attachment

RECEIVED
DEVELOPMENT SERVICES DIV.
LAND DEVELOPMENT SECTION
01 SEP 12 AM 9:27

Kc

ITA/PSB/CSD/VOICE RADIO & TRANSMISSION ENGINEERING SECTION
SIGNATURE TRACKING FORM

DATE: 9/4/01

TO: Dennis E. Frady, Assistant General Manager
Public Safety Bureau
Information Technology Agency

Tun Aung

FROM: Tun Aung, Director of Communications Services
Communications Services Division
Public Safety Bureau
Information Technology Agency

SUBJECT: REVIEW, APPROVAL AND SIGNATURE

L-SHAPED ALLEY (PORTION OF)
The attached document ELY/O MCINLEY AV & SLY/O 42ND ST.

W.O. # 6209166

VAC-E1400772

needs your signature in 1 place(s).

Please return signed document to Communications Services Division at Mail Stop 999,
250 East First Street, Room 1400, for transmittal and record keeping.

This document needs to be transmitted ASAP.

Please have Bruce Smith's group (Network Planning)
review it for fiber facilities.

OK, Michael Kueh

For CSD Use Only

Transmittal #:

610

Date Returned:

CITY OF LOS ANGELES
INTER-DEPARTMENTAL CORRESPONDENCE

Date:

AUG 28 2001

To: Public Safety Telecommunication
Attn: Tun Aung, Manager
250 E. First Street, Room 1400
Los Angeles, CA 90012
Mail Stop 999

From: *Edmond Yew*
Edmond Yew, Manager
Land Development Group
Bureau of Engineering
Stop 901

Subject: L-shaped Alley (Portion of) Easterly of McKinley Avenue
and Southerly of 42nd Street - VAC-E1400772.

This office is investigating the following:

- (x) A request for the vacation of the area(s) shown colored blue on the attached map.
- () The vacation of the area(s) shown colored green.

Please advise this office of any recommendations or objections or your Department concerning the proposed vacation. **You must notify this office in writing within 50 days of the date of this letter at the address shown below.** If we do not receive your written response within the allotted time, our report will state that your office has failed to respond within the 50 day time limit.

Further information concerning the vacation may be obtained from Gus Dembegiotes of the Street Vacation Investigation Section on telephone (213) 485-5368 or in 634 S. Spring Street, Suite 400, Los Angeles, CA 90014, Stop number 901.

EY/FV/gt

Enc.

APPLICATION FOR VACATION OF PUBLIC RIGHT OF WAY
ORIGINAL - (No copies or faxes)

DATE: July 11, 2001

PROJECT LOCATION AND DESCRIPTION:

- (1) Area proposed to be vacated is: Alley Easterly of McKinley Avenue
(Street/Avenue/Boulevard/alley/walk: N/S/E/W of)
and is located between:
42nd Street and 42nd Place
(Street, Avenue, Boulevard or other limit) (Street, Avenue, Boulevard or other limit)
- (2) The vacation area lies within or is shown on:
- (a) Engineering District: (check appropriately)
(x) Central () Harbor () Valley () West Los Angeles
- (b) Council District No. 9
- (c) District Map. No. 114-B-209
- (d) Thomas Guide Reference: 674, E-3
(Page No.) (Letter/Number at intersection pt.)
- (3) Area (in sq. ft.) of the proposed vacation area is approx. 5,621 sq. ft.
- (4) Purpose of vacation (future use of vacation area) is: Consolidation of
properties for an elementary school site.
- (5) Vacation is in conjunction with: (Check appropriately)
(x) Revocable Permit () Tract Map () Parcel Map () Zone Change
() Other: See 4

PETITIONER / APPLICANT:

- (6) Petitioner(s): Los Angeles Unified School District
Print Name(s) of Petitioner(s) in full - Name or Company Name
- Signature(s): Scot Graham, Director of Real Estate
- (7) Mailing Address: 355 S. Grand Avenue, Suite 500, Los Angeles, CA 90071
- (8) Daytime phone number of petitioner is: (213) 633-7535
FAX number: (213) 633-7546
E-mail Address: _____
- (9) Petitioner is: (check appropriately) () Owner OR (x) Representative of Owner

OWNERSHIPS:

- (10) Name(s) and address of the Owner(s) applying for vacation is/are:
Same as above
- _____

- Print Name(s) and Address of Owner(s) in Full Signature(s)
(If Owner is Petitioner, Indicate "Same as above")

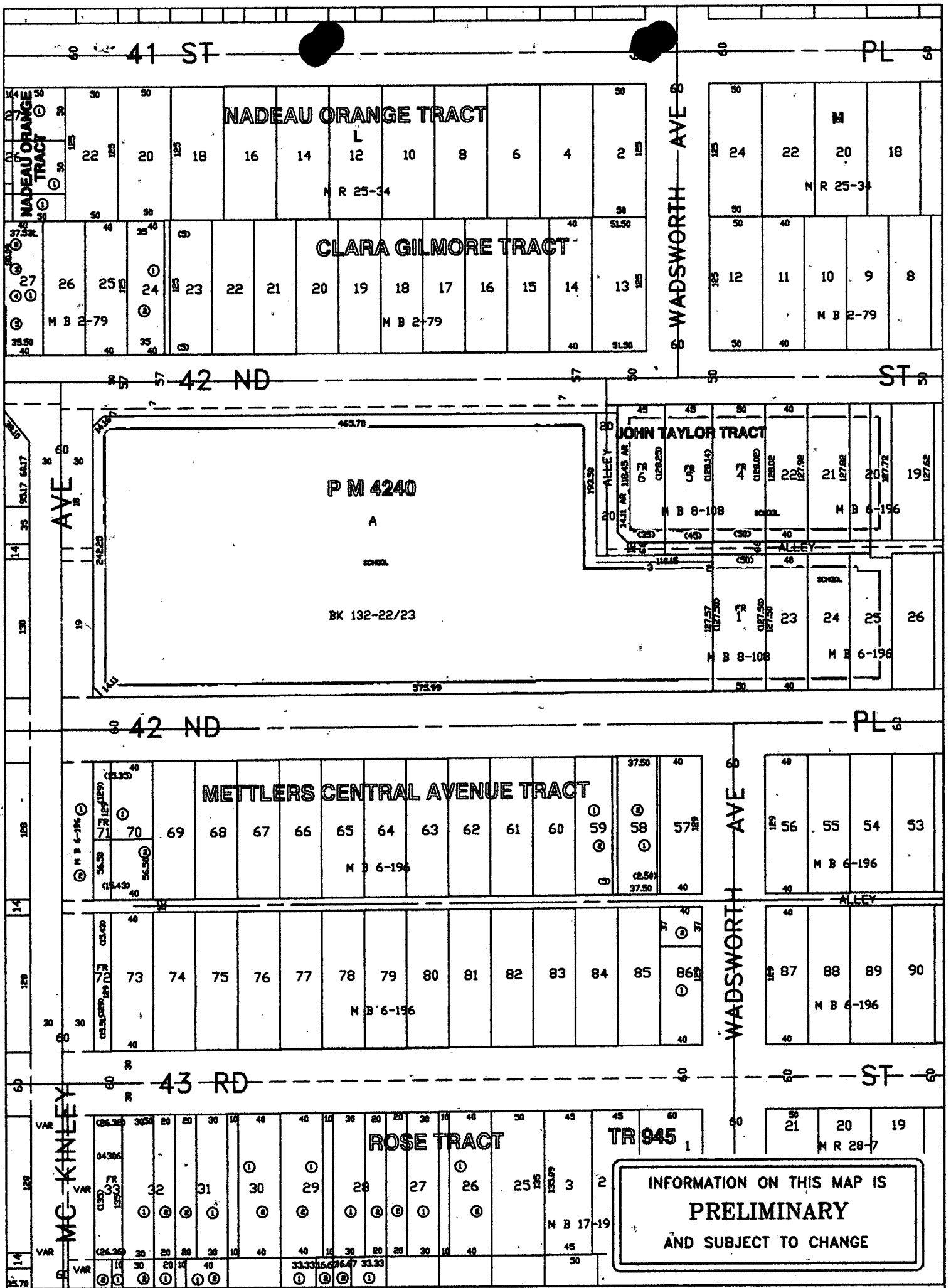

TITLE: L-SHAPED ALLEY (PORTION OF) EASTERLY OF MC KINLEY AVENUE
AND SOUTHERLY OF 42ND STREET.

WORK OEDER NO. VAC- E1400772
COUNCIL FILE NO. _____
COUNCIL DIST. 9 DIV. INDEX 164
ENG. DIST. CENTRAL T.G. 674-E3
DISTRICT MAP 114 A 209



CITY OF LOS ANGELES
DEPT. OF PUBLIC WORKS
VITALY B. TROYAN
CITY ENGINEER

BOARD OF PUBLIC WORKS
MEMBERSELLEN STEIN
PRESIDENTVALERIE LYNNE SHAW
VICE-PRESIDENTMARIBEL MARIN
PRESIDENT PRO-TEMSTEVEN CARMONA
WOODY FLEMINGJAMES A. GIBSON
SECRETARYCITY OF LOS ANGELES
CALIFORNIAJAMES K. HAHN
MAYORDEPARTMENT OF
PUBLIC WORKSBUREAU OF
ENGINEERINGVITALY B. TROYAN, P.E.
CITY ENGINEER650 SOUTH SPRING ST., SUITE 200
LOS ANGELES, CA 90014-1911Outdoor Systems
Attn: Sandra Williams
2514 N. Naomi
Burbank, CA 91504L-shaped Alley (Por/o) Ely/o
McKinley Ave. & Sly/o 42nd St. -
VAC-E1400772.

AUG 28 2001

NOTICE OF PROPOSED VACATION

This office is investigating the following:

- (x) A request for the vacation of the area(s) shown colored blue on the attached map.
- () The vacation of the area(s) shown colored brown.

You must notify this office in writing within 45 days of the above date at the address shown below if there are in-place public utility facilities in the vacation area that are in use and require protection. If we do not receive your written response within 45 days of the above date, we will assume you do not object to the vacation of the requested area as shown on the attached map and you do not maintain any facilities within this area.

Further information concerning the vacation may be obtained from Gus Dembegiotes of the Street Vacation Investigation Section on telephone (213) 485-5368 or in 634 S. Spring Street, Suite 400, Los Angeles, CA 90014, Stop number 901.

Edmond Yew
Edmond Yew, Manager
Land Development Group
Bureau of Engineering

EY/FV/gt

Enc.

NO - CONFLICT
NO BUS SHELTER

OUTDOOR 818-846-1300

BY *Tam Harmon* DATE *9/4/01*

USA / JOB#

J. MICHAEL CAREY
City Clerk

FRANK T. MARTINEZ
Executive Officer

When making inquiries
relative to this matter
refer to File No.

CITY OF LOS ANGELES

CALIFORNIA



JAMES K. HAHN
MAYOR

Office of the
CITY CLERK
Council and Public Services
Room 395, City Hall
Los Angeles, CA 90012
Council File Information - (213) 978-1043
General Information - (213) 978-1133
Fax: (213) 978-1040

HELEN GINSBURG
Chief, Council and Public Services Division

01-1833
CD 9

August 30, 2001

CITY ENGINEER
PUBLIC WORKS COMMITTEE

Let's all please

In accordance with Council Rules, communication from the Bureau of Engineering relative to request for initiation of Vacation Proceedings: L-shaped alley (portion of) easterly of McKinley Avenue and southerly of 42nd Street, was referred on August 30, 2001, to the CITY ENGINEER and PUBLIC WORKS COMMITTEE.

J. Michael Carey

City Clerk
amm

INTER-DEPARTMENT CORRESPONDENCE

Date: 7-31-2001

To: City Clerk's Office
Attention: Council Index
Room 395, City HallFrom: Edmond Yew, Manager
Land Development Group
Bureau of EngineeringSubject: Assignment of Council File NumberBY _____
CITY CLERK
DEPUTY

2001 AUG 28 PM 1:18

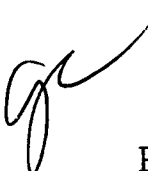
RECEIVED
CITY CLERK'S OFFICEPlease assign a Council File Number to this request for
initiation of Vacation Proceedings:L-SHAPED ALLEY (PORTION OF) EASTERLY OF MCKINLEY AVENUE
AND SOUTHERLY OF 42ND STREET.

_____C.D. No. 9 ✓Referred to City Engineer
and Public Works Cmte.RO/DS
A:Council.file

AUG 30 2001

APPLICATION FOR VACATION OF PUBLIC RIGHT OF WAY
ORIGINAL – (No copies or faxes)

DATE: July 11, 2001

PROJECT LOCATION AND DESCRIPTION:

- (1) Area proposed to be vacated is: Alley Easterly of McKinley Avenue
(Street/Avenue/Boulevard/alley/walk: N/S/E/W of)
and is located between:
42nd Street and 42nd Place
(Street, Avenue, Boulevard or other limit) (Street, Avenue, Boulevard or other limit)
- (2) The vacation area lies within or is shown on:
- (a) Engineering District: (check appropriately)
(x) Central () Harbor () Valley () West Los Angeles
- (b) Council District No. 9
- (c) District Map. No. 114-B-209
- (d) Thomas Guide Reference: 674, E-3
(Page No.) (Letter/Number at intersection pt.)
- (3) Area (in sq. ft.) of the proposed vacation area is approx. 5,621 sq. ft.
- (4) Purpose of vacation (future use of vacation area) is: Consolidation of
properties for an elementary school site.

- (5) Vacation is in conjunction with: (Check appropriately)
(x) **Revocable Permit** () Tract Map () Parcel Map () Zone Change
() Other: See 4

PETITIONER / APPLICANT:

- (6) Petitioner(s): Los Angeles Unified School District
Print Name(s) of Petitioner(s) in full – Name or Company Name
Signature(s): Scot Graham, Director of Real Estate
- (7) Mailing Address: 355 S. Grand Avenue, Suite 500, Los Angeles, CA 90071
- (8) Daytime phone number of petitioner is: (213) 633-7535
FAX number: (213) 633-7546
E-mail Address: _____
- (9) Petitioner is: (check appropriately) () Owner **OR** (x) Representative of Owner

OWNERSHIPS:

- (10) Name(s) and address of the **Owner(s)** applying for vacation is/are:
Same as above

- Print Name(s) and Address of Owner(s) in Full
(If Owner is Petitioner, Indicate "Same as above")
- Signature(s)



VICINITY MAP

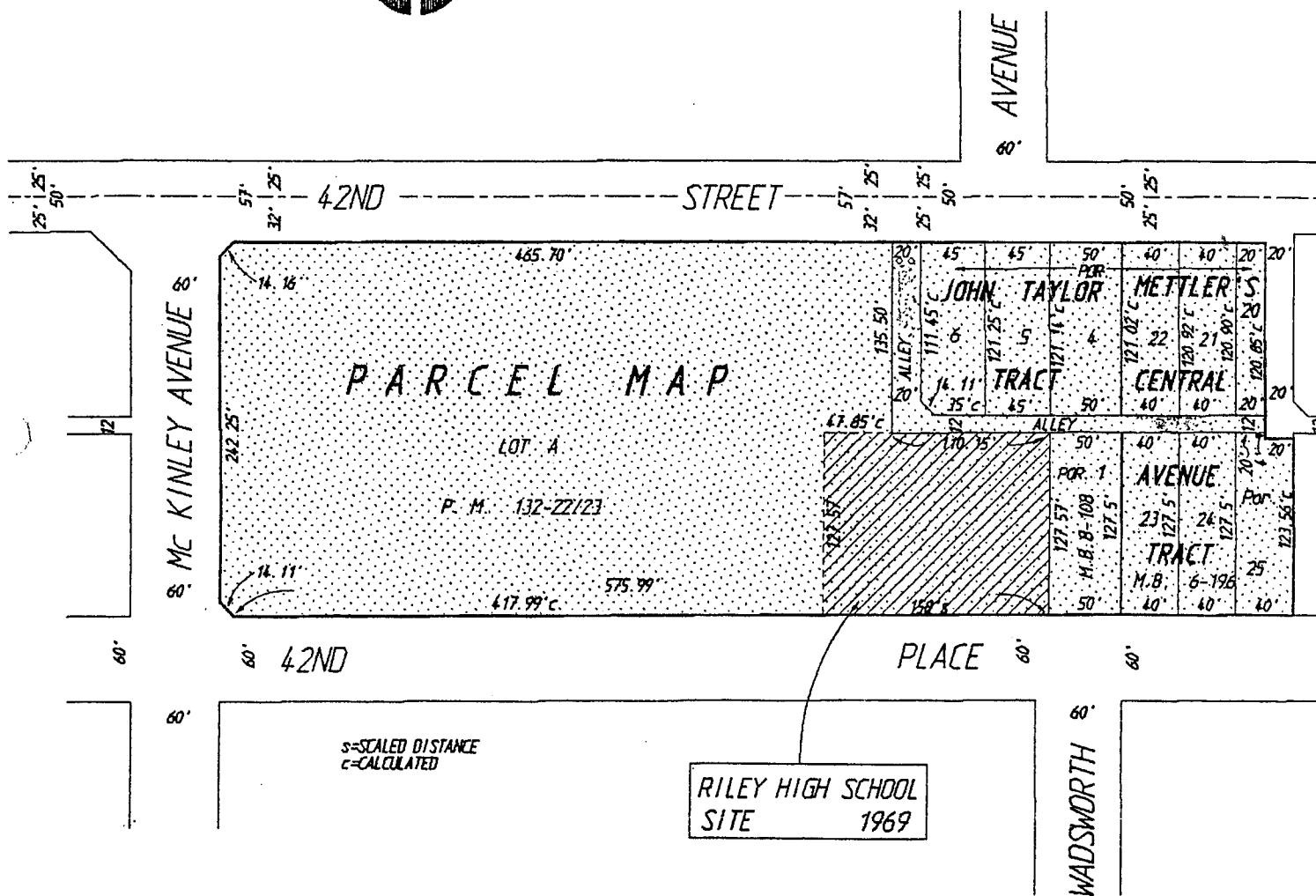
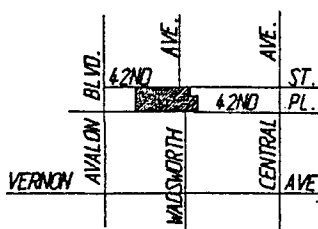

JEFFERSON-	174,538 SQ.FT.	=	4.01 Ac
RILEY HI-	20,156 SQ.FT.	=	0.46 Ac
PROPERTY=	194,694 SQ.FT.		4.47 Ac

REDRAWN 2-13-90 HNTB; REV. 9-29-94 MT
CHECKED 10-17-80 m.s.
CITY OF LOS ANGELES
C.A.M.B. 5115
D.M. 114-209
C.W.S. 7
ZONE R3-1

RECEIVED
DEVELOPMENT SERVICES DIV.
LAND DEVELOPMENT SECTION

01 JUL 17 AM 10:25