

CITY OF LOS ANGELES

CALIFORNIA



JUNE LAGMAY
City Clerk

HOLLY L. WOLCOTT
Executive Officer

Office of the
CITY CLERK

Council and Public Services
Room 395, City Hall
Los Angeles, CA 90012
General Information - (213) 978-1133
Fax: (213) 978-1040

www.cityclerk.lacity.org

ANTONIO R. VILLARAIGOSA
MAYOR

April 7, 2011

To All Interested Parties:

The City Council adopted the action(s), as attached, under Council file
No. 08-2488, at its meeting held April 6, 2011.

City Clerk
KW

ACCELERATED REVIEW PROCESS – G

Office of the City Engineer

Los Angeles, California

To the Honorable Council

Of the City of Los Angeles

Honorable Members:

MAR 11 2011

C. D. No. 9

SUBJECT:

Broadway Place between Olympic Boulevard and Main Street – Resolution to Vacate – VAC-E1400827 – Council File No. 08-2488

RECOMMENDATIONS:

- A. That the City Council reaffirm its findings of December 10, 2008, that this vacation is in substantial conformance with the General Plan pursuant to Section 556 of the City Charter.
- B. That the Resolution to Vacate No. 11-1400827 for this vacation be adopted.
- C. That following Council adoption, Resolution to Vacate No. 11-1400827, be transmitted to the Land Development Group of the Bureau of Engineering for recordation of the Resolution with the County Recorder.

TRANSMITTALS:

- 1. Council action of December 10, 2008.
- 2. Draft of Resolution to Vacate No. 11-1400827.

DISCUSSION:

Resolution to Vacate: At the meeting of the City Council on January 14, 2009, no protests were filed against this vacation. All conditions of the Council's action of December 10, 2008, under Council File No. 08-2488 have been fulfilled. The Resolution to Vacate is being presented pursuant to Council instructions of December 10, 2008.

Resolution to Vacate No. 11-1400827 has been approved as to form and legality by the City Attorney.

Environmental Considerations: The City Council, on December 10, 2008, found that this project is exempt from the California Environmental Quality Act of 1970 pursuant to the categorical exemptions included in the City's Environmental Guidelines under Article VII, Class 5(3).

Los Angeles City Charter: The Council's action of December 10, 2008 complies with the requirements of Section 556 of the City Charter.

Respectfully submitted,



Edmond Yew, Manager
Land Development Group
Bureau of Engineering

EY/DW/pm
E1400827resrpt

ADOPTED

APR 06 2011

LOS ANGELES CITY COUNCIL

RESOLUTION TO VACATE NO. 11-1400827
(California Streets and Highways
Code Sections 8324, 8325 and 8340)

Vacation of Broadway Place between Olympic Boulevard and Main Street.

The City Council considered the evidence submitted regarding said vacation and determined that said street should be vacated subject to the reservations and exemptions as contemplated and subject to the conditions of vacation having been complied with.

Therefore, from all of the evidence submitted, the Council finds that Broadway Place between Olympic Boulevard and Main Street proposed for vacation is unnecessary for present or prospective public street purposes; and

The particular portion of the public street which is to be vacated and said permanent easement and right for public sanitary sewer facilities to be reserved over the entire vacation area are described herein attached Exhibit "A".

RESERVING AND EXCEPTING THEREFROM, an easement for sanitary sewer purposes for the use of the City of Los Angeles, over that portion of Broadway Place described hereinabove.

The City Clerk shall certify this Resolution and affix the City seal, and shall transmit a sealed copy of this Resolution to the Land Development Group of the Bureau of Engineering for recordation in the office of the County Recorder of Los Angeles County.

IT IS THEREFORE RESOLVED that from and after the recordation of this Resolution, the area described hereinabove is vacated, subject to the reservations and exceptions of said permanent easements.

I certify that the foregoing Resolution was adopted by the Council of the City of Los Angeles at its meeting of **APR 06 2011** by a majority vote of all its members.

Approved as to form and legality
Carmen A. Trutanich, City Attorney

By *[Signature]* 3/7/11
Deputy Date

JUNE LAGMAY, City Clerk

By *[Signature]*
Deputy

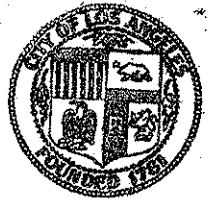

Council File No. 08-2488
R/W No. 33574

EXHIBIT "A"

LEGAL DESCRIPTION

BROADWAY PLACE STREET VACATION

Those portions of Lots 1, 2, 3, 4, and 18 of the E. H. Workman Tract, in the City of Los Angeles, County of Los Angeles, State of California, as per map recorded in Book 5 Page 36 of Miscellaneous Records, and that portion of Lot 29 of the Addition to the E.H. Workman Tract, in said City, as per map recorded in Book 7, Page 2 of said Miscellaneous Records, all being in the Office of the County Recorder of said County, described as follows:

Beginning at the most southerly corner of Lot B of Tract No. 4989, in said City, as per map recorded in Book 53 Page 37 of Maps, Records of said County; thence North 12 degrees 44 minutes 34 seconds East 317.21 feet along the easterly lines of Lots A and B of said Tract No. 4989 to a line parallel with and 45.00 feet southeasterly of the center line of Broadway, 88 feet wide, as shown on said Tract No. 4989; thence North 45 degrees 13 minutes 50 seconds East 77.03 feet along said parallel line to a point distant 15.00 feet southwesterly from the intersection of a line parallel with and 2.00 feet southwesterly of the southwesterly line of that certain strip of land 50 feet wide as described in Final Decree of Condemnation entered in Case No. 956820 of the Superior Court of the State of California, in and for the County of Los Angeles, a copy of said Final Decree is recorded in Book D-4938 Page 494 of Official Records, Records of said County; thence in a direct line North 86 degrees 37 minutes 04 seconds East 22.51 feet to a point on said parallel line 2.00 feet southwesterly of the southwesterly line of said certain strip, distant thereon southeasterly 15.00 feet from its intersection with said parallel line 45.00 feet southeasterly of said center line of Broadway; thence along said parallel line 2.00 feet southwesterly of the southwesterly line of said certain strip, South 51 degrees 59 minutes 42 seconds East 31.59 feet to the southerly line of that certain 15 foot by 15 foot cut corner described as Parcel 1A in said document recorded in Book D-

Sheet 1 of 2

1 4938 Page 494 of Official Records; thence South 70 degrees 22 minutes 26 seconds West
 2 13.69 feet along said southerly line to the easterly line of Broadway Place, 80 feet wide,
 3 as shown on said Tract No. 4989; thence along said easterly line of said Broadway Place,
 4 South 12 degrees 44 minutes 34 seconds West 184.65 feet to an angle point in said
 5 easterly line of Broadway Place; thence along the northwesterly prolongation of the
 6 northeasterly line of said Broadway Place, North 55 degrees 56 minutes 14 seconds West
 7 4.75 feet to a line parallel with and 52.00 feet northwesterly of the center line of Main
 8 Street, 100 feet wide, as shown on said Tract No. 4989; thence along said parallel line,
 9 South 33 degrees 59 minutes 59 seconds West 199.78 feet to the southeasterly
 10 prolongation of the southwesterly line of said Lot B; thence along said prolongation,
 11 North 51 degrees 59 minutes 53 seconds West 3.48 feet to the most southerly corner of
 12 said Lot B and the point of beginning.

13
 14 Reserving therefrom an easement for existing sanitary sewer and public utilities.

15
 16
 17 This legal description are delineated on accompanying "Exhibit ___" and is made a part
 18 hereof for reference purposes.

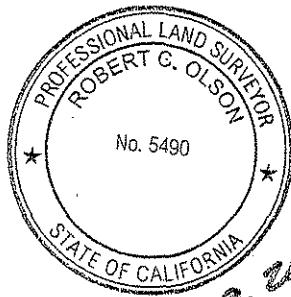

10.08.2010

Prepared under the direction of

Robert C. Olson

Robert C. Olson, PLS 5490

PSOMAS

EXHIBIT

"BROADWAY PLACE STREET VACATION LEGAL DESCRIPTION"
 CITY OF LOS ANGELES
 COUNTY OF LOS ANGELES, STATE OF CALIFORNIA
 SUPPLEMENTAL EXHIBIT TO LEGAL DESCRIPTION - JOB NO: 1LRA010100

