

03 LAUNCH PLAZA w/ PAVILION

NORTH-EAST AERIAL VIEW

Phase
1A
2016/17

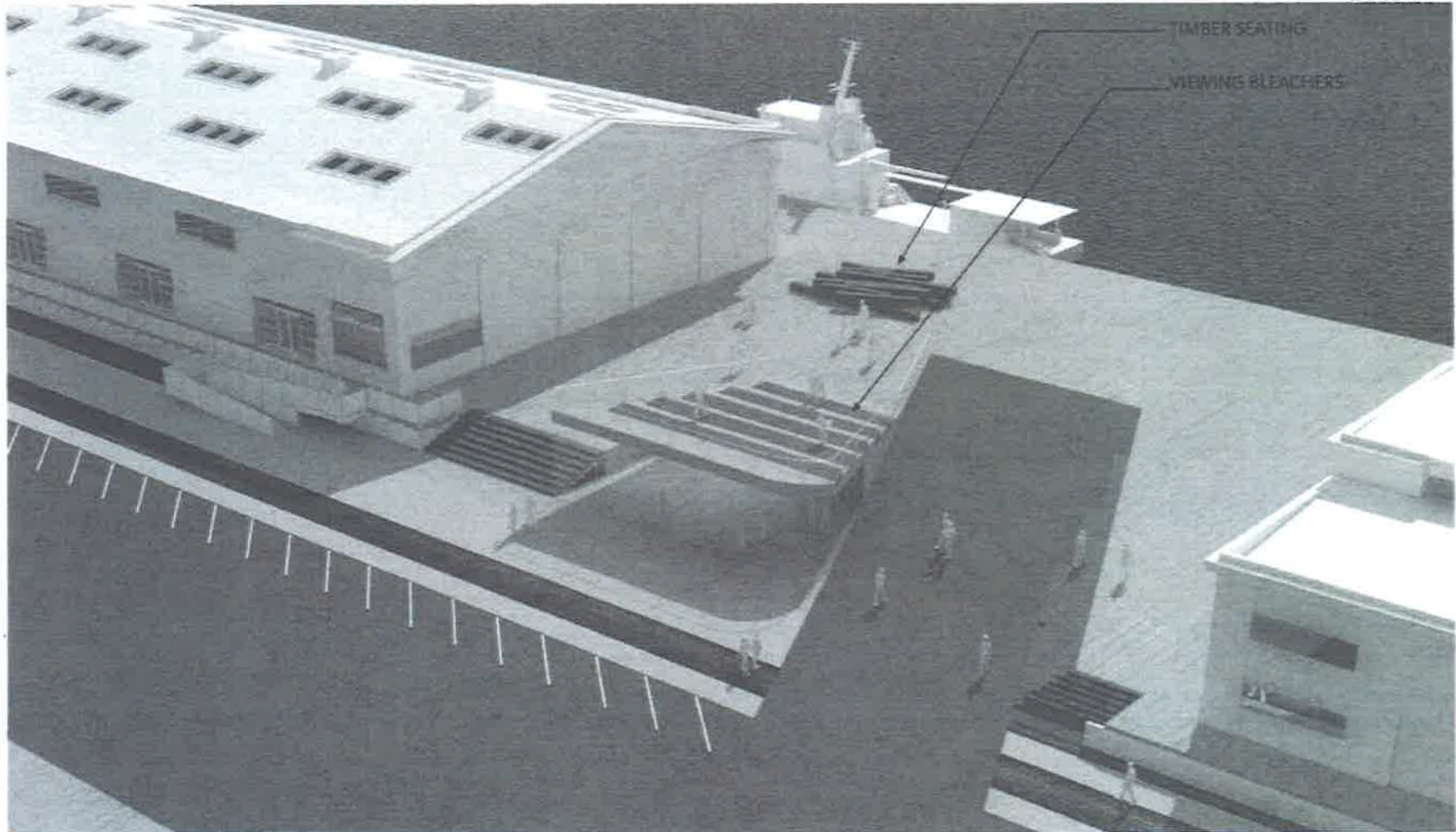

DISCLAIMER: Recommended phasing proposal is subject to successful lease amendment execution, fundraising, adoption of supplemental EIR and associated permitting and final AltaSea Board and Port of Los Angeles approvals

ARCHITECTURE + GENSBLER
+ Gensler

03 LAUNCH PLAZA W/ PAVILION

PAVILION ALONG LINEAR PARK CAN HOST COFFEE BAR, INFORMATION ON ALTASEA AND THE SURROUNDING BUSINESS AND EDUCATION PROGRAMS

Phase
1A
2016/17

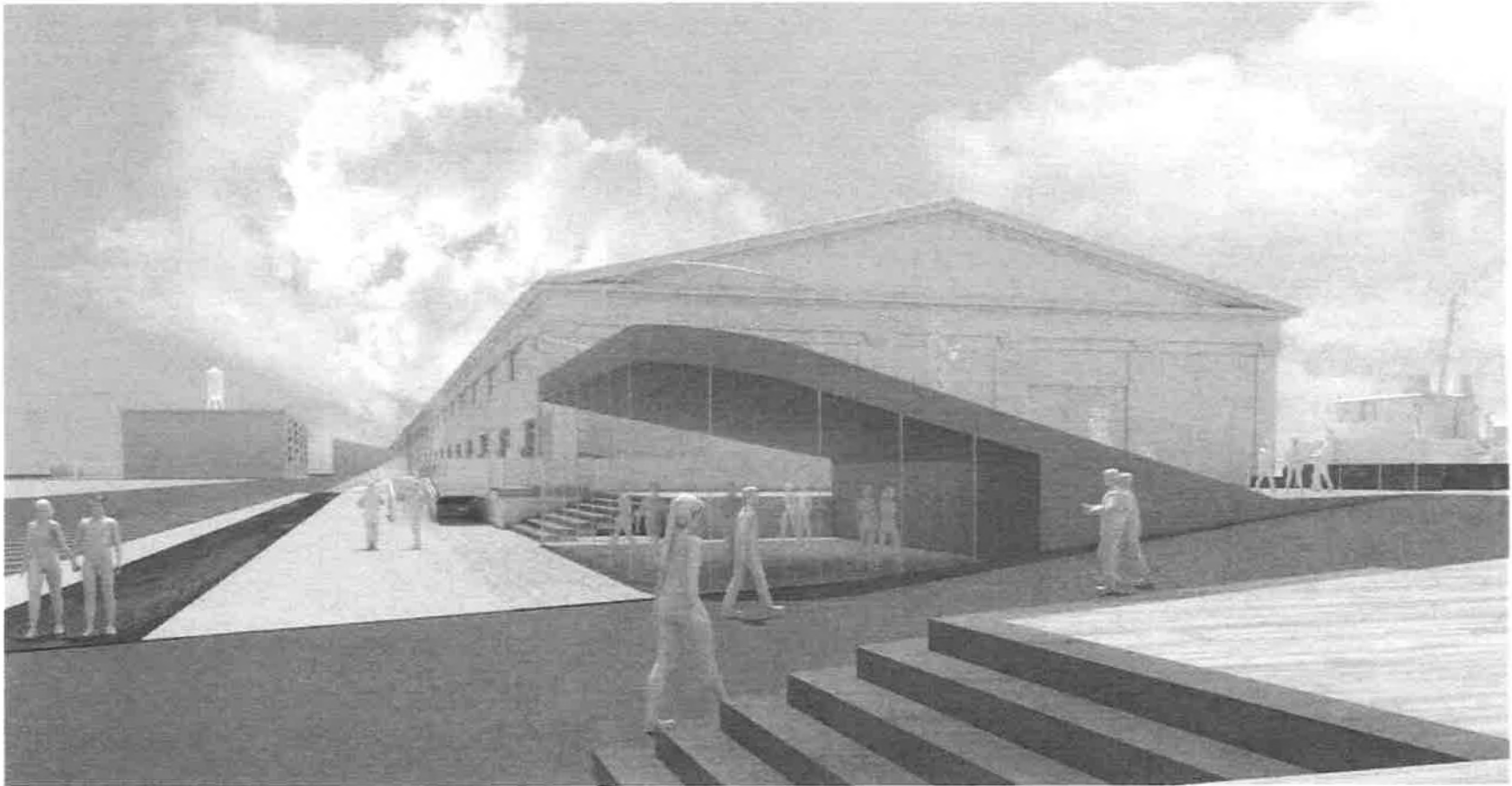

DISCLAIMER: Recommended phasing proposal is subject to successful lease amendment execution, fundraising, adoption of supplemental EIR and associated permitting and that Alameda Board and Port of Los Angeles approvals

02 WHARF RETRO-FIT

STRUCTURAL UPGRADE AT LAUNCH PLAZA BERTH 57.5

PHASE 1A

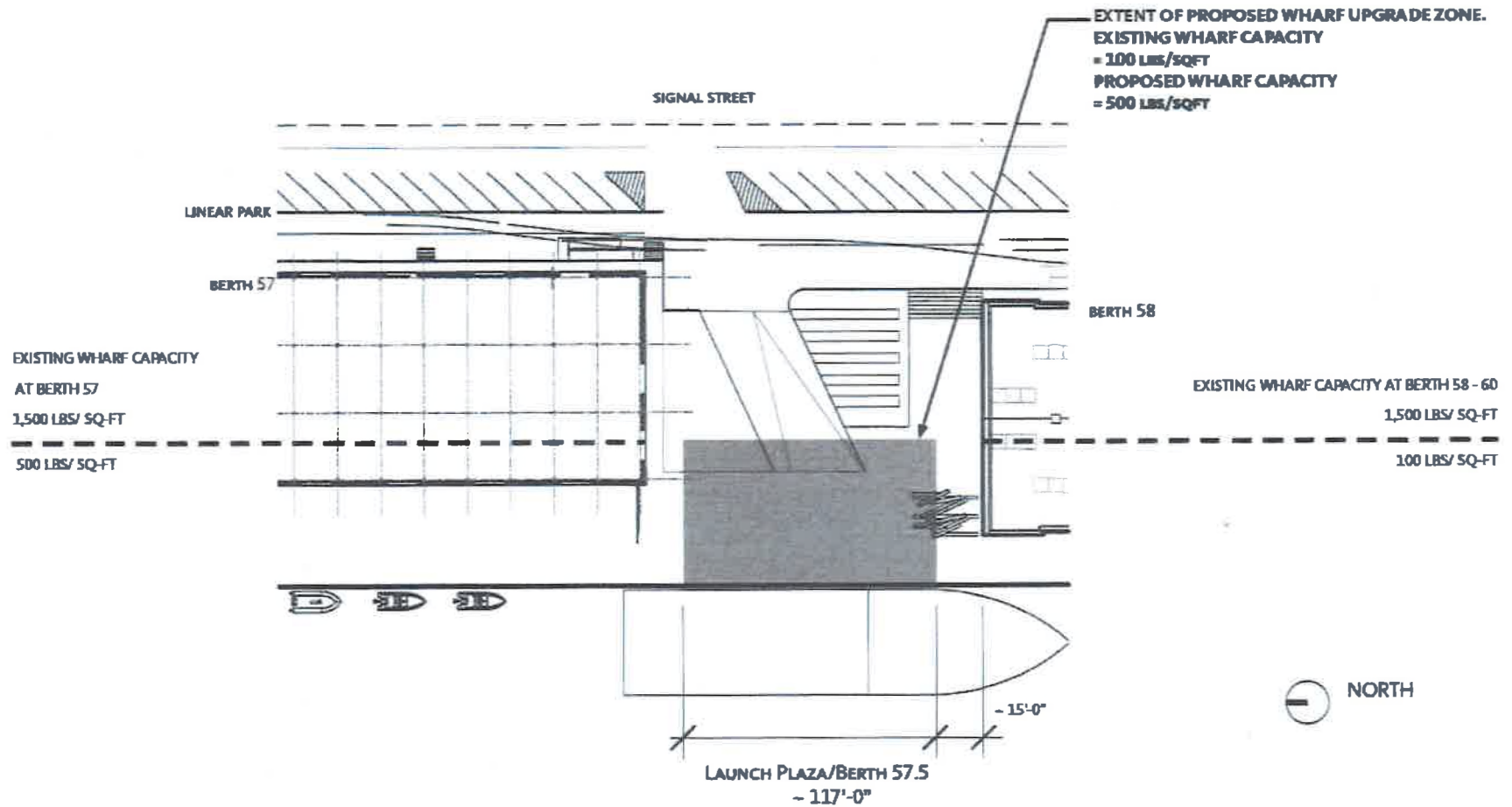

REVISED 01/23/16 - GENSLER

02 WHARF PLAZA RETRO-FIT: VESSEL FENDERING

WATERWAY

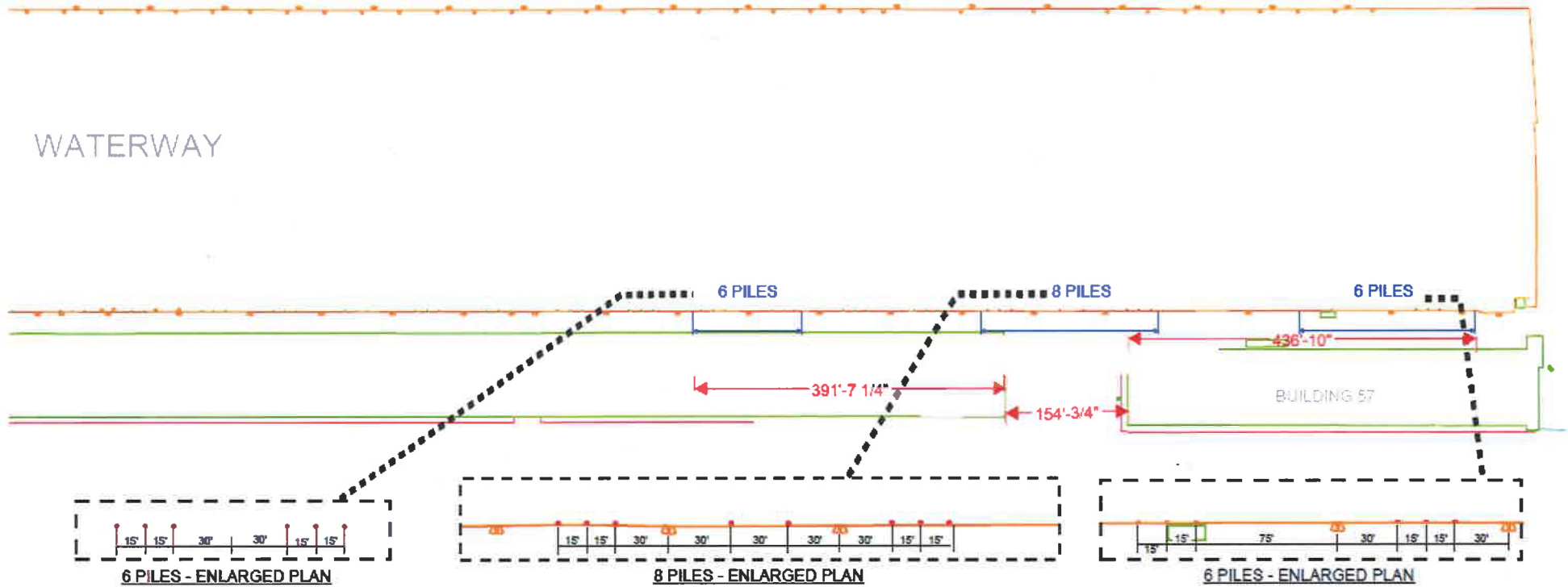

NOTES:

- 1) TOTAL PILES REQUIRED: 20
- 2) MAXIMUM LOAD PER PILE DELIVERED TO WHARF DECK: 11.51 KIPS
- 3) DESIGN WIND SPEED: 60 MPH 3-SEC GUST (52.4 MPH 30-SEC GUST)
- 4) DIMENSIONS FOR TIMBER PILES GIVEN ARE APPROXIMATE. PILE LOCATIONS TO BE FIELD COORDINATED.
- 5) PILES SHALL BE COATED WITH CREOSOTE PRIOR TO INSTALLATION
- 6) PILES SHALL BE WRAPPED IN PLASTIC AFTER INSTALLATION.

FENDER PILE REQUIREMENTS:

- MIN. PILE BUTT DIAMETER - 13 INCHES
- MIN. PILE TIP DIAMETER - 8 INCHES
- MIN. PILE LENGTH - 62 FEET
- SPECIES - PACIFIC COAST DOUGLAS FIR



400 OCEANGATE, SUITE 500
 LONG BEACH, CA 90802
 (562) 437-9100