

ORDINANCE NO. 184706

An ordinance amending Section 12.04 of the Los Angeles Municipal Code by amending the Zoning map.

THE PEOPLE OF THE CITY OF LOS ANGELES DO ORDAIN AS FOLLOWS:

Section 1. Section 12.04 of the Los Angeles Municipal Code is hereby amended by changing the zones and zone boundaries shown upon a portion of the zone map attached thereto and made a part of Article 2, Chapter 1 of the Los Angeles Municipal Code, so that such portion of the Zoning map shall be as follows:

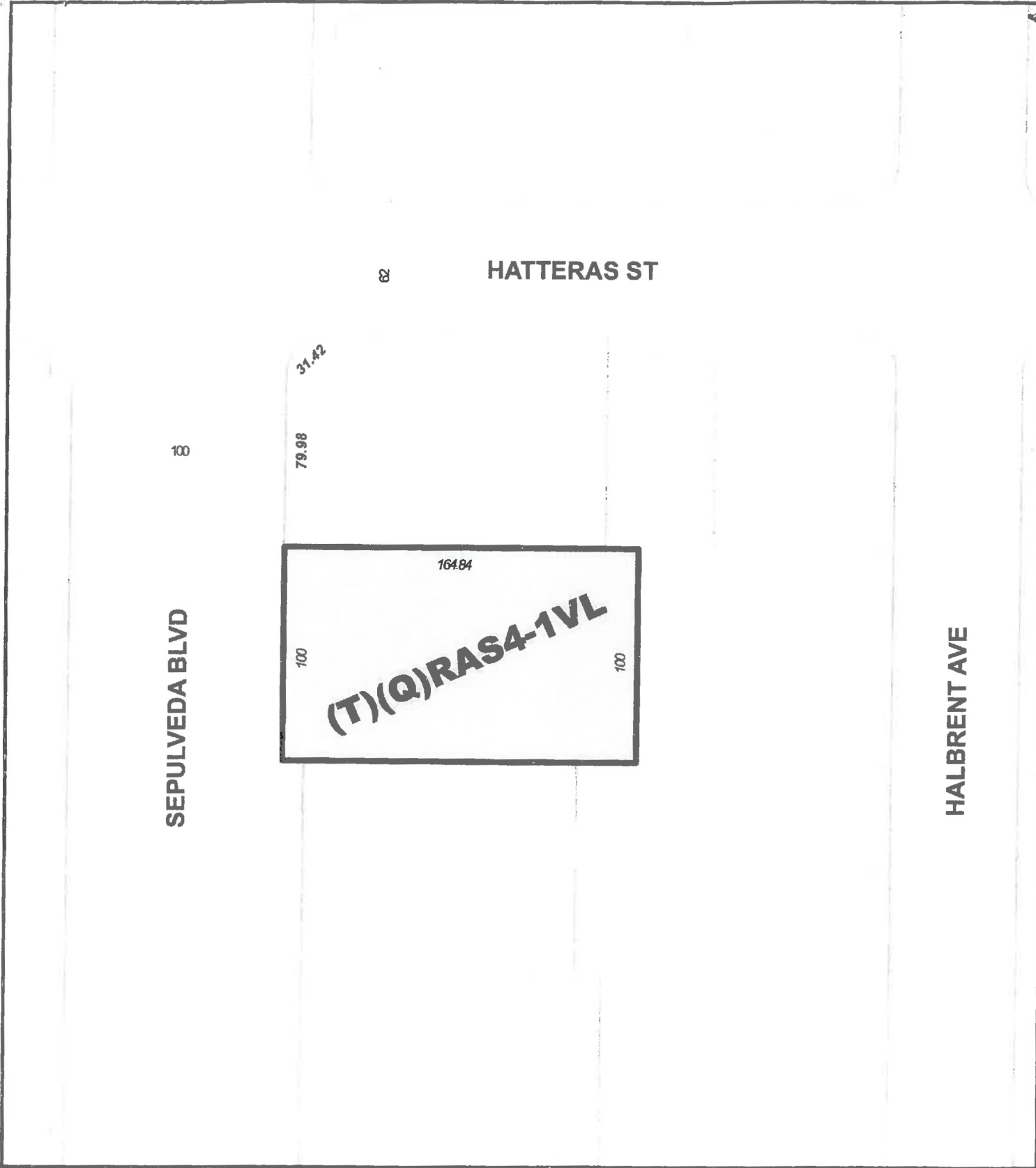

40 20 0 40 Feet

CM: 174 B 145	CPC 2013-3554 ZC HD CU ZV ZAA
---------------	-------------------------------

LH/ *[Signature]*

080614



Area Mapped

Sec. _____. The City Clerk shall certify to the passage of this ordinance and have it published in accordance with Council policy, either in a daily newspaper circulated in the City of Los Angeles or by posting for ten days in three public places in the City of Los Angeles: one copy on the bulletin board located at the Main Street entrance to the Los Angeles City Hall; one copy on the bulletin board located at the Main Street entrance to the Los Angeles City Hall East; and one copy on the bulletin board at the Temple Street entrance to the Los Angeles County Hall of Records.

I hereby certify that this ordinance was passed by the Council of the City of Los Angeles, at its meeting of JAN 10 2017.

HOLLY L WOLCOTT, City Clerk

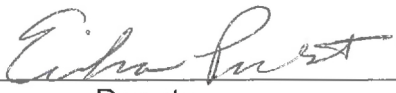
By 
Deputy

Approved 1/12/17

Mayor

Pursuant to Sec. 559 of the City Charter,
I approve this ordinance on behalf of the
City Planning Commission and
recommend that it be adopted....

June 10, 2016
See attached report

Vincent P. Bertoni
Director of Planning

File No. CF-14-0450-S1
CPC-2013-3554-ZC-HD-CU-ZV-ZAA

DECLARATION OF POSTING ORDINANCE

I, JUAN VERANO, state as follows: I am, and was at all times hereinafter mentioned, a resident of the State of California, over the age of eighteen years, and a Deputy City Clerk of the City of Los Angeles, California.

Ordinance No.184706 – Correction to Ordinance No. 183335 for properties located at 5746-5750 Sepulveda Boulevard and 5747-5751 Halbreth Avenue – CPC-2013-3554-ZC-HD-CU-ZV-ZAA – a copy of which is hereto attached, was finally adopted by the Los Angeles City Council on **January 10, 2017**, and under the direction of said City Council and the City Clerk, pursuant to Section 251 of the Charter of the City of Los Angeles and Ordinance No. 172959, on **January 18, 2017** I posted a true copy of said ordinance at each of the three public places located in the City of Los Angeles, California, as follows: 1) one copy on the bulletin board located at the Main Street entrance to the Los Angeles City Hall; 2) one copy on the bulletin board located at the Main Street entrance to the Los Angeles City Hall East; 3) one copy on the bulletin board located at the Temple Street entrance to the Los Angeles County Hall of Records.

Copies of said ordinance were posted conspicuously beginning on **January 18, 2017** and will be continuously posted for ten or more days.

I declare under penalty of perjury that the foregoing is true and correct.

Signed this **18th** day of **January 2017** at Los Angeles, California.



Juan Verano, Deputy City Clerk

Ordinance Effective Date: **February 27, 2017**

Council File No. **14-0450-S1**

(Q) QUALIFIED CONDITIONS OF APPROVAL

Pursuant to Section 12.32 G of the Municipal Code, the following limitations are hereby imposed upon the use of the subject property, subject to the "Q" Qualified classification.

A. Entitlement Conditions

1. **Use.** The use of the westerly 16,500 square-foot portion of the subject site shall be limited to those permitted in the RAS4 Zone.
2. **Site Plan.** The development of the property shall be in substantial conformance with this approval and the plans submitted by the applicant and attached to the case file as Exhibit B 3.
3. **Floor Area.** The total floor area of the new building on the subject property shall not exceed 3:1 FAR.
4. **Height.** The height of the proposed hotel building shall not exceed 50 feet, except for architectural elements which shall not to exceed 56 feet in height.
5. **Parking.** The project shall provide parking in compliance with the L.A.M.C. Section 12.21-A 4.
6. **Light and Glare.** The exterior of the proposed buildings shall be constructed of materials which reduce glare and reflectivity, such as high-performance tinted or deep-color glazed glass, pre-cast concrete or fabricated wall surfaces. All exterior windows should be tinted or contain a light reflective film to reduce illumination levels outside of the buildings.
7. **Graffiti.** Every building, structure or portion thereof shall be maintained in a safe and sanitary condition and good repair, and free from graffiti, debris, rubbish, garbage, trash, overgrown vegetation or other similar material pursuant to Municipal Code Section 91.8104. The exterior of all buildings and fences shall be free from graffiti when such graffiti is visible from a public street, or alley, pursuant to Municipal Code Section 91.8104.15.
8. **Signage.** On-site signs shall be limited to the maximum allowable under the L.A.M.C. Section 12.12.2-A 6.