

ORDINANCE NO. 183801

An ordinance amending Section 12.04 of the Los Angeles Municipal Code by amending the zoning map.

THE PEOPLE OF THE CITY OF LOS ANGELES DO ORDAIN AS FOLLOWS:

Section \_\_\_\_ Section 12.04 of the Los Angeles municipal Code is hereby amended by changing the zone classifications of property shown upon a portion of the Zoning Map incorporated therein and made a part of Article 2, Chapter 1 of the LAMC, so that such portion of the Zoning Map shall conform to the zoning on the map attached hereto and incorporated herein by this reference.

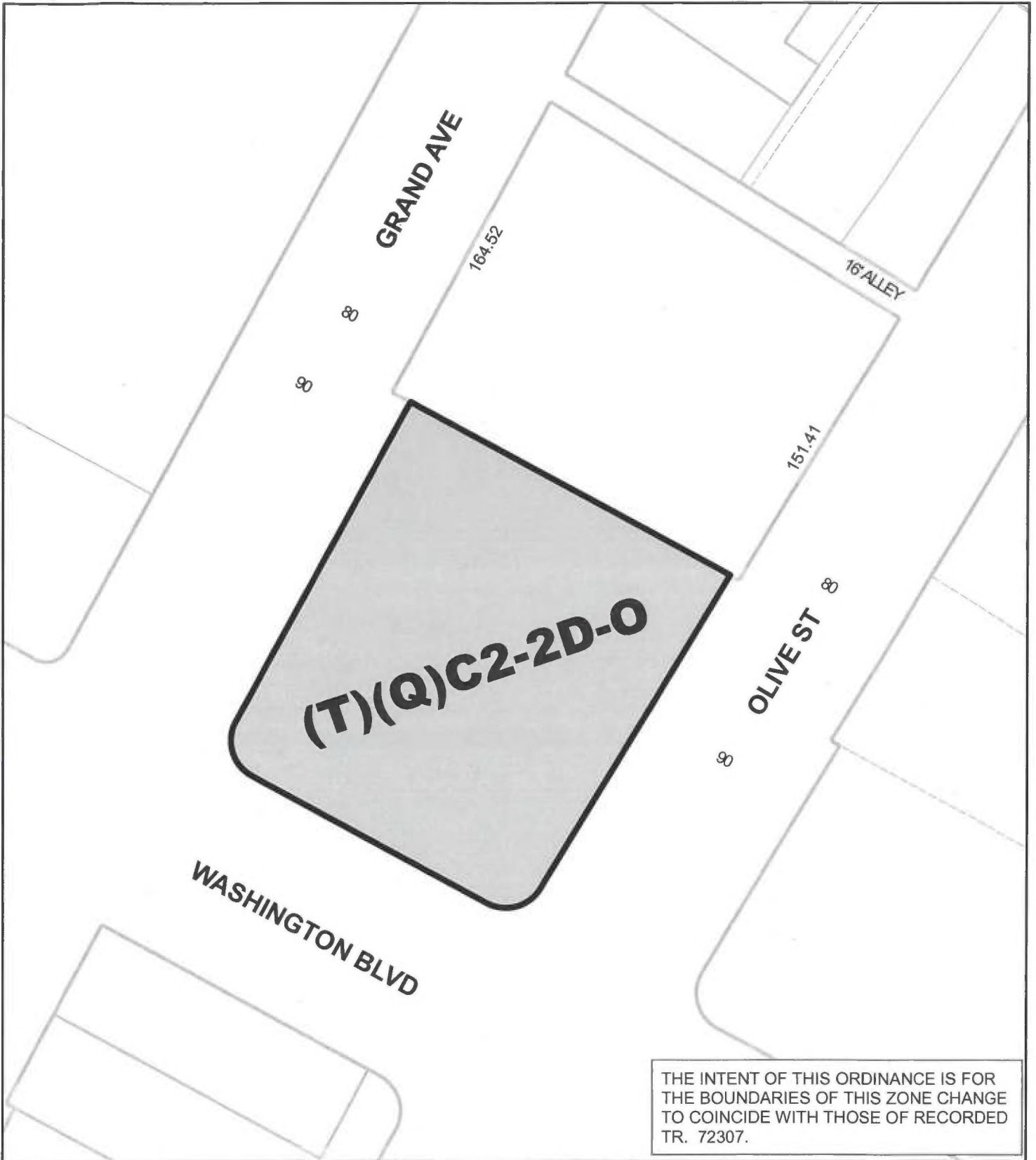

THE INTENT OF THIS ORDINANCE IS FOR THE BOUNDARIES OF THIS ZONE CHANGE TO COINCIDE WITH THOSE OF RECORDED TR. 72307.



50 25 0 50 Feet



C.M. 123 A 205, 124-5 A 205	CPC 2008-596 GPA ZC SPR
-----------------------------	-------------------------

LH/ cf

032415





50 25 0 50 Feet

C.M. 123 A 205, 124-5 A 205	CPC 2008-596 GPA ZC SPR
-----------------------------	-------------------------

LH/CF

SOUTHEAST LOS ANGELES

032415

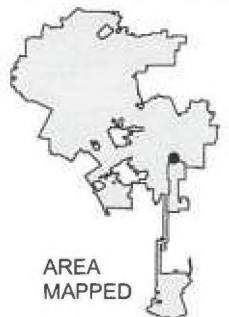

### (Q) QUALIFIED CONDITIONS OF APPROVAL

Pursuant to Section 12.32 G of the Municipal Code, the following limitations are hereby imposed upon the use of the subject property, subject to the "Q" Qualified classification.

#### **Entitlement Conditions**

1. **Site Plan.** The use and development of the subject property shall be in substantial conformance with the site plan labeled Exhibit "A" and Condition Number 45 and/or any other conditions that modify Exhibit "A". Prior to the issuance of building permits, detailed development plans including a site plan illustrating elevations, facades, and architectural treatment, and a landscape/irrigation plan shall be submitted for review and approval for the Planning Department. The plans shall comply with provisions of the Municipal Code, the subject conditions, and the intent of the subject permit authorization.
2. **Use.** Use of the subject property shall be limited to the use and area provisions of the C2-2D-O zone; multifamily residential and commercial uses shall be permitted.
3. **Parking.** Pursuant to LAMC Section 12.21A4(x)(3) the Project need not provide more than 34 commercial parking spaces and 139 residential parking spaces.
4. **Residential Density.** Not more than 160 dwelling units may be constructed on the property.
5. **Affordable Units.** A minimum of 15 percent of the total dwelling units shall be reserved as affordable units, as defined by the State Density Bonus Law 65915 (C)(2).
6. **Housing Requirements.** Prior to issuance of a building permit, the owner shall execute a covenant to the satisfaction of the Los Angeles Housing Department (LAHD) to make 5 percent available to Extremely Low and 10 percent available to Very Low Income Households, at a rent or sale determined to be affordable to such households by LAHD for a period of 55 years. Enforcement of the terms of said covenant shall be the responsibility of LAHD. The applicant will present a copy of the recorded covenant to the Planning Department for inclusion in this file.
7. **Open Space.** A minimum of 16,275 square feet open space shall be provided on site.
8. **HEPA Air Filtration Equipment.** The Project shall install and maintain air filters meeting or exceeding the ASHRAE Standard 52.2 Minimum Efficiency Reporting Value (MERV) of 11 or higher.
9. **Landscape Plan.** All open areas not used for buildings, driveways, parking areas, recreational facilities or walks shall be attractively landscaped and maintained in accordance with a landscape plan prepared by a licensed landscape architect to the satisfaction of the City Planning Department.

#### **Environmental Conditions**

10. **Aesthetics (Landscape Plan).** All open areas not used for buildings, driveways, parking areas, recreational facilities or walks shall be attractively landscaped and maintained in accordance with a landscape plan and an automatic irrigation plan, prepared by a Landscape Practitioner (Sec. 12.40-D) and to the satisfaction of the decision maker.

**11. Aesthetics (Vandalism).**

- a. Every building, structure, or portion thereof, shall be maintained in a safe and sanitary condition and good repair, and free from, debris, rubbish, garbage, trash, overgrown vegetation or other similar material, pursuant to Municipal Code Section 91.8104.
- b. The exterior of all buildings and fences shall be free from graffiti when such graffiti is visible from a street or alley, pursuant to Municipal Code Section 91.8104.15.

**12. Aesthetics (Signage on Construction Barriers).**

- a. The Applicant shall affix or paint a plainly visible sign, on publically accessible portions of the construction barriers, with the following language: "POST NO BILLS".
- b. Such language shall appear at intervals of no less than 25 feet along the length of the publically accessible portions of the barrier.
- c. The Applicant shall be responsible for maintaining the visibility of the required signage and for maintaining the construction barrier free and clear of any unauthorized signs within 48 hours of occurrence.

**13. Aesthetics (Light).** Outdoor lighting shall be designed and installed with shielding, such that the light source cannot be seen from adjacent residential properties or the public right-of-way.**14. Aesthetics (Glare).** The exterior of the proposed structure shall be constructed of materials such as, but not limited to, high-performance and/or non-reflective tinted glass (no mirror-like tints or films) and pre-cast concrete or fabricated wall surfaces to minimize glare and reflected heat.**15. Air Pollution (Demolition, Grading, and Construction Activities).**

- a. All unpaved demolition and construction areas shall be wetted at least twice daily during excavation and construction, and temporary dust covers shall be used to reduce dust emissions and meet SCAQMD District Rule 403.
- b. The construction area shall be kept sufficiently dampened to control dust caused by grading and hauling, and at all times provide reasonable control of dust caused by wind.
- c. All clearing, earth moving, or excavation activities shall be discontinued during periods of high winds (i.e., greater than 15 mph), so as to prevent excessive amounts of dust.
- d. All dirt/soil loads shall be secured by trimming, watering or other appropriate means to prevent spillage and dust.
- e. All dirt/soil materials transported off-site shall be either sufficiently watered or securely covered to prevent excessive amount of dust.
- f. General contractors shall maintain and operate construction equipment so as to minimize exhaust emissions.
- g. Trucks having no current hauling activity shall not idle but be turned off.

**16. Tree Removal (Non-Protected Trees).**

- a. Removal Prior to the issuance of any permit, a plot plan shall be prepared indicating the location, size, type, and general condition of all existing trees on the site and within the adjacent public right(s)-of-way.
- b. All significant (8-inch or greater trunk diameter, or cumulative trunk diameter if multi-trunked, as measured 54 inches above the ground) non-protected trees on the site proposed for removal shall be replaced at a 1:1 ratio with a minimum 24-inch box tree. Net, new trees, located within the parkway of the adjacent public right(s)-of-way, may be counted toward replacement tree requirements.
- c. Removal or planting of any tree in the public right-of-way requires approval of the Board of Public Works. Contact Urban Forestry Division at: 213-847-3077. All trees in the public right-of-way shall be provided per the current standards of the Urban Forestry Division the Department of Public Works, Bureau of Street Services.

**17. Tree Removal (Locally Protected Species).**

- a. All protected tree removals require approval from the Board of Public Works.
- b. A Tree Report shall be submitted to the Urban Forestry Division of the Bureau of Street Services, Department of Public Works, for review and approval (213-847-3077), prior to implementation of the Report's recommended measures.
- c. A minimum of two trees (a minimum of 48-inch box in size if available) shall be planted for each protected tree that is removed. The canopy of the replacement trees, at the time they are planted, shall be in proportion to the canopies of the protected tree(s) removed and shall be to the satisfaction of the Urban Forestry Division.
- d. The location of trees planted for the purposes of replacing a removed protected tree shall be clearly indicated on the required landscape plan, which shall also indicate the replacement tree species and further contain the phrase "Replacement Tree" in its description.
- e. Bonding (Tree Survival):
  1. The Applicant shall post a cash bond or other assurances acceptable to the Bureau of Engineering in consultation with the Urban Forestry Division and the decision maker guaranteeing the survival of trees required to be maintained, replaced or relocated in such a fashion as to assure the existence of continuously living trees for a minimum of three years from the date that the bond is posted or from the date such trees are replaced or relocated, whichever is longer. Any change of ownership shall require that the new owner post a new oak tree bond to the satisfaction of the Bureau of Engineering. Subsequently, the original owner's oak tree bond may be exonerated.
  2. The City Engineer shall use the provisions of Section 17.08 as its procedural guide in satisfaction of said bond requirements and processing. Prior to exoneration of the bond, the owner of the property shall provide evidence satisfactory to the City Engineer and Urban Forestry Division that the oak trees were properly replaced, the date of the replacement and the survival of the replacement trees for a period of three years.

**18. Tree Removal (Public Right-of-Way).**

- a. Removal of trees in the public right-of-way requires approval by the Board of Public Works.
- b. The required Tree Report shall include the location, size, type, and condition of all existing trees in the adjacent public right-of-way and shall be submitted for review and approval by the Urban Forestry Division of the Bureau of Street Services, Department of Public Works (213-847-3077).
- c. The plan shall contain measures recommended by the tree expert for the preservation of as many trees as possible. Mitigation measures such as replacement by a minimum of 24-inch box trees in the parkway and on the site, on a 1:1 basis, shall be required for the unavoidable loss of significant (8-inch or greater trunk diameter, or cumulative trunk diameter if multi-trunked, as measured 54 inches above the ground) trees in the public right-of-way.
- d. All trees in the public right-of-way shall be provided per the current Urban Forestry Division standards.

**19. Cultural Resources (Archaeological).** If any archaeological materials are encountered during the course of Project development, all further development activity shall halt and:

- a. The services of an archaeologist shall then be secured by contacting the South Central Coastal Information Center (657-278-5395) located at California State University Fullerton, or a member of the Society of Professional Archaeologist (SOPA) or a SOPA-qualified archaeologist, who shall assess the discovered material(s) and prepare a survey, study or report evaluating the impact.
- b. The archaeologist's survey, study or report shall contain a recommendation(s), if necessary, for the preservation, conservation, or relocation of the resource.
- c. The Applicant shall comply with the recommendations of the evaluating archaeologist, as contained in the survey, study or report.
- d. Project development activities may resume once copies of the archaeological survey, study or report are submitted to:  
SCCIC Department of Anthropology  
McCarthy Hall 477  
CSU Fullerton  
800 North State College Boulevard  
Fullerton, CA 92834
- e. Prior to the issuance of any building permit, the Applicant shall submit a letter to the case file indicating what, if any, archaeological reports have been submitted, or a statement indicating that no material was discovered.
- f. A covenant and agreement binding the Applicant to this condition shall be recorded prior to issuance of a grading permit.

**20. Seismic.** The design and construction of the Project shall conform to the California Building Code seismic standards as approved by the Department of Building and Safety.

**21. Erosion/Grading/Short-Term Construction Impacts.**

- a. The Applicant shall provide a staked signage at the site with a minimum of 3-inch lettering containing contact information for the Senior Street Use Inspector (Department of Public Works), the Senior Grading Inspector (LADBS) and the hauling or general contractor.
- b. All grading activities require grading permits from the Department of Building and Safety. Additional provisions are required for grading activities within Hillside areas.
- c. Excavation and grading activities shall be scheduled during dry weather periods. If grading occurs during the rainy season (October 15 through April 1), diversion dikes shall be constructed to channel runoff around the site. Channels shall be lined with grass or roughened pavement to reduce runoff velocity.
- d. Stockpiles, excavated, and exposed soil shall be covered with secured tarps, plastic sheeting, erosion control fabrics, or treated with a bio-degradable soil stabilizer.

**22. Geotechnical Report.** The Project shall comply with the conditions contained within the Department of Building and Safety's Geology and Soils Report Approval Letter for the proposed Project and as it may be subsequently amended or modified.**23. Explosion/Release (Methane Gas).**

- a. All commercial, industrial, and institutional buildings shall be provided with an approved Methane Control System, which shall include these minimum requirements; a vent system and gas-detection system which shall be installed in the basements or the lowest floor level on grade, and within under floor space of buildings with raised foundations. The gas-detection system shall be designed to automatically activate the vent system when an action level equal to 25% of the Lower Explosive Limit (LEL) methane concentration is detected within those areas.
- b. All commercial, industrial, institutional and multiple residential buildings covering over 50,000 square feet of lot area or with more than one level of basement shall be independently analyzed by a qualified engineer, as defined in Section 91.7102 of the Municipal Code, hired by the building owner. The engineer shall investigate and recommend mitigation measures which will prevent or retard potential methane gas seepage into the building. In addition to the other items listed in this section, the owner shall implement the engineer's design recommendations subject to Department of Building and Safety and Fire Department approval.
- c. All multiple residential buildings shall have adequate ventilation as defined in Section 91.7102 of the Municipal Code of a gas-detection system installed in the basement or on the lowest floor level on grade, and within the under floor space in buildings with raised foundations.

**24. Listed Sites (Removal of Underground Storage Tanks).**

- f. Underground Storage Tanks shall be decommissioned or removed as determined by the Los Angeles City Fire Department Underground Storage Tank Division. If any contamination is found, further remediation measures shall be developed with the assistance of the Los Angeles City Fire Department and other appropriate State agencies.



- g. Prior to issuance of a use of land or building permit, a letter certifying that remediation is complete from the appropriate agency (Department of Toxic Substance Control or the Regional Water Quality Control Board) shall be submitted to the decision maker.
25. **General Plan Designation/Zoning.** The Applicant shall comply with mitigation measures required by this mitigated negative declaration (MND).
26. **Increased Noise Levels (Demolition, Grading, and Construction Activities).**
- a. The Project shall comply with the City of Los Angeles Noise Ordinance No. 144,331 and 161,574, and any subsequent ordinances, which prohibit the emission or creation of noise beyond certain levels at adjacent uses unless technically infeasible.
  - b. Construction and demolition shall be restricted to the hours of 7:00 am to 6:00 pm Monday through Friday, and 8:00 am to 6:00 pm on Saturday.
  - c. Demolition and construction activities shall be scheduled so as to avoid operating several pieces of equipment simultaneously, which causes high noise levels.
  - d. The Project contractor shall use power construction equipment with state-of-the-art noise shielding and muffling devices.
27. **Increased Noise Levels (Parking Structure Ramps).**
- a. Concrete, not metal, shall be used for construction of parking ramps.
  - b. The interior ramps shall be textured to prevent tire squeal at turning areas.
  - c. Parking lots located adjacent to residential buildings shall have a solid decorative wall adjacent to the residential.
28. **Increased Noise Levels (Mixed-Use Development).** Wall and floor-ceiling assemblies separating commercial tenant spaces, residential units, and public places, shall have a Sound Transmission Coefficient (STC) value of at least 50, as determined in accordance with ASTM E90 and ASTM E413.
29. **Increased Noise Levels (Residential Within 500 Feet of Freeway).** Wall and roof-ceiling assemblies making up the building envelope shall have an STC of at least 50, and exterior windows shall have a minimum STC of 30, as determined in accordance with ASTM E90 and ASTM E413, or any amendment thereto.
30. **Severe Noise (Railroad).**
- h. Wall and roof-ceiling assemblies making up the building envelope shall have an STC of at least 50, and exterior windows shall have a minimum STC of 30, as determined in accordance with ASTM E90 and ASTM E413, or any amendment thereto.
  - i. The Applicant shall verify, through an acoustical engineer, that installed sound insulation is sufficient to mitigate interior noise levels below a CNEL of 45 dBA in any habitable room.
31. **Public Services (Fire).** The following recommendations of the Fire Department relative to fire safety shall be incorporated into the building plans, which includes the submittal of a plot plan for approval by the Fire Department either prior to the recordation of a final map or the

approval of a building permit. The plot plan shall include the following minimum design features: fire lanes, where required, shall be a minimum of 20 feet in width; all structures must be within 300 feet of an approved fire hydrant, and entrances to any dwelling unit or guest room shall not be more than 150 feet in distance in horizontal travel from the edge of the roadway of an improved street or approved fire lane.

32. **Public Services (Police – Demolition/Construction Sites).** Fences shall be constructed around the site to minimize trespassing, vandalism, short-cut attractions and attractive nuisances.
33. **Public Services (Police).** The plans shall incorporate the design guidelines relative to security, semi-public and private spaces, which may include but not be limited to access control to building, secured parking facilities, walls/fences with key systems, well-illuminated public and semi-public space designed with a minimum of dead space to eliminate areas of concealment, location of toilet facilities or building entrances in high-foot traffic areas, and provision of security guard patrol throughout the Project site if needed. Please refer to "Design Out Crime Guidelines: Crime Prevention Through Environmental Design", published by the Los Angeles Police Department. Contact the Community Relations Division, located at 100 W. 1st Street, #250, Los Angeles, CA 90012; (213) 486-6000. These measures shall be approved by the Police Department prior to the issuance of building permits.
34. **Public Services (Schools).** The Applicant shall pay school fees to the Los Angeles Unified School District to offset the impact of additional student enrollment at schools serving the Project area.
35. **Public Services (Street Improvements Not Required by DOT).** The Project shall comply with the Bureau of Engineering's requirements for street dedications and improvements that will reduce traffic impacts in direct portion to those caused by the proposed Project's implementation.
36. **Recreation (Increased Demand for Parks Or Recreational Facilities).** *(Subdivision)* Pursuant to Section 17.12-A or 17.58 of the Los Angeles Municipal Code, the Applicant shall pay the applicable Quimby fees for the construction of dwelling units.
37. **Transportation (Haul Route).**
  - j. The developer shall install appropriate traffic signs around the site to ensure pedestrian and vehicle safety.
  - k. (Non-Hillside): Projects involving the import/export of 20,000 cubic yards or more of dirt shall obtain haul route approval by the Department of Building and Safety.
38. **Transportation/Traffic.**
  - l. Projects shall comply with clearance requirements for Metrorail per ZI 1117 and with applicable requirements per Metro Memo dated 11/8/2013.
  - m. Projects shall comply with clearance requirements for MetroRail per ZI 1117 and with applicable requirements per Metro Memo dated 11/8/2013 (attached).
  - n. Comply with the Los Angeles Department of Transportation "Traffic Analysis for the Proposed Grand Metropolitan Mixed-Use Development Project Located at 233 Washington Boulevard," memo dated September 25, 2013, Conditions A-E.

- o. Any roadway widening and striping as the result of the Project mitigation shall maintain existing bicycle lanes along Olive St. and Grand Ave. and not preclude or conflict with the implementation of the 2010 Bicycle Plan in the Project vicinity.

**39. Utilities (Local Water Supplies - Landscaping).**

- a. The Project shall comply with Ordinance No. 170,978 (Water Management Ordinance), which imposes numerous water conservation measures in landscape, installation, and maintenance (e.g., use drip irrigation and soak hoses in lieu of sprinklers to lower the amount of water lost to evaporation and overspray, set automatic sprinkler systems to irrigate during the early morning or evening hours to minimize water loss due to evaporation, and water less in the cooler months and during the rainy season).

In addition to the requirements of the Landscape Ordinance, the landscape plan shall incorporate the following:

- b. Weather-based irrigation controller with rain shutoff
- c. Matched precipitation (flow) rates for sprinkler heads
- d. Drip/microspray/subsurface irrigation where appropriate
- e. Minimum irrigation system distribution uniformity of 75 percent
- f. Proper hydro-zoning, turf minimization and use of native/drought tolerant plan materials
- g. Use of landscape contouring to minimize precipitation runoff
- h. A separate water meter (or submeter), flow sensor, and master valve shutoff shall be installed for existing and expanded irrigated landscape areas totaling 5,000 sf. and greater.

**40. Utilities (Local Water Supplies - All New Construction).**

- a. If conditions dictate, the Department of Water and Power may postpone new water connections for this Project until water supply capacity is adequate.
- b. Install high-efficiency toilets (maximum 1.28 gpf), including dual-flush water closets, and high-efficiency urinals (maximum 0.5 gpf), including no-flush or waterless urinals, in all restrooms as appropriate.
- c. Install restroom faucets with a maximum flow rate of 1.5 gallons per minute.
- d. A separate water meter (or submeter), flow sensor, and master valve shutoff shall be installed for all landscape irrigation uses.
- e. Single-pass cooling equipment shall be strictly prohibited from use. Prohibition of such equipment shall be indicated on the building plans and incorporated into tenant lease agreements. (Single-pass cooling refers to the use of potable water to extract heat from process equipment, e.g. vacuum pump, ice machines, by

passing the water through equipment and discharging the heated water to the sanitary wastewater system.)

41. **Utilities (Local Water Supplies - New Commercial or Industrial).** All restroom faucets shall be of a self-closing design.
42. **Utilities (Local Water Supplies - New Residential).**
  - a. Install no more than one showerhead per shower stall, having a flow rate no greater than 2.0 gallons per minute.
  - b. Install and utilize only high-efficiency clothes washers (water factor of 6.0 or less) in the Project, if proposed to be provided in either individual units and/or in a common laundry room(s). If such appliance is to be furnished by a tenant, this requirement shall be incorporated into the lease agreement, and the Applicant shall be responsible for ensuring compliance.
  - c. Install and utilize only high-efficiency Energy Star-rated dishwashers in the Project, if proposed to be provided. If such appliance is to be furnished by a tenant, this requirement shall be incorporated into the lease agreement, and the Applicant shall be responsible for ensuring compliance.
43. **Utilities (Solid Waste Recycling)**
  - a. (Operational) Recycling bins shall be provided at appropriate locations to promote recycling of paper, metal, glass, and other recyclable material. These bins shall be emptied and recycled accordingly as a part of the Project's regular solid waste disposal program.
  - b. (Construction/Demolition) Prior to the issuance of any demolition or construction permit, the Applicant shall provide a copy of the receipt or contract from a waste disposal company providing services to the Project, specifying recycled waste service(s), to the satisfaction of the Department of Building and Safety. The demolition and construction contractor(s) shall only contract for waste disposal services with a company that recycles demolition and/or construction-related wastes.
  - c. (Construction/Demolition) To facilitate on-site separation and recycling of demolition- and construction-related wastes, the contractor(s) shall provide temporary waste separation bins on-site during demolition and construction. These bins shall be emptied and the contents recycled accordingly as a part of the Project's regular solid waste disposal program.
44. **Utilities (Solid Waste Disposal).** All waste shall be disposed of properly. Use appropriately labeled recycling bins to recycle demolition and construction materials including: solvents, water-based paints, vehicle fluids, broken asphalt and concrete, bricks, metals, wood, and vegetation. Non-recyclable materials/wastes shall be taken to an appropriate landfill. Toxic wastes must be discarded at a licensed regulated disposal site.

#### **Administrative Conditions of Approval**

45. **Final Plans.** Prior to the issuance of any building permits for the Project by the Department of Building and Safety, the applicant shall submit all final construction plans that are awaiting

issuance of a building permit by the Department of Building and Safety for final review and approval by the Department of City Planning. All plans that are awaiting issuance of a building permit by the Department of Building and Safety shall be stamped by Department of City Planning staff "Final Plans". A copy of the Final Plans, supplied by the applicant, shall be retained in the subject case file.

46. **Notations on Plans.** Plans submitted to the Department of Building and Safety, for the purpose of processing a building permit application shall include all of the Conditions of Approval herein attached as a cover sheet, and shall include any modifications or notations required herein.
47. **Approval, Verification and Submittals.** Copies of any approvals, guarantees or verification of consultations, review of approval, plans, etc., as may be required by the subject conditions, shall be provided to the Department of City Planning prior to clearance of any building permits, for placement in the subject file.
48. **Code Compliance.** Use, area, height, and yard regulations of the zone classification of the subject property shall be complied with, except where granted conditions differ herein.
49. **Department of Building and Safety.** The granting of this determination by the Director of Planning does not in any way indicate full compliance with applicable provisions of the Los Angeles Municipal Code Chapter IX (Building Code). Any corrections and/or modifications to plans made subsequent to this determination by a Department of Building and Safety Plan Check Engineer that affect any part of the exterior design or appearance of the Project as approved by the Director, and which are deemed necessary by the Department of Building and Safety for Building Code compliance, shall require a referral of the revised plans back to the Department of City Planning for additional review and sign-off prior to the issuance of any permit in connection with those plans.
50. **Enforcement.** Compliance with these conditions and the intent of these conditions shall be to the satisfaction of the Department of City Planning.
51. **Expiration.** In the event that this grant is not utilized within three years of its effective date (the day following the last day that an appeal may be filed), the grant shall be considered null and void. Issuance of a building permit, and the initiation of, and diligent continuation of, construction activity shall constitute utilization for the purposes of this grant.
52. **Covenant.** Prior to the issuance of any permits relative to this matter, an agreement concerning all of the information contained in these conditions shall be recorded by the property owner in the County Recorder's Office. The agreement shall run with the land and shall be binding on any subsequent owners, heir, or assigns. Further, the agreement must be submitted to the Planning Department for approval before being recorded. After recordation, a Certified Copy bearing the Recorder's number and date must be given to the City Planning Department for attachment to the subject file.
53. **Indemnification.** The applicant shall defend, indemnify and hold harmless the City, its agents, officers, or employees from any claim, action, or proceeding against the City or its agents, officers, or employees relating to or to attack, set aside, void or annul this approval which action is brought within the applicable limitation period. The City shall promptly notify the applicant of any claim, action, or proceeding and the City shall cooperate fully in the defense. If the City fails to promptly notify the applicant of any claim action or proceeding,

or if the City fails to cooperate fully in the defense, the applicant shall not thereafter be responsible to defend, indemnify, or hold harmless the City.

### **“D” DEVELOPMENT CONDITIONS**

Pursuant to Section 12.32 H of the Municipal Code, the following limitations are hereby imposed upon the use of the subject property, subject to the “D” Development classification.

1. **Height.** The building shall be limited to a height of 97 feet, as defined by Los Angeles Municipal Code (LAMC) Section 12.03, as depicted on Exhibit A.
2. **Floor Area Ratio (FAR).** The project FAR shall be limited to 3.8:1 and may be granted a floor area bonus of 35% through the Greater Downtown Housing Incentive Area provisions.

Section \_\_. The City Clerk shall certify to the passage of this ordinance and have it published in accordance with Council policy, either in a daily newspaper circulated in the City of Los Angeles or by posting for ten days in three public places in the City of Los Angeles: one copy on the bulletin board located at the Main Street entrance to the Los Angeles City Hall; one copy on the bulletin board located at the Main Street entrance to the Los Angeles City Hall East; and one copy on the bulletin board located at the Temple Street entrance to the Los Angeles County Hall of Records.

I hereby certify that the foregoing ordinance was introduced at the Council of the City of Los Angeles, by a majority vote of all its members, at the meeting of AUG 0 4 2015.

Holly L. Wolcott, City Clerk

By   
Deputy

Approved AUG 0 6 2015

  
Mayor

Pursuant to Section 558 of the City Charter, the City Planning Commission on March 12, 2015 recommended this ordinance be adopted by the City Council.

  
James K. Williams, Commission Executive Assistant II  
City Planning Commission

File No. 15-0785



## DECLARATION OF POSTING ORDINANCE

I, VERONICA COLEMAN-WARNER, state as follows: I am, and was at all times hereinafter mentioned, a resident of the State of California, over the age of eighteen years, and a Deputy City Clerk of the City of Los Angeles, California.

Ordinance No.183801 – General Plan Amendment and Zone change for properties at 233, 235, and 243 West Washington Boulevard and 1841 and 1843 South Olive Street – CPC-2008-596-GPA-ZC-SPR - a copy of which is hereto attached, was finally adopted by the Los Angeles City Council on August 4, 2015, and under the direction of said City Council and the City Clerk, pursuant to Section 251 of the Charter of the City of Los Angeles and Ordinance No. 172959, on August 10, 2015 I posted a true copy of said ordinance at each of the three public places located in the City of Los Angeles, California, as follows: 1) one copy on the bulletin board located at the Main Street entrance to the Los Angeles City Hall; 2) one copy on the bulletin board located at the Main Street entrance to the Los Angeles City Hall East; 3) one copy on the bulletin board located at the Temple Street entrance to the Los Angeles County Hall of Records.

Copies of said ordinance were posted conspicuously beginning on August 10, 2015 and will be continuously posted for ten or more days.

I declare under penalty of perjury that the foregoing is true and correct.

Signed this 10th day of August, 2015 at Los Angeles, California.

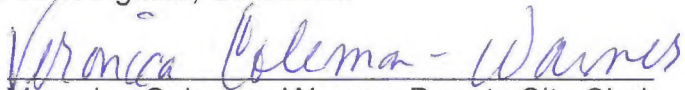
  
Veronica Coleman-Warner, Deputy City Clerk

Ordinance Effective Date: September 19, 2015

Council File No. 15-0785