

1

PUBLIC WORKS & GANG REDUCTION COMMITTEE  
10.24.2016

10-24-16  
Public Committee  
16-1176  
Bureau of Engineering

# ENVISION

GARY LEE MOORE, P.E., ENV SP, CITY ENGINEER  
MICHAEL SARULLO, P.E., ENV SP, PRINCIPAL CIVIL ENGINEER



Bureau of Engineering

# What is Envision?

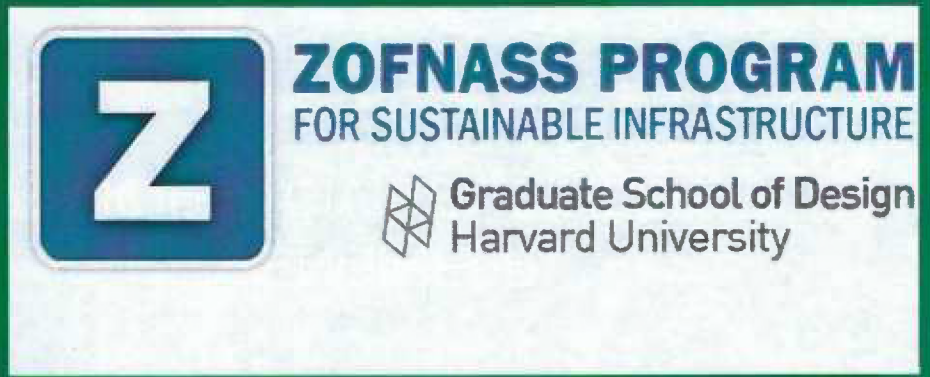

Envision was founded based on framework developed by:  
American Public Works Association, American Society of Civil Engineers and  
American Council Of Engineering Companies

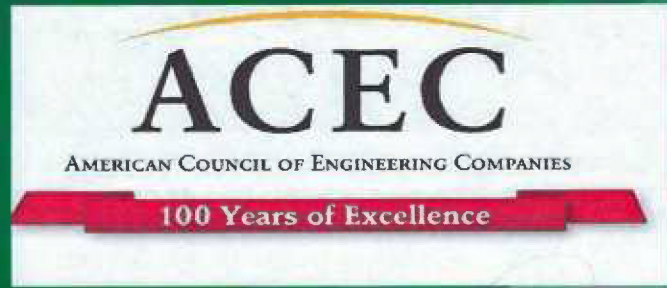
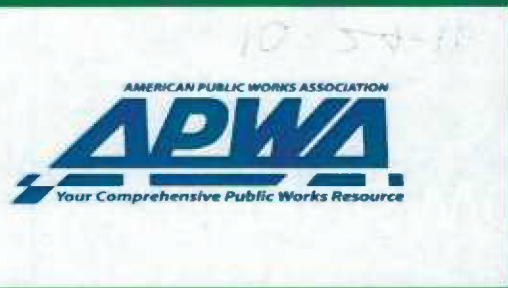

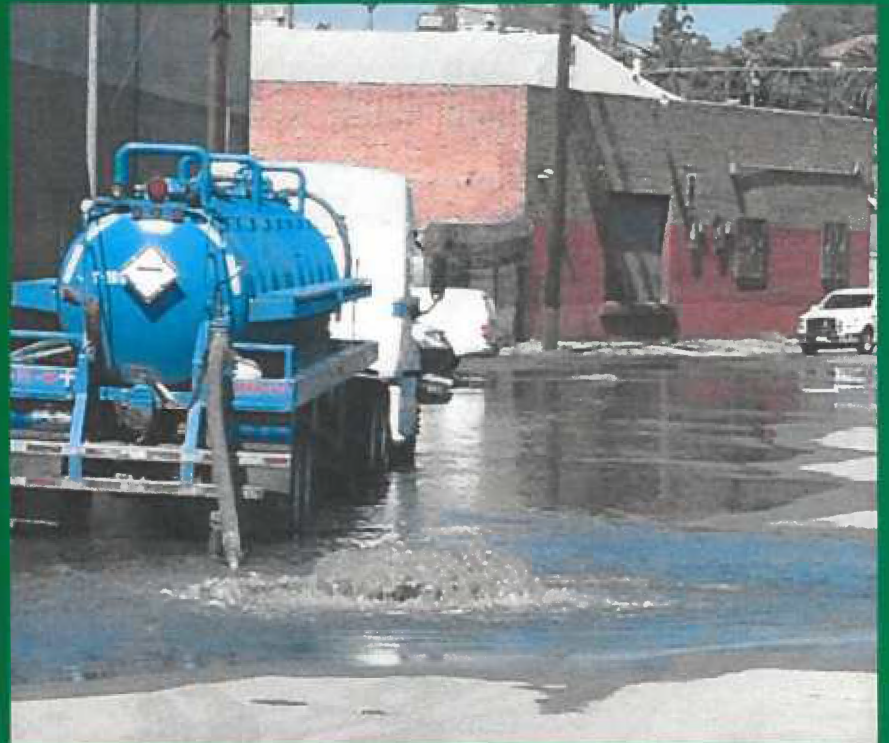

# United States Drought Monitor

## CALIFORNIA

10.4.2016

### Intensity:

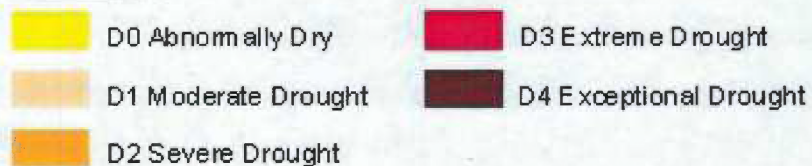

*The Drought Monitor focuses on broad-scale conditions. Local conditions may vary. See accompanying text summary for forecast statements.*

### **Author:**

Brian Fuchs

National Drought Mitigation Center

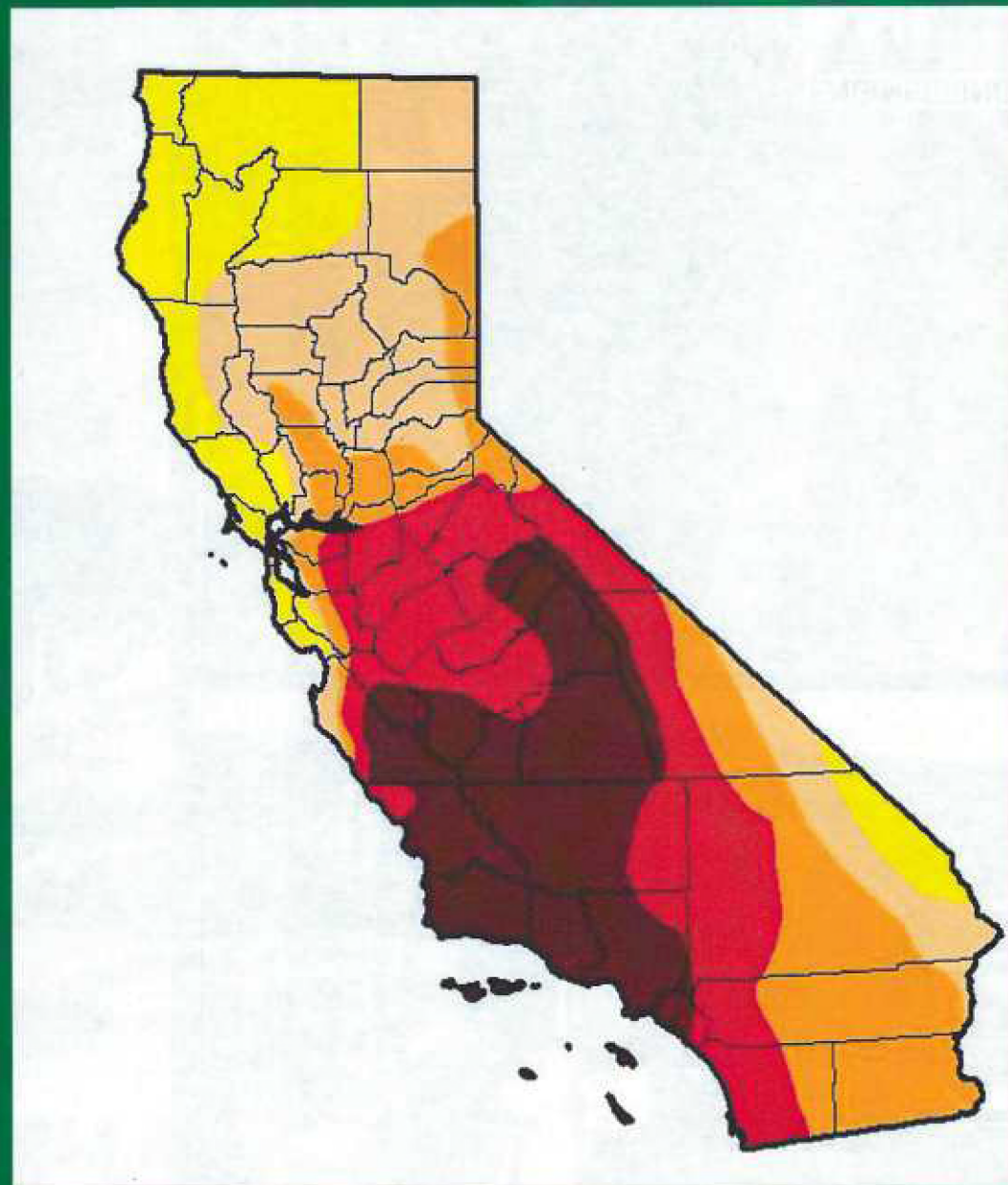

<http://droughtmonitor.unl.edu/>

Population is growing, resources are being depleted....



The projected growth in world population and consumption is not sustainable...



BY 2030 WE WILL REQUIRE  
**2 PLANET EARTHS**

TO MEET HUMANITY'S DEMAND FOR RENEWABLE RESOURCES

BUT WE HAVE ONLY ONE EARTH



#WhyFPMatters



# How is Envision Organized?

## 60 CREDITS IN 5 CATEGORIES



**QUALITY  
OF LIFE**

➔ Purpose, Community, Wellbeing



**LEADERSHIP**

➔ Collaboration, Management, Planning



**RESOURCE  
ALLOCATION**

➔ Materials, Energy, Water



**NATURAL  
WORLD**

➔ Siting, Land & Water, Biodiversity



**CLIMATE  
AND RISK**

➔ Emissions, Resilience

## ENVISION AWARD LEVELS

Recognition Level	Total Applicable Points (%)
Bronze Award	20
Silver Award	30
Gold Award	40
Platinum Award	50

# Types of Infrastructure Projects



## ENERGY

- Geothermal
- Hydroelectric
- Nuclear
- Coal
- Natural Gas
- Oil/Refinery
- Wind
- Solar
- Biomass



## WATER

- Potable water distribution
- Capture/Storage
- Water Reuse
- Stormwater Management
- Flood Control



## WASTE

- Solid waste
- Recycling
- Hazardous Waste
- Collection & Transfer



## TRANSPORT

- Airports
- Roads
- Highways
- Bikes
- Pedestrians
- Railways
- Public Transit
- Ports
- Waterways



## LANDSCAPE

- Public Realm
- Parks
- Ecosystem
- Services



## INFORMATION

- Telecommunications
- Internet
- Phones
- Satellites
- Data Centers
- Sensors

# Why Envision for Bureau of Engineering?

- Envision applies to infrastructure - bulk of BOE's work.
- Addresses design, planning, construction, operations and maintenance
- Speaks to the triple bottom line: social, economic and environmental goals
- Supports the Mayor's sustainability pLAN
- "Are we doing the "right" project?"





# Projects Being Considered for Envision



Sixth St Viaduct Replacement



Aliso Limekiln Creek Restoration

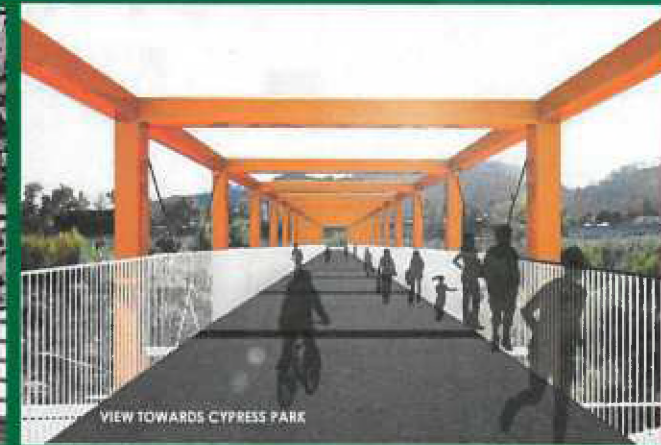

Taylor Yard Bike and Pedestrian Bridge



Albion Riverside Park

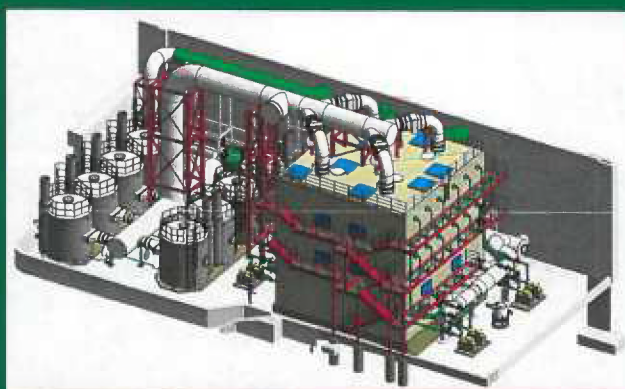

Wastewater Biotrickling Odor Control



LA River Projects



# Partnership with LA County



# Thank You!

