

## ARMINTA ST & VINELAND AVE NO. 1

Ed Ebrahimian, Director  
 Bureau of Street Lighting  
 Attn: Prop. 218 Section  
 1149 S. Broadway, 2nd Flr.  
 Los Angeles CA 90015

**PROJ ID / Elect. No.:** 4641  
**COUNCIL FILE No.:** 17-0900-S45

**Engineer:** Mark Sibley

**Mailing Date:** 06/08/17

Election Division  
 Attn: Joselin Alvarado  
 Piper Technical Center, 3rd FL  
 Mail Stop 168

**P.W. Hearing Date:** 07/19/17

**Council Hearing Date:** 07/26/17

Calendar Section  
 Attn: Staci Roberts  
 Room 395, City Hall  
 Mail Stop 160

Councilmember Nury Martinez  
 6th District  
 Room 470, City Hall  
 Stop 210

	City Assmt ID	APN	Owner name	Owner address	PROPOSED ASSESSMENT
1.	14837-001	2314-008-071	ALFREDO & MARIA CASTILLO	11104 ARMINTA ST #1 SUN VALLEY, CA 91352	\$42.35
2.	14837-001	2314-008-072	JOAN ROSARIO	11104 ARMINTA ST #2 SUN VALLEY, CA 91352	\$42.35
3.	14837-001	2314-008-073	VIRGINIA CARINO	11104 ARMINTA ST #3 SUN VALLEY, CA 91352	\$42.35
4.	14837-001	2314-008-074	MAGDALENA & BERNIE FUENTES	11104 ARMINTA ST #4 SUN VALLEY, CA 91352	\$42.35
5.	14837-001	2314-008-075	PEPE SALAZAR & JOSEFINA NAVA	11104 ARMINTA ST #5 SUN VALLEY, CA 91352	\$42.35
6.	14837-001	2314-008-076	ORLANDO & ROXANNA VICENCIO	3101 CONESTOGA CANYON RD PALMDALE, CA 93550	\$42.35
7.	14837-001	2314-008-077	RIGOBERTO CASTELLANOS & BLANCA MAGANA	11104 ARMINTA ST #7 SUN VALLEY, CA 91352	\$42.35
8.	14837-001	2314-008-078	HIEU VAN BE	11104 ARMINTA ST #8 SUN VALLEY, CA 91352	\$42.35
9.	14837-001	2314-008-079	MANUEL COUTINO	11104 ARMINTA ST #9 SUN VALLEY, CA 91352	\$42.35
10.	14837-001	2314-008-080	BLANCA DABOUB	11106 ARMINTA ST #1 SUN VALLEY, CA 91352	\$42.35
11.	14837-001	2314-008-081	MIRNA HERNANDEZ & REMBER MOLINA	11106 ARMINTA ST #2 SUN VALLEY, CA 91352	\$42.35
12.	14837-001	2314-008-082	JULIAN & MARIA CARRERA	11106 ARMINTA ST #3 SUN VALLEY, CA 91352	\$42.35
13.	14837-001	2314-008-083	ALLEN & KATHRIN ISSAGHOLIAN	11106 ARMINTA ST #4 SUN VALLEY, CA 91352	\$42.35
14.	14837-001	2314-008-084	FIL NAVARRA & LYNE BORBE NAVARRA	11106 ARMINTA ST #5 SUN VALLEY, CA 91352	\$42.35
15.	14837-001	2314-008-085	DIKRANOUHI KHAJIKIAN	11106 ARMINTA ST #6 SUN VALLEY, CA 91352	\$42.35
16.	14837-001	2314-008-086	JOSE ESPINOZA	11106 ARMINTA ST #7 SUN VALLEY, CA 91352	\$42.35
17.	14837-001	2314-008-087	URDANETA & JOSEPH AGAGON	11106 ARMINTA ST #8 SUN VALLEY, CA 91352	\$42.35
18.	14837-001	2314-008-088	JORGE CASILLAS	11106 ARMINTA ST #9 SUN VALLEY, CA 91352	\$42.35
19.	14837-002	2314-008-036	KURKEN ALYANAKIAN	2455 COLORADO BLVD, STE 400 LOS ANGELES, CA 90041	\$476.44
20.	14837-003	2314-008-037	KURKEN ALYANAKIAN	2455 COLORADO BLVD, STE 400 LOS ANGELES, CA 90041	\$285.86

21.	14837-004	2314-008-041	ARMINTA SQUARE LP - C/O KURKEN ALYANAKIAN	2455 COLORADO BLVD, STE 400 LOS ANGELES, CA 90041	\$990.99
22.	14837-005	2314-007-087	ARMINTA NORTH AND SOUTH LP C/O KURKAN ALYANAKIAN	2455 COLORADO BLVD, STE 400 LOS ANGELES, CA 90041	\$876.65
23.	14837-006	2314-007-015	RAFAEL & MARIA JAUREGUI	11061 ARMINTA ST SUN VALLEY, CA 91352	\$76.23
24.	14837-007	2314-007-017	KURKEN ALYANAKIAN	2455 COLORADO BLVD, STE 400 LOS ANGELES, CA 90041	\$160.08
25.	14837-008	2314-007-057	CARLOS GUZMAN & AURA RODRIGUEZ	11107 ARMINTA ST #1 SUN VALLEY, CA 91352	\$34.65
26.	14837-008	2314-007-058	ALEJANDRO JIMENEZ & CHRISTINA VILLEGAS	11107 ARMINTA ST #2 SUN VALLEY, CA 91352	\$34.65
27.	14837-008	2314-007-059	FAUSTINO ARMENDARIZ & GLORIA VUELVAS	11107 ARMINTA ST #3 SUN VALLEY, CA 91352	\$34.65
28.	14837-008	2314-007-060	HJECTOR & ELENA MADERA	11107 ARMINTA ST #4 SUN VALLEY, CA 91352	\$34.65
29.	14837-008	2314-007-061	ARMEN & LENA SAHAKYAN, VALENTIN GALFAYAN	11107 ARMINTA ST #5 SUN VALLEY, CA 91352	\$34.65
30.	14837-008	2314-007-062	CELFA LUNTUMBUEZ	11107 ARMINTA ST #6 SUN VALLEY, CA 91352	\$34.65
31.	14837-008	2314-007-063	GARNIK GHAZARYAN	11107 ARMINTA ST #7 SUN VALLEY, CA 91352	\$34.65
32.	14837-008	2314-007-064	HOMERO CONTRERAS	2118 RHUBARB LN PALMDALE, CA 93551	\$34.65
33.	14837-008	2314-007-065	BORIS TELYATNIKOV TRUST	6019 SHADYGLADE AVE NORTH HOLLYWOOD, CA 91606	\$34.65
34.	14837-008	2314-007-066	DANIEL MCHARGUE	11107 ARMINTA ST #10 SUN VALLEY, CA 91352	\$34.65
35.	14837-008	2314-007-067	AMPARO MENDOZA	11107 ARMINTA ST #11 SUN VALLEY, CA 91352	\$34.65
36.	14837-008	2314-007-068	JONATHAN & SHAMYL SANDOVAL	11107 ARMINTA ST #12 SUN VALLEY, CA 91352	\$34.65
37.	14837-008	2314-007-069	ANA CASTANEDA & CLAUDIA ARRAGA	3700 W VICTORY BLVD BURBANK, CA 91505	\$34.65
38.	14837-008	2314-007-070	LINDSAY ROGERS	11107 ARMINTA ST #14 SUN VALLEY, CA 91352	\$34.65
39.	14837-008	2314-007-071	STEPHEN HONCHARUK	11107 ARMINTA ST #15 SUN VALLEY, CA 91352	\$34.65
40.	14837-008	2314-007-072	JOSEPH MAHALLI	531 8TH ST BROOKLYN, NY 11218	\$34.65
41.	14837-008	2314-007-073	SARA WILSON	11107 ARMINTA ST #17 SUN VALLEY, CA 91352	\$34.65
42.	14837-008	2314-007-074	BRONT & JUSTINIA CHAVIRA	11107 ARMINTA ST #18 SUN VALLEY, CA 91352	\$34.65
43.	14837-008	2314-007-075	AKSANA KASHOUNIK & DANIEL AMEER	11107 ARMINTA ST #19 SUN VALLEY, CA 91352	\$34.65
44.	14837-008	2314-007-076	RAFAYEL AMBARTSUMYAN	11107 ARMINTA ST #20 SUN VALLEY, CA 91352	\$34.65
45.	14837-008	2314-007-077	TIMOTHY JOHNSON	11107 ARMINTA ST #21 SUN VALLEY, CA 91352	\$34.65
46.	14837-008	2314-007-078	ABEL HAKOBYAN	11107 ARMINTA ST #22 SUN VALLEY, CA 91352	\$34.65

**Total: \$4,390.85**

CERTIFICATION OF MAILING NOTICES OF  
STREET LIGHTING MAINTENANCE

(Section 6.95 to 6.127 of the  
Los Angeles Administrative Code)

I, Ruben Flamenco, hereby certify and declare that I am and was at all times herein mentioned a Deputy City Clerk of the City of Los Angeles; that, acting for and under the direction of the City Clerk and in accordance with the direction contained in Ordinance of Intention No(s). 184929, relating to the proposed maintenance of lighting posts and appliances and furnishing of electric current thereto in the above designated lighting district, under provisions of Sections 6.95 to 6.127 of the Los Angeles Administrative Code. I, on June 8, 2017 deposited in the United States mail at Los Angeles, California, a notice entitled "Notice of Public Hearings and Ballot for Operation of Streetlights," to each of the owners of real property within the Street Lighting maintenance assessment district:

ARMINTA STREET AND VINELAND AVENUE NO. 1

whose names and addresses appear on the last equalized assessment roll of the County of Los Angeles, or on file in the office of, and known to the City Clerk of the City of Los Angeles and that a true copy of such notice is attached hereto and made a part hereof.

I certify (or declare) under penalty of perjury that the foregoing is true and correct. At Los Angeles, California

June 8, 2017.

Date

  
DEPUTY CITY CLERK

# OFFICIAL PROPERTY OWNER ASSESSMENT BALLOT

STREET LIGHTING DISTRICT : "ARMINTA ST & VINELAND AVE NO. 1"

PROPERTY OWNER :

VOTE HERE

**YES, I am IN FAVOR** of the proposed Street Lighting Assessment District. I understand that I will be assessed \$34.65 annually for the operation and maintenance of the street light(s) adjacent to my property.

**NO, I am OPPOSED** to the proposed Street Lighting Assessment District. I understand that a majority NO vote will cause the streetlight(s) not to be installed, or if already installed, turned off and removed from service.

Election: 4641  
City Parcel: 14837-008  
County APN: 2314-007-078

*I hereby declare, under penalty of perjury under the laws of the State of California, that I am the record owner, or the authorized representative of the record owner, of the parcel identified above.  
(Both Name and Original Signature must be completed in order for your ballot to be counted.)*

\_\_\_\_\_  
PRINT NAME

(Property Owner, Authorized Rep., etc.)

\_\_\_\_\_  
ORIGINAL SIGNATURE

\_\_\_\_\_  
DATE

## INSTRUCTIONS

1. Vote by marking one of the boxes on the reverse side of this ballot - Mark only one box.
2. Mark your ballot with blue or black ink - Do not use pencil.
3. Print your name, sign and date the ballot - If more than one owner, only one owner needs to sign.
4. Return the ballot using the enclosed envelope.
5. Make sure the Los Angeles City Clerk address on the back of the ballot appears in the window of the return envelope.
6. Ballot must be received by Wednesday, July 26, 2017

LOS ANGELES CITY CLERK, ELECTION DIV.  
ATTN: 218 BALLOT ST. LTG. MNT. # 4641  
555 RAMIREZ STREET, SPACE 300  
LOS ANGELES, CA 90099-9716

As a covered entity under Title II of the Americans with Disabilities Act, the City of Los Angeles does not discriminate on the basis of disability and upon request will provide reasonable accommodation to ensure equal access to its programs, services and activities.



## NOTICE TO PROPERTY OWNERS

FOR THE FORMATION OF THE CITY OF LOS ANGELES  
STREET LIGHTING MAINTENANCE DISTRICT:

### ARMINTA ST & VINELAND AVE NO. 1

NOTE: Ballots must be received by Wednesday, July 26, 2017



*This package contains a ballot to determine if streetlights adjacent to your property will be installed.  
Este paquete contiene una boleta de votación si a luces adyacentes a su propiedad son instalada.*

In order to provide street lighting services near your property, an assessment district must be created to collect the annual cost for street lighting operation and maintenance from the adjacent property owners. This is your opportunity to vote (see instructions on back of ballot) on whether you want to have streetlights and accept the assessment added to your property taxes to pay for these costs.

### NOTICE

This notice informs you, as record owner of property within the proposed assessment district, which on 5/24/2017 the Los Angeles City Council declared its intention to form a new Street Lighting Maintenance District, under Council File number 17-0900-S45. All interested persons are invited to attend the public hearings and express opinions on the proposed assessment.

**Public Hearing:** Wednesday, July 19, 2017, 10:00 AM  
Board of Public Works – 3rd fl., Rm. 350, City Hall, 200 N. Spring Street.

**Council Hearing:** Wednesday, July 26, 2017, 10:00 AM  
Los Angeles City Council – 3rd fl., Rm. 340, City Hall, 200 N. Spring Street.

**Protest Procedure:** Protests presented for consideration to the Council are not binding, regardless of the number. The Council may accept or deny the protest(s) at its discretion. Any person may file a written protest or appeal with the City Clerk at any time prior to, or on the day of, the final public hearing by the City Council on this matter. Written protests shall specify the ground(s) upon which the protest is based, the name and mailing address of the person protesting, a description sufficient to identify the property for which the protest is being filed, the Council File number, and be mailed or delivered to the City Clerk, Room 395, Los Angeles City Hall, 200 N. Spring St., Los Angeles, CA 90012.

### ASSESSMENT INFORMATION

The proposed assessment described in this Notice is new and, if approved, will appear on your property tax bill. Proposition 218, the "Right to Vote on Taxes Act", was approved on the November 1996 statewide ballot, and added Article XIID to the California Constitution. It requires that a parcel's assessment may not exceed the reasonable cost for the proportional special benefit conferred on that parcel. Article XIID provides that only special benefits are assessable and the City must separate the general benefits from the special benefits. It also requires that publicly owned properties, which benefit from the improvements, be assessed.

1. **Proposed Annual Assessment (Your Property):** \$42.35 for FY 2017-18. \*
2. **Proposed Annual Assessment (Entire District):** \$4,390.85 for FY 2017-18.
3. **Duration of the Proposed Assessment:** Annually on your Property Tax Bill.
4. **Reason for the Assessment:** To pay for the cost of operating, servicing and maintaining local street lighting. These costs include, but are not limited to electricity, lamps, fixtures, poles, wires, repair crews and vehicles and other items necessary to operate streetlights in the City of Los Angeles.
5. **Balloting Results:** The District will be formed and the assessment in the amount listed on the enclosed ballot will be imposed unless a majority of the ballots are returned opposing the assessment. Ballots are weighted proportionally by each parcel's assessment amount. (\$1 = 1 vote.)



# Proposed Assessment Calculation

The process of determining maintenance assessments for each parcel is based on evaluating three areas relative to the amount of special benefit received. These include the size of the property, the land use, and the type of street lighting system(s) benefiting the property. These factors are evaluated for your property to determine your annual assessment. For more detailed information regarding assessment calculations, please visit us at: [www.lacity.org/bsl](http://www.lacity.org/bsl)

## Questions?

Call (213) 847-1500 or visit the Bureau of Street Lighting website: [www.lacity.org/bsl](http://www.lacity.org/bsl)

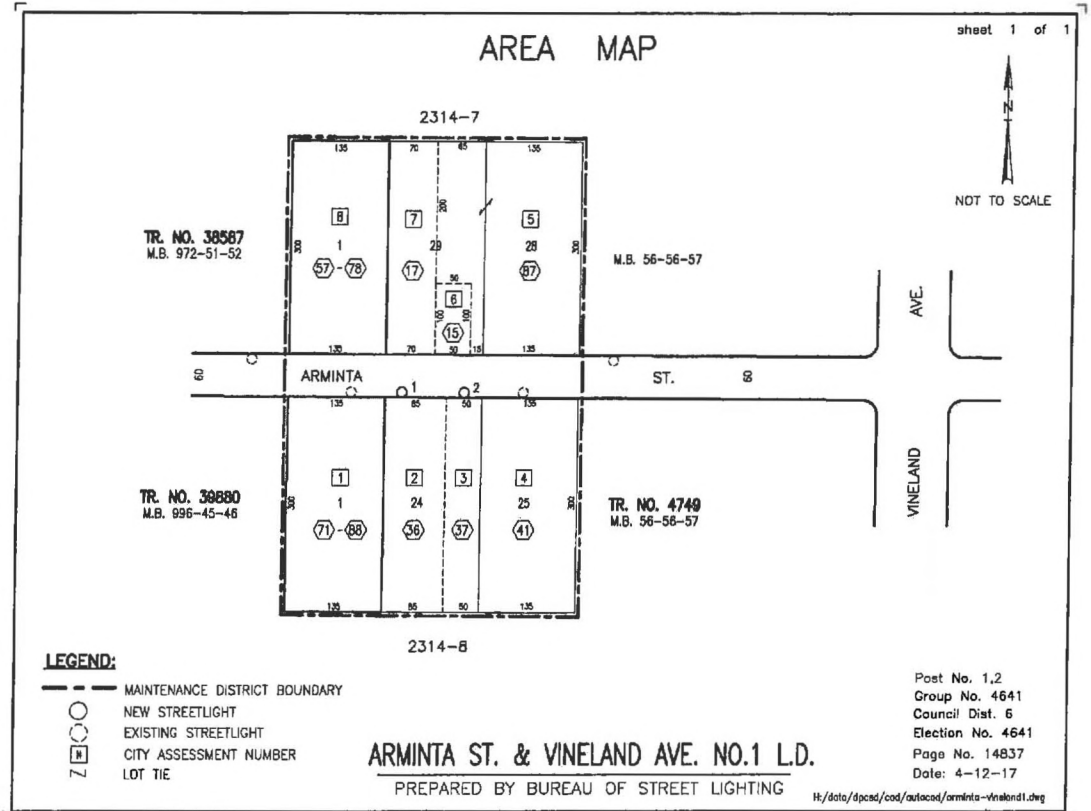

## PROPERTY and ASSESSMENT DETAILS

- Location:
- County APN: 2314-008-071
- Fiscal Year: 2017-18
- Acreage: .9290
- Land Use: CDO
- Dwell Units: 1
- Current Assessment: \$143.28
- Proposed Assessment: \$42.35 \*  
(this equates to about \$3.53 per month)



\* Assessments may be increased annually without further notice or ballot, by no more than the annual Consumer Price Index (CPI) for Los Angeles-Anaheim-Riverside CA, provided by the U.S. Dept. of Labor (Bureau of Labor Statistics). The annual Consumer Price Index (CPI) will be calculated from the calendar year (Jan 1-Dec 31) just prior to the assessment period affected (Jul 1-Jun 30). Current Assessment will be replaced by Proposed Assessment.

City of Los Angeles  
Department of Public Works  
Bureau of Street Lighting





Light installed  
and deenergized

# STREET LIGHTING BALLOT

## DON'T THROW AWAY

This package contains a ballot to determine if the streetlights installed adjacent to your property will be turned on.

The streetlights were turned off due to the failure of a recent ballot. In order to turn these streetlights on near your property, an Assessment District must be created to collect the annual cost from adjacent property owners to operate and maintain the lights. This is your opportunity to vote on whether you want to have streetlights and accept the charge added to your property taxes to pay these costs.

In this packet you will find a blue Notice, a yellow Ballot, and an envelope for mailing the ballot.

### Street Lighting Operation and Maintenance Ballot

This ballot is the most important document in this material.  
It shows the proposed assessment amount for your property.  
Ballots that are not returned, or that are returned late, cannot be counted.

**Please return your ballot!**

### Notice to Property Owners

This Notice provides you with legally required information about the balloting and the assessment. On the back, it explains how your assessment is calculated.

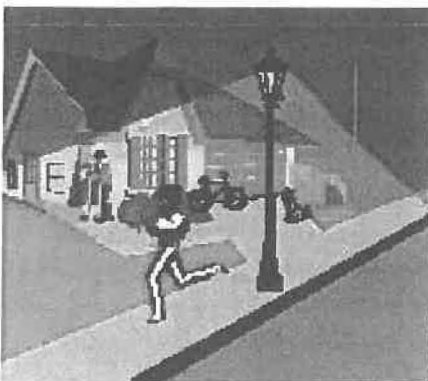

✓ A majority **YES** vote will permit the City to turn the streetlights on.

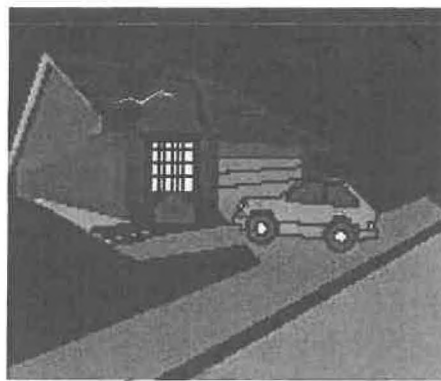

✓ A majority **NO** vote will require the City to **remove the streetlights** adjacent to your property.

City of Los Angeles  
Dept. of Public Works  
Bureau of Street Lighting



**Questions? Problems paying?**  
Call 213 485-8213 or visit the  
Bureau of Street Lighting website.  
<http://www.lacity.org/BSL/index.htm>

As a covered entity under Title II of the Americans with Disabilities Act, the City of Los Angeles does not discriminate on the basis of disability and upon request will provide reasonable accommodation to ensure equal access to its programs, services and activities.

# BALOTA DE ALUMBRADO PUBLICO FAVOR DE NO TIRAR A LA BASURA

Este paquete contiene una balota para determinar si el alumbrado público adyacente a su propiedad será encendido.

El alumbrado público fue apagado debido al fracaso de una reciente votación. Para que el alumbrado público cerca de su propiedad pueda ser encendido nuevamente, un distrito de valoración debe ser creado para coleccionar anualmente de los propietarios la cantidad para la operación y mantenimiento del alumbrado. Esta es su oportunidad para votar si desea que el alumbrado sea encendido y aceptar que los cargos se agregen a los impuestos de su propiedad.

En este paquete usted encontrará un aviso color azul, una balota amarilla, y un sobre para enviar la balota.

## Balota para la Operación y Mantenimiento del Alumbrado Publico

Esta balota es el documento más importante dentro de este material.  
La balota muestra la propuesta cantidad de tasación sobre su propiedad.  
Balotas no regresadas o regresadas tarde, no pueden ser contadas.

**¡Favor de Regresar la Balota!**

## Aviso Para Propietarios

Este aviso suministra información sobre la votación y tasación requerida por la ley. Al reverso, le explica como su tasación es calculada.



- ✓ Una mayoría de votos **"SI"**, permitirá a la Ciudad encender nuevamente el alumbrado público.

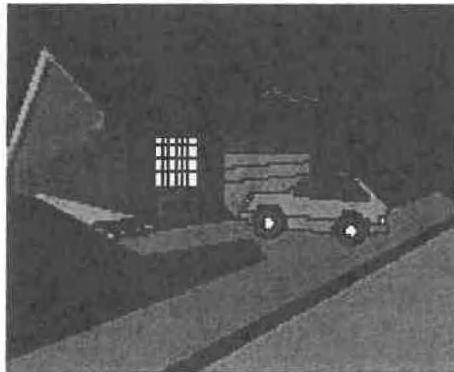

- ✓ Una mayoría de votos **"NO"**, requerirá a la Ciudad **remover** los postes de luz del alumbrado público adyacente a su propiedad.

Ciudad de los Angeles  
Departamento de Obras Públicas  
Buró de Alumbrado Público



**¿Preguntas? ¿No puede pagar?**  
Llame al 213 485-8213 o visite la página de internet del Buró de Alumbrado Público:  
<http://www.lacity.org/BSL/index.html>