

SHEET NOTES	
I	IDENTIFICATION SIGN
P	PROJECTING SIGN
M	MONUMENT SIGN
D	ELECTRONIC MESSAGE DISPLAY SIGN
S	SUPERGRAPHIC
W	WALL SIGN

LIGHTSTONE DTLA LLC
 1248-1260 S. FIGUEROA ST. &
 601 W. PICO BLVD.
 LOS ANGELES, CA 90051

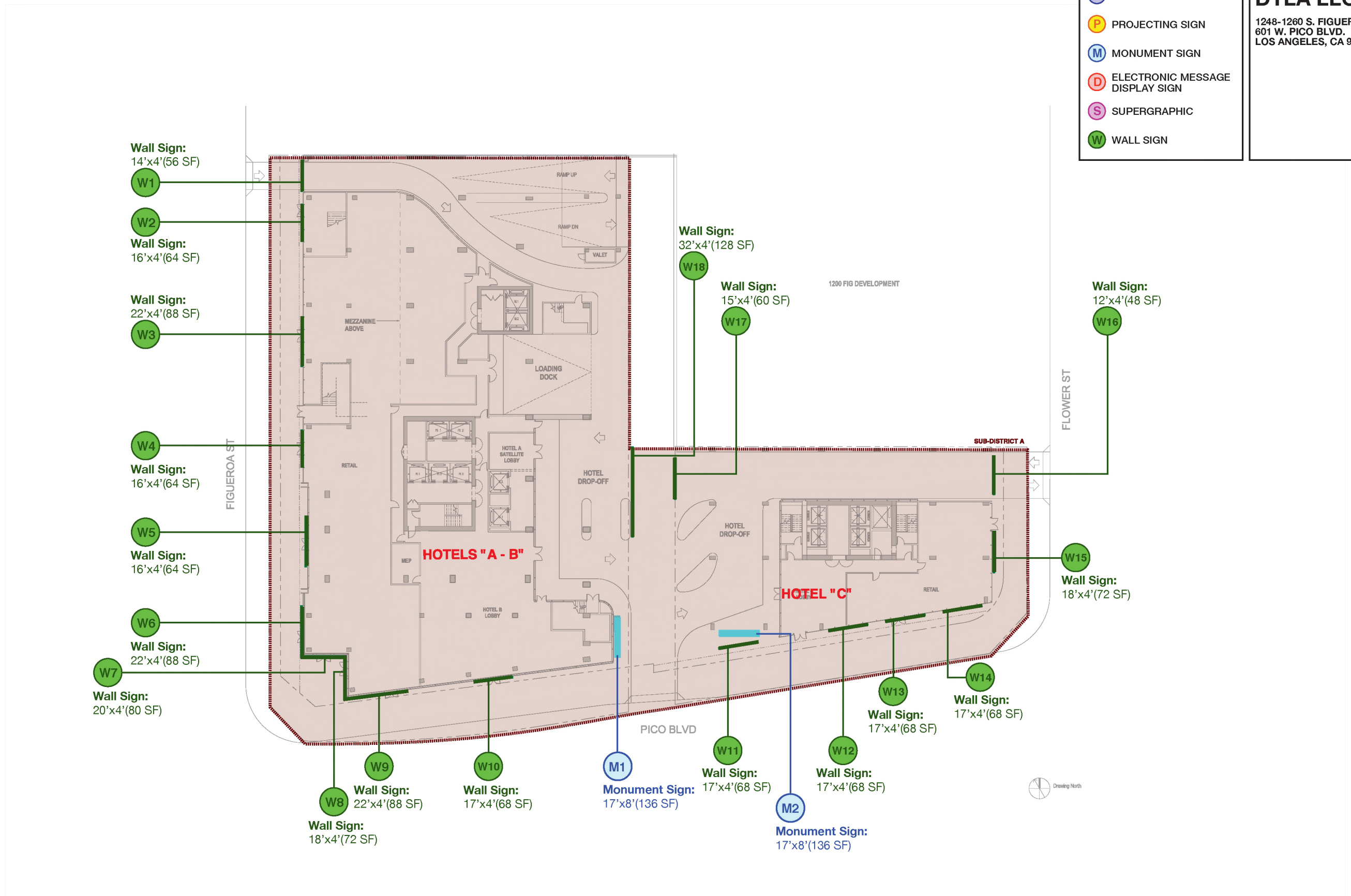

SHEET NOTES	
I	IDENTIFICATION SIGN
P	PROJECTING SIGN
M	MONUMENT SIGN
D	ELECTRONIC MESSAGE DISPLAY SIGN
S	SUPERGRAPHIC
W	WALL SIGN

LIGHTSTONE DTLA LLC	
1248-1260 S. FIGUEROA ST. & 601 W. PICO BLVD. LOS ANGELES, CA 90051	

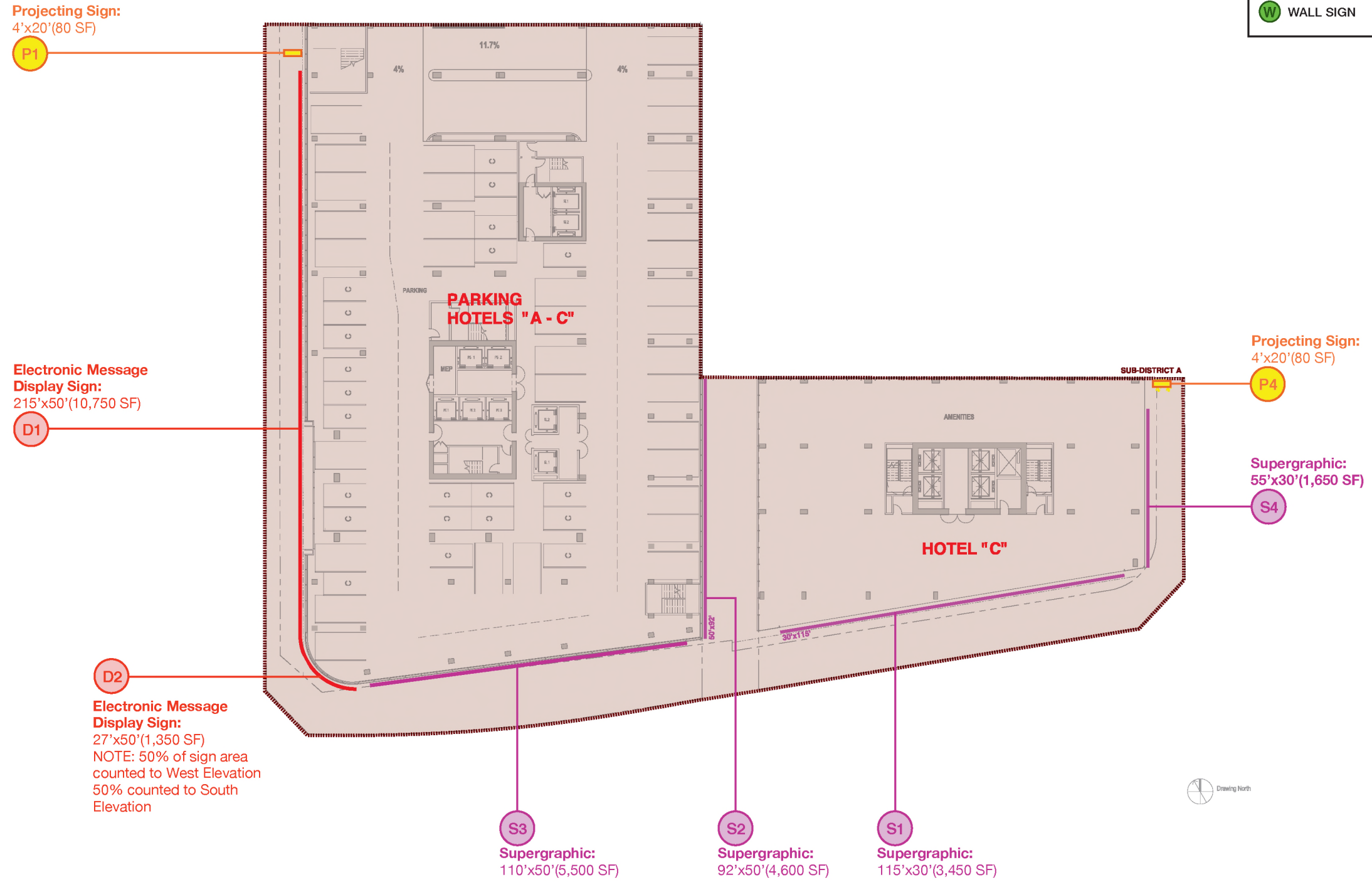

- SHEET NOTES**
- I IDENTIFICATION SIGN
 - P PROJECTING SIGN
 - M MONUMENT SIGN
 - D ELECTRONIC MESSAGE DISPLAY SIGN
 - S SUPERGRAPHIC
 - W WALL SIGN

**LIGHTSTONE
DTLA LLC**
 1248-1260 S. FIGUEROA ST. &
 601 W. PICO BLVD.
 LOS ANGELES, CA 90051

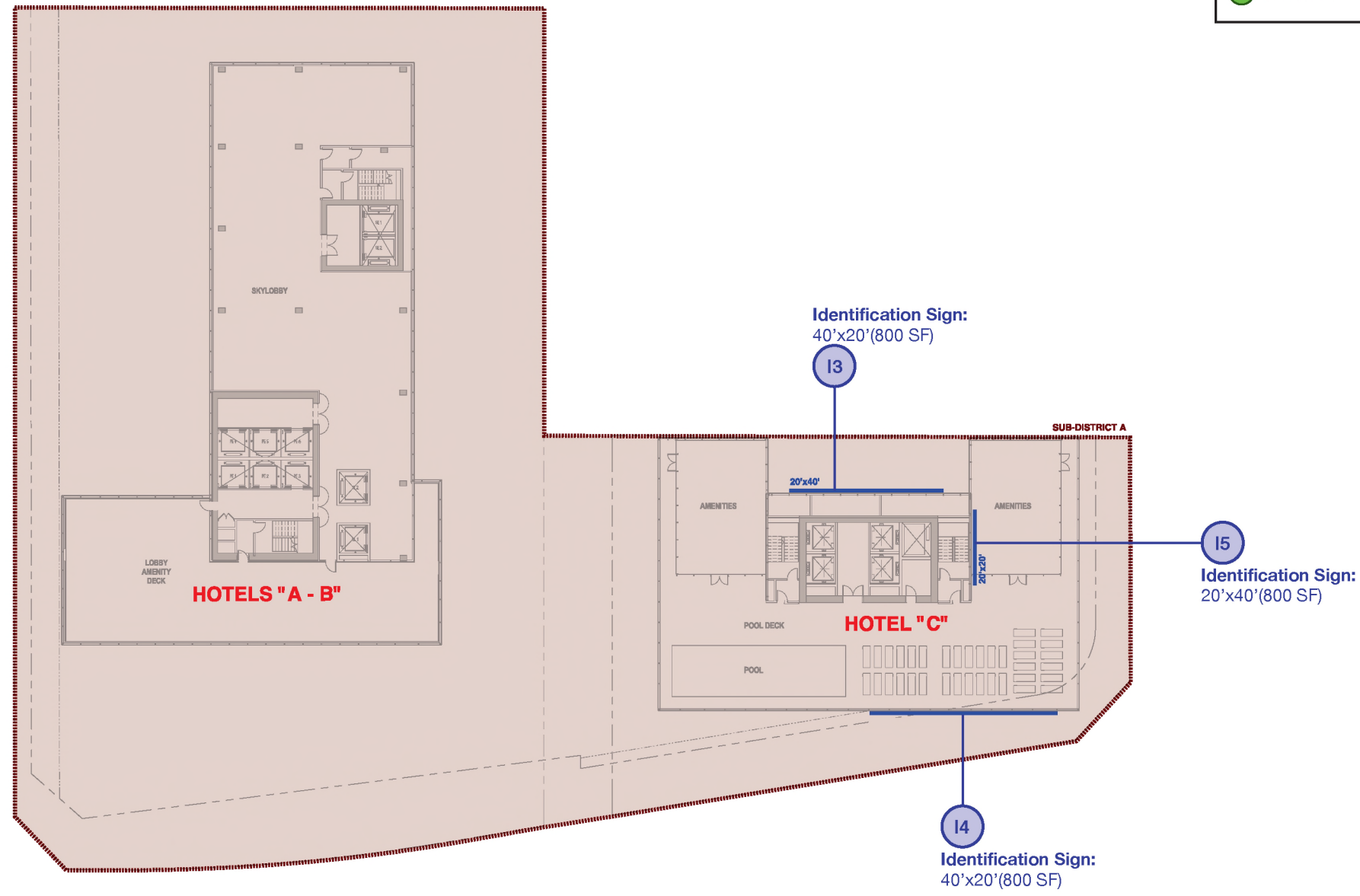

SHEET NOTES	
I	IDENTIFICATION SIGN
P	PROJECTING SIGN
M	MONUMENT SIGN
D	ELECTRONIC MESSAGE DISPLAY SIGN
S	SUPERGRAPHIC
W	WALL SIGN

LIGHTSTONE DTLA LLC
 1248-1260 S. FIGUEROA ST. &
 601 W. PICO BLVD.
 LOS ANGELES, CA 90051

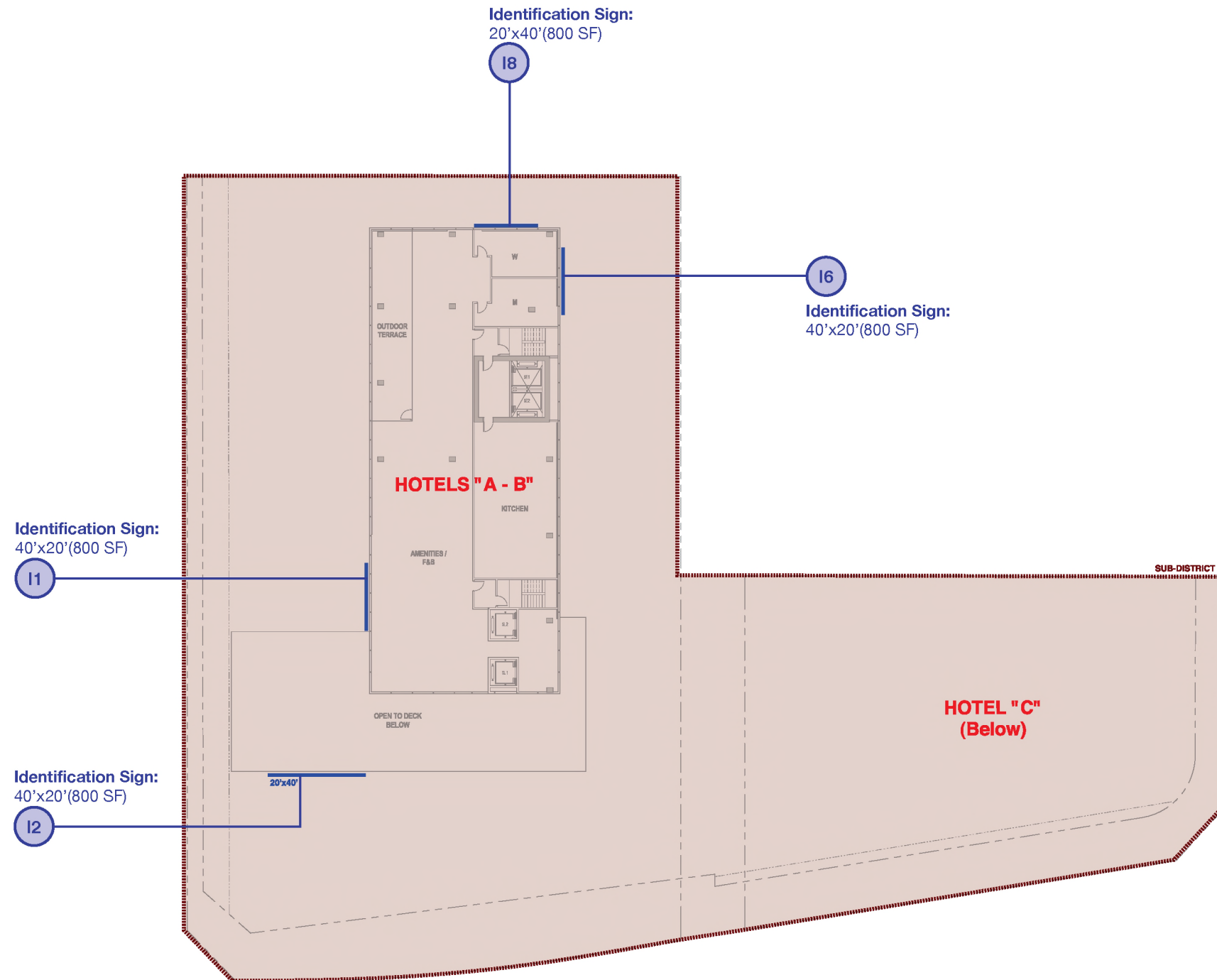

SHEET NOTES	
I	IDENTIFICATION SIGN
P	PROJECTING SIGN
M	MONUMENT SIGN
D	ELECTRONIC MESSAGE DISPLAY SIGN
S	SUPERGRAPHIC
W	WALL SIGN

LIGHTSTONE DTLA LLC
 1248-1260 S. FIGUEROA ST. &
 601 W. PICO BLVD.
 LOS ANGELES, CA 90051

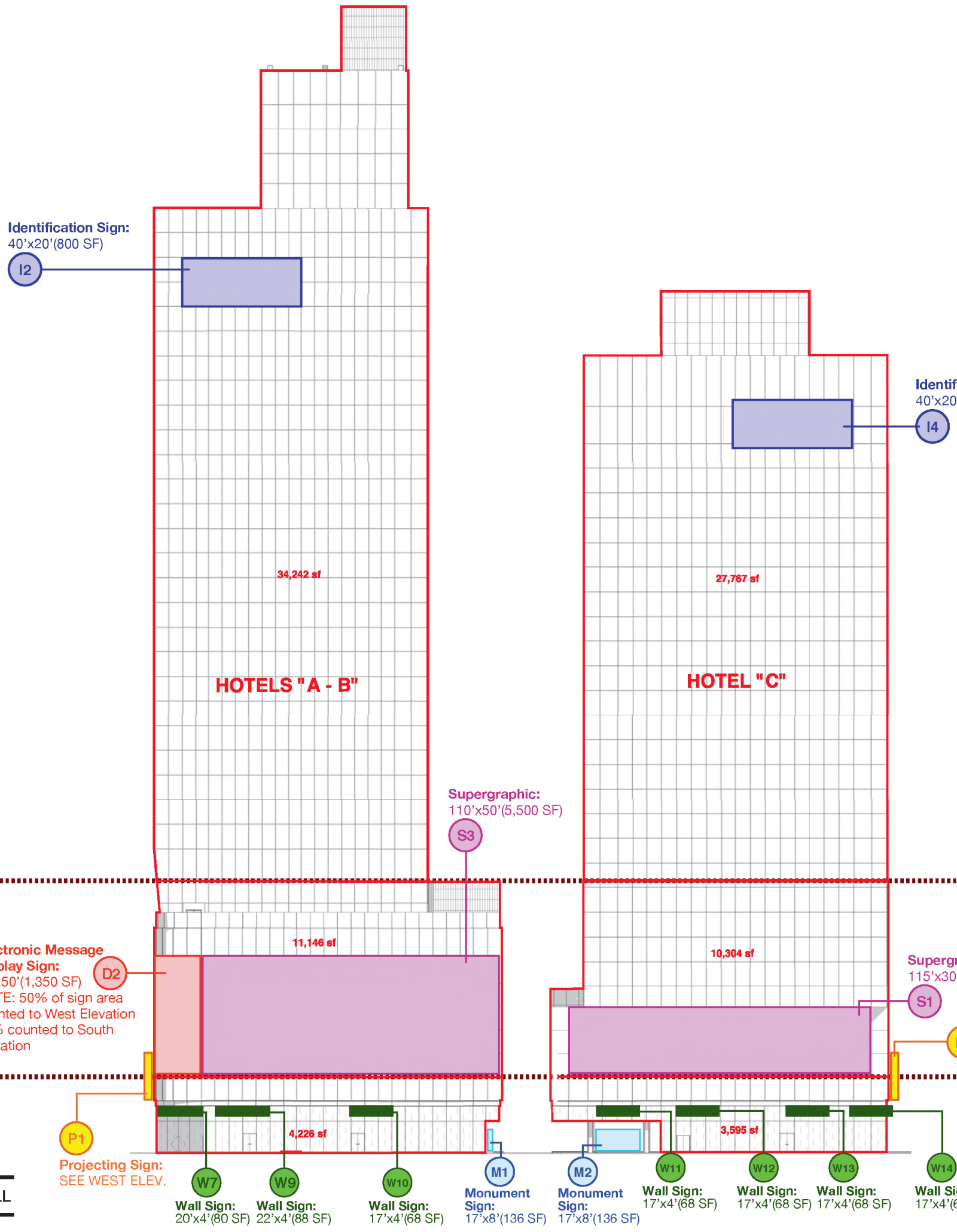

SIGN ZONE 3: 100'-ROOF
 TOTAL FACADE AREA: 34,242 SF
 ILLUSTRATED SIGN AREA: 800 SF
 (2% Percent of facade area)

SIGN ZONE 3: 100'-ROOF
 TOTAL FACADE AREA: 27,767 SF
 ILLUSTRATED SIGN AREA: 800 SF
 (3% Percent of facade area)

SIGN ZONE 2: 35'-100'
 TOTAL FACADE AREA: 11,146 SF
 ILLUSTRATED SIGN AREA: 6,175 SF
 (55% Percent of facade area)

SIGN ZONE 2: 35'-100'
 TOTAL FACADE AREA: 10,304 SF
 ILLUSTRATED SIGN AREA: 3,450 SF
 (33% Percent of facade area)

SIGN ZONE 1: 0'-35'
 TOTAL FACADE AREA: 4,226 SF
 ILLUSTRATED SIGN AREA: 372 SF
 (8% Percent of facade area)

SIGN ZONE 1: 0'-35'
 TOTAL FACADE AREA: 3,595 SF
 ILLUSTRATED SIGN AREA: 408 SF
 (11% Percent of facade area)

1 SIGNAGE ELEVATION - SOUTH OVERALL

- P1** Projecting Sign: SEE WEST ELEV.
- W7** Wall Sign: 20'x4'(60 SF)
- W9** Wall Sign: 22'x4'(88 SF)
- W10** Wall Sign: 17'x4'(68 SF)
- M1** Monument Sign: 17'x8'(136 SF)
- M2** Monument Sign: 17'x8'(136 SF)
- W11** Wall Sign: 17'x4'(68 SF)
- W12** Wall Sign: 17'x4'(68 SF)
- W13** Wall Sign: 17'x4'(68 SF)
- W14** Wall Sign: 17'x4'(68 SF)

SHEET NOTES		LIGHTSTONE DTLA LLC 1248-1260 S. FIGUEROA ST. & 601 W. PICO BLVD. LOS ANGELES, CA 90051
I	IDENTIFICATION SIGN	
P	PROJECTING SIGN	
M	MONUMENT SIGN	
D	ELECTRONIC MESSAGE DISPLAY SIGN	
S	SUPERGRAPHIC	
W	WALL SIGN	

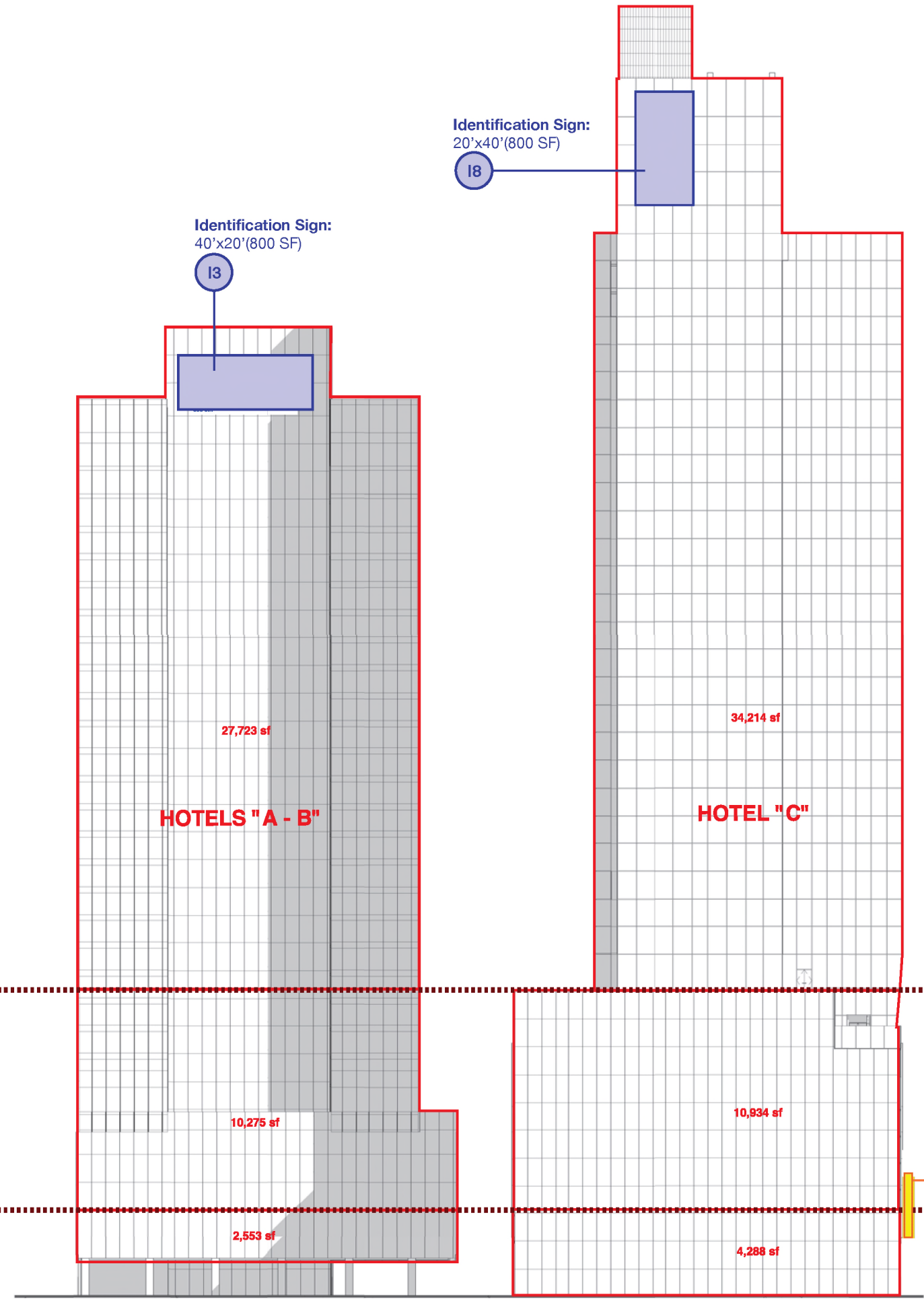

SIGN ZONE 3: 100'-ROOF
TOTAL FACADE AREA: 27,723 SF
ILLUSTRATED SIGN AREA: 800 SF
(2% Percent of facade area)

SIGN ZONE 3: 100'-ROOF
TOTAL FACADE AREA: 34,214 SF
ILLUSTRATED SIGN AREA: 800 SF
(2% Percent of facade area)

SIGN ZONE 2: 35'-100'
TOTAL FACADE AREA: 10,275 SF
ILLUSTRATED SIGN AREA: 0 SF

SIGN ZONE 2: 35'-100'
TOTAL FACADE AREA: 10,934 SF
ILLUSTRATED SIGN AREA: 0 SF

SIGN ZONE 1: 0'-35'
TOTAL FACADE AREA: 2,553 SF
ILLUSTRATED SIGN AREA: 0 SF

SIGN ZONE 1: 0'-35'
TOTAL FACADE AREA: 4,288 SF
ILLUSTRATED SIGN AREA: 0 SF

1 SIGNAGE ELEVATION - NORTH OVERALL

SHEET NOTES	
I	IDENTIFICATION SIGN
P	PROJECTING SIGN
M	MONUMENT SIGN
D	ELECTRONIC MESSAGE DISPLAY SIGN
S	SUPERGRAPHIC
W	WALL SIGN

LIGHTSTONE DTLA LLC
 1248-1260 S. FIGUEROA ST. &
 601 W. PICO BLVD.
 LOS ANGELES, CA 90051

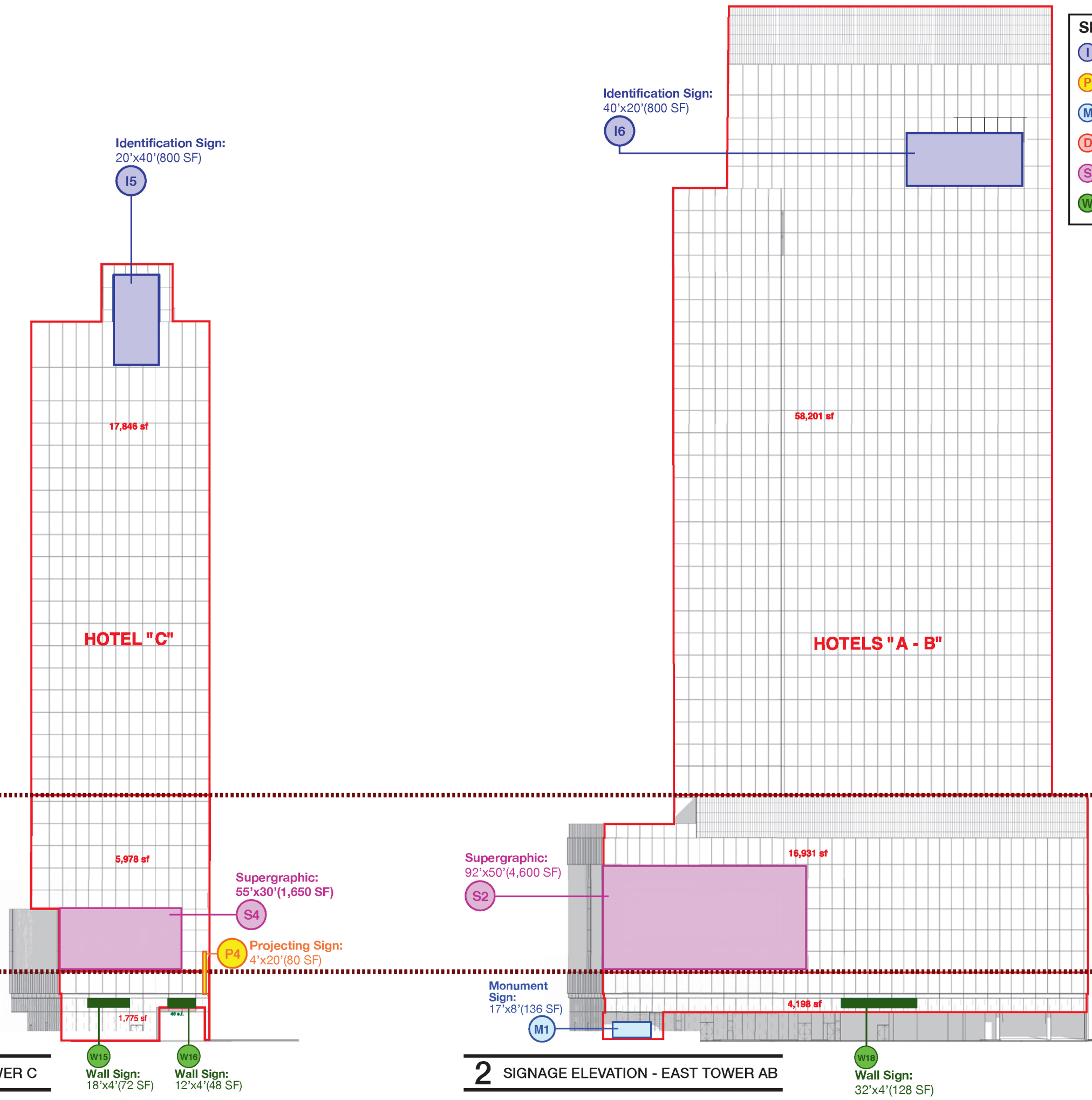

SIGN ZONE 3: 100'-ROOF
 TOTAL FACADE AREA: 17,846 SF
 ILLUSTRATED SIGN AREA: 800 SF
 (4% Percent of facade area)

SIGN ZONE 3: 100'-ROOF
 TOTAL FACADE AREA: 58,201 SF
 ILLUSTRATED SIGN AREA: 800 SF
 (1% Percent of facade area)

SIGN ZONE 2: 35'-100'
 TOTAL FACADE AREA: 5,978 SF
 ILLUSTRATED SIGN AREA: 1,694 SF
 (28% Percent of facade area)

SIGN ZONE 2: 35'-100'
 TOTAL FACADE AREA: 16,931 SF
 ILLUSTRATED SIGN AREA: 4,600 SF
 (27% Percent of facade area)

SIGN ZONE 1: 0'-35'
 TOTAL FACADE AREA: 1,775 SF
 ILLUSTRATED SIGN AREA: 156 SF
 (8% Percent of facade area)

SIGN ZONE 1: 0'-35'
 TOTAL FACADE AREA: 4,198 SF
 ILLUSTRATED SIGN AREA: 264 SF
 (6% Percent of facade area)

1 SIGNAGE ELEVATION - EAST TOWER C

W15 Wall Sign: 18'x4'(72 SF)
 W16 Wall Sign: 12'x4'(48 SF)

2 SIGNAGE ELEVATION - EAST TOWER AB

W18 Wall Sign: 32'x4'(128 SF)

SHEET NOTES	
I	IDENTIFICATION SIGN
P	PROJECTING SIGN
M	MONUMENT SIGN
D	ELECTRONIC MESSAGE DISPLAY SIGN
S	SUPERGRAPHIC
W	WALL SIGN

LIGHTSTONE DTLA LLC	
1248-1260 S. FIGUEROA ST. & 601 W. PICO BLVD. LOS ANGELES, CA 90051	

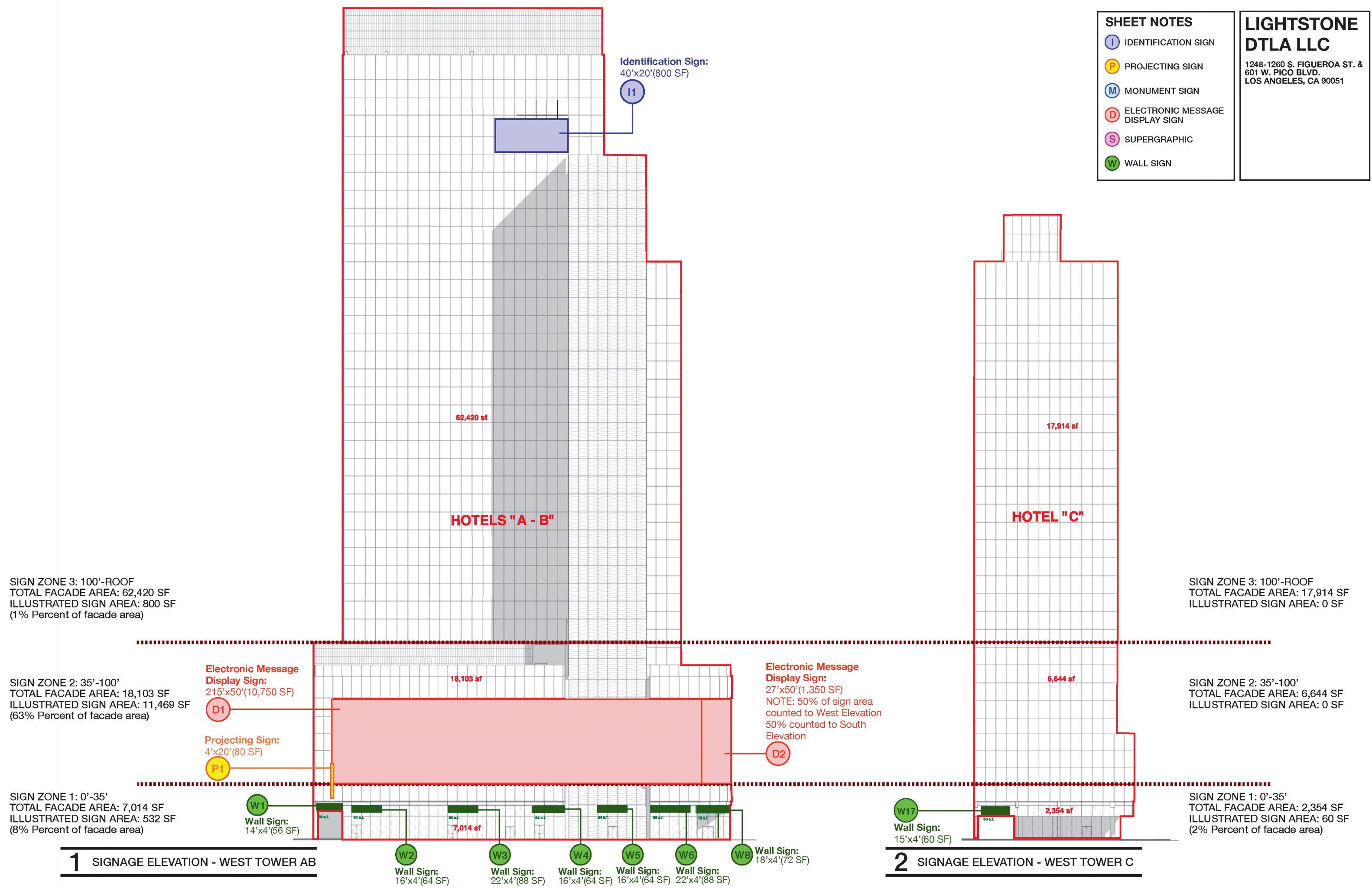

SIGN ZONE 3: 100'-ROOF
 TOTAL FACADE AREA: 62,420 SF
 ILLUSTRATED SIGN AREA: 800 SF
 (1% Percent of facade area)

SIGN ZONE 2: 35'-100'
 TOTAL FACADE AREA: 18,103 SF
 ILLUSTRATED SIGN AREA: 11,469 SF
 (63% Percent of facade area)

SIGN ZONE 1: 0'-35'
 TOTAL FACADE AREA: 7,014 SF
 ILLUSTRATED SIGN AREA: 532 SF
 (8% Percent of facade area)

SIGN ZONE 3: 100'-ROOF
 TOTAL FACADE AREA: 17,914 SF
 ILLUSTRATED SIGN AREA: 0 SF

SIGN ZONE 2: 35'-100'
 TOTAL FACADE AREA: 6,644 SF
 ILLUSTRATED SIGN AREA: 0 SF

SIGN ZONE 1: 0'-35'
 TOTAL FACADE AREA: 2,354 SF
 ILLUSTRATED SIGN AREA: 60 SF
 (2% Percent of facade area)

1 SIGNAGE ELEVATION - WEST TOWER AB

2 SIGNAGE ELEVATION - WEST TOWER C

- W2**
Wall Sign:
16'x4'(64 SF)
- W3**
Wall Sign:
22'x4'(88 SF)
- W4**
Wall Sign:
16'x4'(64 SF)
- W5**
Wall Sign:
16'x4'(64 SF)
- W6**
Wall Sign:
22'x4'(88 SF)
- W8**
Wall Sign:
18'x4'(72 SF)

NORTH ELEVATION

SIGN	SIGN AREA (sq. ft.)
I8	800
TOTAL	800

SOUTH ELEVATION

SIGN	SIGN AREA (sq. ft.)
D2	675
I2	800
M1	136
S3	5,500
W7	80
W9	88
W10	68
TOTAL	7,347

EAST ELEVATION

SIGN	SIGN AREA (sq. ft.)
I6	800
S2	4,600
W18	128
TOTAL	5,528

WEST ELEVATION

SIGN	SIGN AREA (sq. ft.)
D1	10,750
D2	675
I1	800
P1	80
W1	56
W2	64
W3	88
W4	64
W5	64
W6	88
W8	72
TOTAL	12,801

HOTELS "A and B" TOTAL SIGN AREA

TOTAL	26,476 SQUARE FEET
--------------	---------------------------

NOTES:

A sign located at a project corner (Sign D2) is counted 50% towards each elevation

Projecting Sign P1 is located in Sign Zones 1 and 2 (36 SF in Sign Zone 1 and 44 SF in Sign Zone 2)

<p>LIGHTSTONE DTLA LLC 1248-1260 S. FIGUEROA ST. & 601 W. PICO BLVD. LOS ANGELES, CA 90051</p>

HOTELS A and B

Sign Area Totals

NORTH ELEVATION

SIGN	SIGN AREA (sq. ft.)
I3	800
TOTAL	800

SOUTH ELEVATION

SIGN	SIGN AREA (sq. ft.)
I4	800
M2	136
S1	3,450
W11	68
W12	68
W13	68
W14	68
TOTAL	4,658

EAST ELEVATION

SIGN	SIGN AREA (sq. ft.)
S4	1,650
I5	800
P4	80
W15	72
W16	48
TOTAL	2,650

WEST ELEVATION

SIGN	SIGN AREA (sq. ft.)
W17	60
TOTAL	60

HOTEL "C" TOTAL SIGN AREA

TOTAL	8,168 SQUARE FEET
--------------	--------------------------

NOTES:

Projecting Sign P4 is located in Sign Zones 1 and 2 (36 SF in Sign Zone 1 and 44 SF in Sign Zone 2)

**LIGHTSTONE
DTLA LLC**

1248-1260 S. FIGUEROA ST. &
601 W. PICO BLVD.
LOS ANGELES, CA 90051

HOTEL C**Sign Area Totals**