

Communication from Public

Name: Concerned Resident
Date Submitted: 08/06/2019 07:32 PM
Council File No: 18-0619

Comments for Public Posting: To the Public Works and Gang Reduction Committee Members and whom it may concern: I am a resident who lives adjacent to 3300 block of Woodbine Street, across the street from the proposed gate (3200 Block of Woodbine). I oppose the proposed gate for the following reasons: In his motion Mr. Koretz cited a litany of public safety concerns: “Arson to cars and adjacent foliage; Vagrant RV parking on Manning Avenue; Persons rummaging through trash cans, littering the roadway, and yelling obscenities; Vehicles “keyed” by persons using the walkway from Manning Avenue; Home burglaries; Observed drug use; Public urination and defecation; Vehicle theft; and, Items stolen from vehicles.” I direct your attention to the attached crime data (Mayor’s Open Data) for RD 0895/Woodbine, 2010-present. Please note that there are no crime reports associated with narcotics or arson. There are 36 reported crime for 3200 and 3300 blocks of Woodbine and almost evenly divided. Of the 16 reported crime in 3200 block of Woodbine, 2 are identity theft and one is a lewd phone call and the rest are property crimes and vandalism. The only reported crime in 2019 for 3200 block of Woodbine is for chipped paint as a result of the resident removing a sign that was posted on their fence and the Senior Lead Officer took the report and classified it as Felony Vandalism (?). The yearly average for property crime is 1.60 for this area. I direct your attention to the attached crime data (Mayor’s Open Data) for RD 0895/Edith, 2012-present. On October 6, 2015, Mr. Koretz introduced a motion and proposed a temporary gate for public walkway at Edith cul-de-sac, citing a litany of public safety concerns, including: “Arson to cars and adjacent foliage; Vagrant RV parking on Manning Avenue; Persons rummaging through trash cans and littering roadway, and yelling obscenities; Vehicles “keyed” by persons using the walkways from Manning Avenue; Home burglaries; Observed drug use; Public urination and defecation; Vehicle theft; and, Items stolen from vehicles” Please note that there were no reported crimes in 2015 for Edith cul-de-sac. From 2012-2014 there were 6 reported property crimes. There were no crime reports associated with arson or narcotics. On November 22, 2016, City Council, adopted the resolution and the Edith gate was installed in a shroud of secrecy and it seems that it was never meant to be a temporary gate. There

have been same number of reported crime since the installation as before. The yearly average for crime is 2.1 for this area. Why didn't the Edith gate reduce the crime rate? The reason is (Attached-Access Map), that there are other access points to these cul-de-sacs. The only purpose these gates serve is that they make these cul-de-sacs exclusive and deny the surrounding residents access to public streets. Please note that the 3300 block of Woodbine has the same crime statistics, and so does the entire West LA Division. Please do not let a handful of residents use the same tired crime excuse to violate our rights to walk on a public street. We need to find long term solutions to quality of life issues rather than what is being proposed to satisfy personal agenda. Thank you for your consideration.

DR_NO	Date Rptd	DATE OCC	TIME OCC	AREA	AREA NAME	Rpt Dist No	Crsm Cd	Crsm Cd Desc	LOCATION	Cross Street		
100808925	4/29/2010 0:00	4/24/2010 0:00	10	8	West LA	895	440	THEFT PLAIN - PETTY (\$950 & UNDER)	3200 WOODBINE	ST		
100813429	8/1/2010 0:00	7/30/2010 0:00	930	8	West LA	895	420	THEFT FROM MOTOR VEHICLE - PETTY (\$950 & UNDER)	3200 WOODBINE	ST		
110814618	8/26/2011 0:00	8/25/2011 0:00	1930	8	West LA	895	330	BURGLARY FROM VEHICLE	3200 WOODBINE	ST		
110815488	9/14/2011 0:00	9/10/2011 0:00	900	8	West LA	895	440	THEFT PLAIN - PETTY (\$950 & UNDER)	3200 WOODBINE	ST		
130807380	3/25/2013 0:00	3/25/2013 0:00	1630	8	West LA	895	310	BURGLARY	3200 WOODBINE	ST		
130807937	4/7/2013 0:00	4/6/2013 0:00	2300	8	West LA	895	740	VANDALISM - FELONY (\$400 & OVER, ALL CHURCH VANDALISMS)	3200 WOODBINE	ST		
130808714	4/27/2013 0:00	4/26/2013 0:00	2040	8	West LA	895	740	VANDALISM - FELONY (\$400 & OVER, ALL CHURCH VANDALISMS)	3200 WOODBINE	ST		
130810799	6/19/2013 0:00	6/19/2013 0:00	1400	8	West LA	895	310	BURGLARY	3200 WOODBINE	ST		
140812201	8/11/2014 0:00	8/6/2014 0:00	1100	8	West LA	895	440	THEFT PLAIN - PETTY (\$950 & UNDER)	3200 WOODBINE	ST		
160815135	8/28/2016 0:00	8/28/2016 0:00	1030	8	West LA	895	956	LETTERS, LEWD - TELEPHONE CALLS, LEWD	3200 WOODBINE	ST		
170813106	7/21/2017 0:00	7/4/2017 0:00	5	8	West LA	895	354	THEFT OF IDENTITY	3200 WOODBINE	ST		
170816895	10/13/2017 0:00	10/12/2017 0:00	855	8	West LA	895	354	THEFT OF IDENTITY	3200 WOODBINE	ST		
180812634	7/2/2018 0:00	4/3/2018 0:00	2000	8	West LA	895	330	BURGLARY FROM VEHICLE	3200 WOODBINE	ST		
180809551	4/27/2018 0:00	4/26/2018 0:00	1730	8	West LA	895	310	BURGLARY	3200 WOODBINE	ST		
180809698	5/1/2018 0:00	4/30/2018 0:00	1500	8	West LA	895	510	VEHICLE - STOLEN	3200 WOODBINE	ST		
180817769	10/16/2018 0:00	10/16/2018 0:00	140	8	West LA	895	310	BURGLARY	3200 WOODBINE	ST		
190809283	5/2/2019 0:00	5/1/2019 0:00	745	8	West LA	895	740	VANDALISM - FELONY (\$400 & OVER, ALL CHURCH VANDALISMS)	3200 WOODBINE	ST		
110806497	2/27/2011 0:00	2/15/2011 0:00	2200	8	West LA	895	330	BURGLARY FROM VEHICLE	3300 WOODBINE	ST		
110809484	5/5/2011 0:00	5/4/2011 0:00	2215	8	West LA	895	420	THEFT FROM MOTOR VEHICLE - PETTY (\$950 & UNDER)	3300 WOODBINE	ST		
110819250	12/11/2011 0:00	12/9/2011 0:00	1130	8	West LA	895	510	VEHICLE - STOLEN	3300 WOODBINE	ST		
130813419	8/27/2013 0:00	9/16/2012 0:00	1200	8	West LA	895	354	THEFT OF IDENTITY	3300 WOODBINE	ST		
130807806	4/4/2013 0:00	4/2/2013 0:00	1730	8	West LA	895	330	BURGLARY FROM VEHICLE	3300 WOODBINE	ST		
150809974	5/25/2015 0:00	5/7/2015 0:00	2000	8	West LA	895	740	VANDALISM - FELONY (\$400 & OVER, ALL CHURCH VANDALISMS)	3300 WOODBINE	ST		
150814245	8/29/2015 0:00	8/24/2015 0:00	1700	8	West LA	895	956	LETTERS, LEWD - TELEPHONE CALLS, LEWD	3300 WOODBINE	ST		
150817831	11/20/2015 0:00	11/19/2015 0:00	1600	8	West LA	895	745	VANDALISM - MISDEAMEANOR (\$399 OR UNDER)	3300 WOODBINE	ST		
160813114	7/16/2016 0:00	7/13/2016 0:00	1200	8	West LA	895	330	BURGLARY FROM VEHICLE	3300 WOODBINE	ST		
170810265	5/17/2017 0:00	5/17/2017 0:00	1010	8	West LA	895	320	BURGLARY, ATTEMPTED	3300 WOODBINE	ST		
170817746	10/31/2017 0:00	10/28/2017 0:00	1800	8	West LA	895	310	BURGLARY	3300 WOODBINE	ST		
170820283	12/27/2017 0:00	12/20/2017 0:00	2200	8	West LA	895	331	THEFT FROM MOTOR VEHICLE - GRAND (\$400 AND OVER)	3300 WOODBINE	ST		
180804234	1/6/2018 0:00	12/29/2017 0:00	1600	8	West LA	895	330	BURGLARY FROM VEHICLE	3300 WOODBINE	ST		
180810186	5/10/2018 0:00	5/9/2018 0:00	1630	8	West LA	895	510	VEHICLE - STOLEN	3300 WOODBINE	ST		
180818413	10/28/2018 0:00	10/27/2018 0:00	1900	8	West LA	895	420	THEFT FROM MOTOR VEHICLE - PETTY (\$950 & UNDER)	3300 WOODBINE	ST		
180818723	11/2/2018 0:00	10/30/2018 0:00	2000	8	West LA	895	310	BURGLARY	3300 WOODBINE	ST		
130814623	9/26/2013 0:00	9/25/2013 0:00	1425	8	West LA	895	745	VANDALISM - MISDEAMEANOR (\$399 OR UNDER)	WOODBINE			
130813456	8/27/2013 0:00	8/27/2013 0:00	330	8	West LA	895	330	BURGLARY FROM VEHICLE	WOODBINE	ST		
180815473	8/31/2018 0:00	8/6/2018 0:00	1800	8	West LA	895	420	THEFT FROM MOTOR VEHICLE - PETTY (\$950 & UNDER)	WOODBINE	ST		
										MANNING		
										ST	MANNING	AV
										ST	LOVELANE	PL

DR_NO	Date Rptd	DATE OCC	TIME OCC	AREA	AREA NAME	Rpt Dist No	Crn Cd	Crn Cd Desc	LOCATION	Cross Street
120814354	9/5/2012 0:00	9/5/2012 0:00	1000	8	West LA	895	420	THEFT FROM MOTOR VEHICLE - PETTY (\$950 & UNDER)	EDITH	MANNING
120816089	10/18/2012 0:00	10/17/2012 0:00	2000	8	West LA	895	740	VANDALISM - FELONY (\$400 & OVER, ALL CHURCH VANDALISMS)	3200 EDITH	ST
120816091	10/18/2012 0:00	10/17/2012 0:00	2000	8	West LA	895	745	VANDALISM - MISDEAMEANOR (\$399 OR UNDER)	3200 EDITH	ST
140811296	7/16/2014 0:00	6/29/2014 0:00	1500	8	West LA	895	330	BURGLARY FROM VEHICLE	3300 EDITH	ST
140811658	7/27/2014 0:00	7/24/2014 0:00	30	8	West LA	895	341	THEFT-GRAND (\$950.01 & OVER)EXCPT,GUNS,FOWL,LIVESTK,PROD	3200 EDITH	ST
140814635	10/10/2014 0:00	8/1/2014 0:00	800	8	West LA	895	341	THEFT-GRAND (\$950.01 & OVER)EXCPT,GUNS,FOWL,LIVESTK,PROD	3200 EDITH	ST
160810462	5/18/2016 0:00	5/12/2016 0:00	1345	8	West LA	895	480	BIKE - STOLEN	3200 EDITH	ST
170810262	5/17/2017 0:00	5/17/2017 0:00	1020	8	West LA	895	310	BURGLARY	3200 EDITH	ST
170810938	5/29/2017 0:00	5/29/2017 0:00	1200	8	West LA	895	310	BURGLARY	3200 EDITH	ST
180804524	1/13/2018 0:00	1/13/2018 0:00	350	8	West LA	895	420	THEFT FROM MOTOR VEHICLE - PETTY (\$950 & UNDER)	3200 EDITH	ST
180807648	3/20/2018 0:00	3/20/2018 0:00	1245	8	West LA	895	647	THROWING OBJECT AT MOVING VEHICLE	EDITH	MANNING
180813880	7/27/2018 0:00	7/27/2018 0:00	1900	8	West LA	895	310	BURGLARY	3200 EDITH	ST
190809912	5/6/2019 0:00	5/4/2019 0:00	2300	8	West LA	895	330	BURGLARY FROM VEHICLE	3200 EDITH	ST

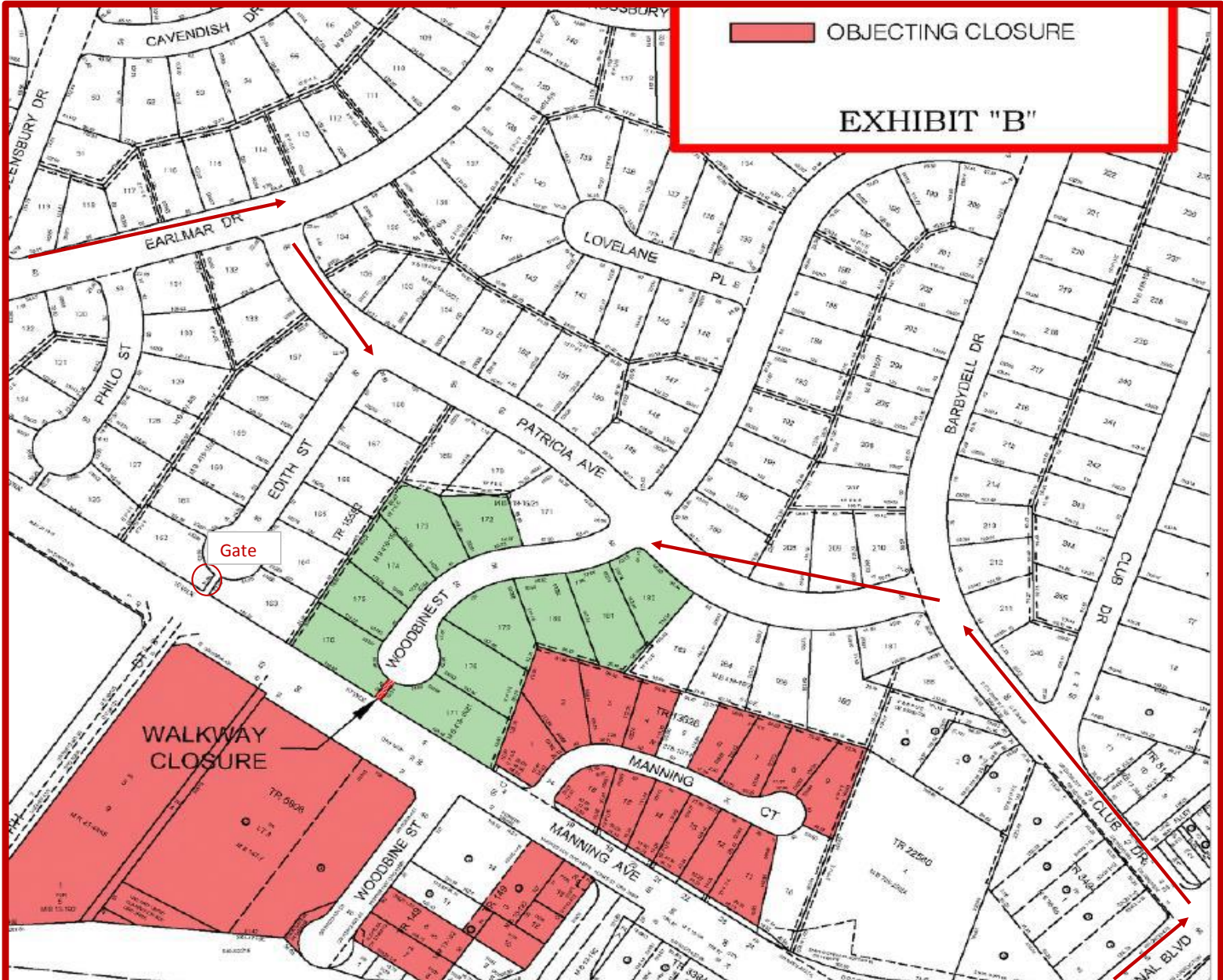

OBJECTING CLOSURE

EXHIBIT "B"

Gate

WALKWAY CLOSURE

