



**CITY OF LOS ANGELES**  
**BUREAU OF ENGINEERING**  
**LAND DEVELOPMENT & GIS DIVISION**  
TITLE: CLOSURE OF CUL-DE-SAC  
WALKWAY AT WOODBINE ST  
NORTHEASTERLY OF MANNING  
AVE



-  PROPOSED CLOSURE AREA
-  SUPPORTING CLOSURE
-  OBJECTING CLOSURE

**EXHIBIT "B"**

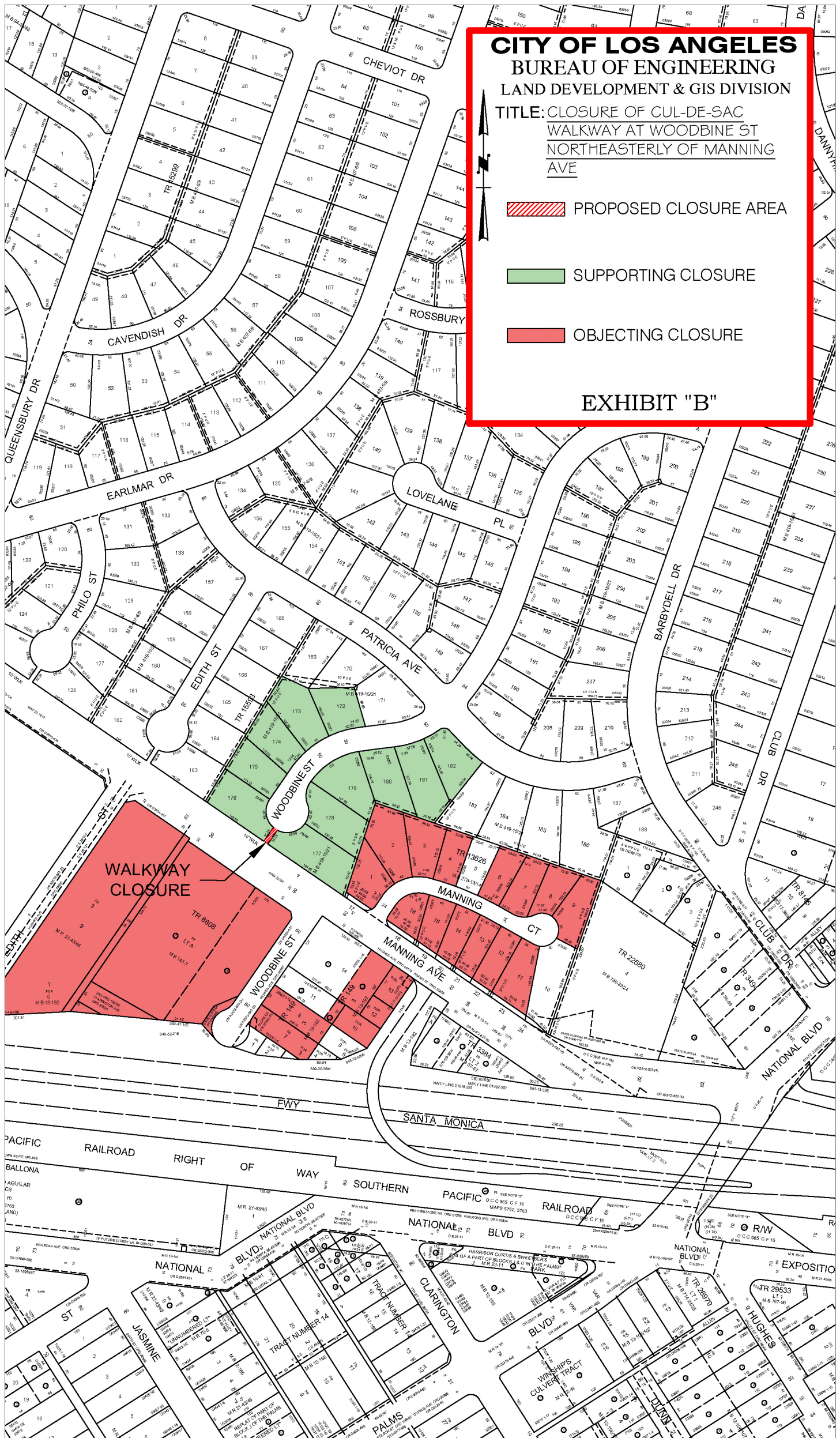

WALKWAY  
CLOSURE