

**RESOLUTION**

**WHEREAS**, the articulated objectives and policies of the Southeast Los Angeles Community Plan, which was revised in March 2000, includes policies to promote safe, high quality residential uses to serve all demographics of the community; and

**WHEREAS**, a General Plan Amendment has been requested for properties within the Jordan Downs Urban Village Specific Plan; and

**WHEREAS**, the Housing Element, a portion of the General Plan for the City of Los Angeles, contains policies and goals for the production of increased housing stock that may be directed to families and individuals across a wide demographic, ensuring stable and safe neighborhoods, and promoting home ownership; and

**WHEREAS**, the City Planning Commission conducted a public hearing on April 14, 2016 and subsequently recommended approval of the General Plan Amendments to the Southeast Los Angeles Community Plan and presented their findings to the City Council.

**WHEREAS**, the requested General Plan Amendment is consistent in conformity with public necessity, convenience, general welfare and good zoning practice; and

**NOW, THEREFORE, BE IT RESOLVED** that Southeast Los Angeles Community Plan be amended as shown on the attached General Plan Amendment map.

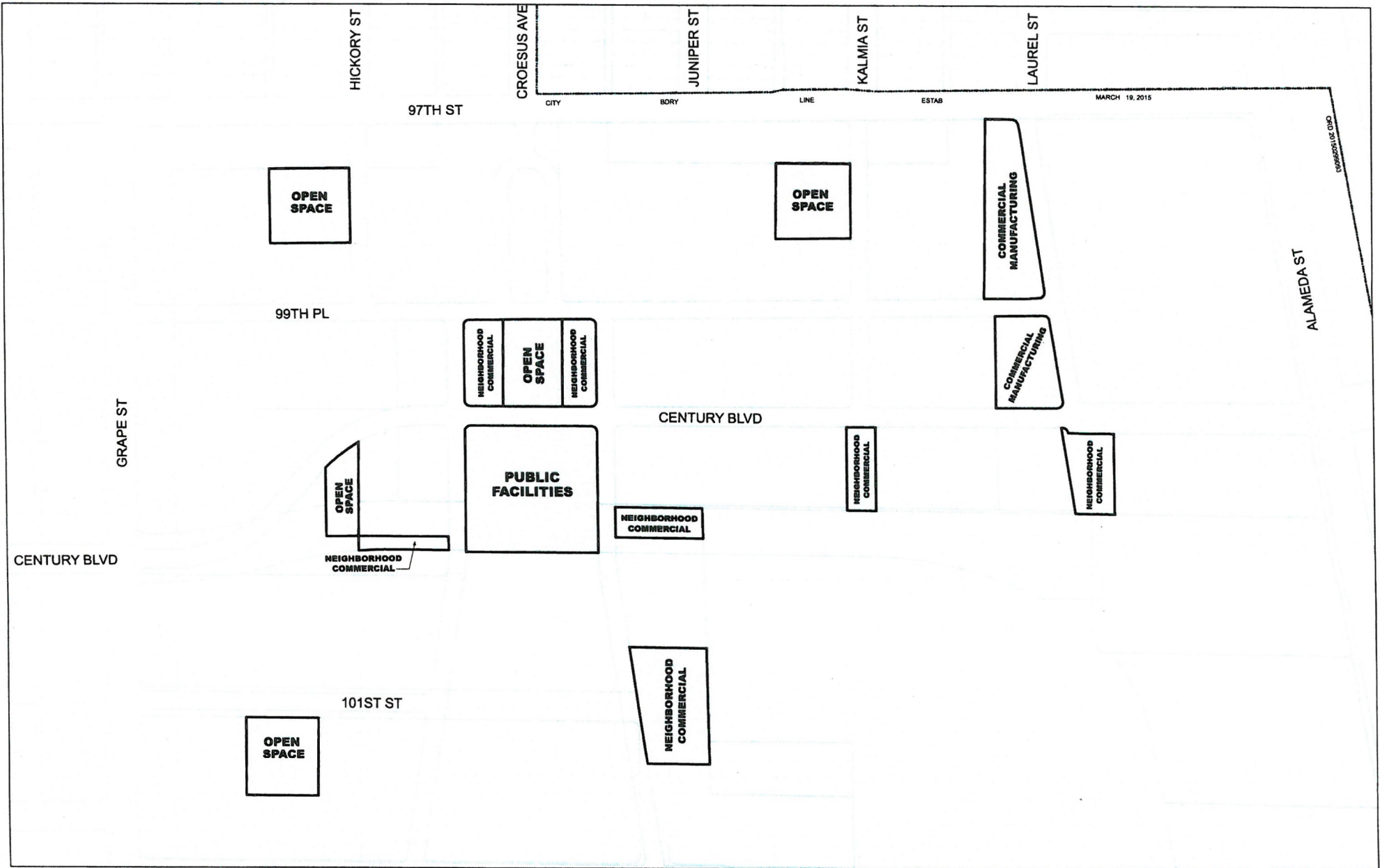

GENERAL PLAN AMENDMENT

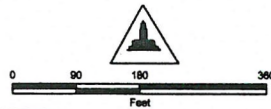

C.M. 091.5A 215, 091.5A 217  
093 A 215, 093 A 217

CPC-2015-3990-GPA-ZC-SP

AA/RE

SOUTHEAST LOS ANGELES

042916

THE INTENT OF THIS ORDINANCE IS FOR THE BOUNDARIES OF THIS GENERAL PLAN LAND USE CHANGE TO FOLLOW EXISTING GENERAL PLAN LAND USE LINES OR COINCIDE WITH THOSE OF RECORDED TR. 72805.

City of Los Angeles

