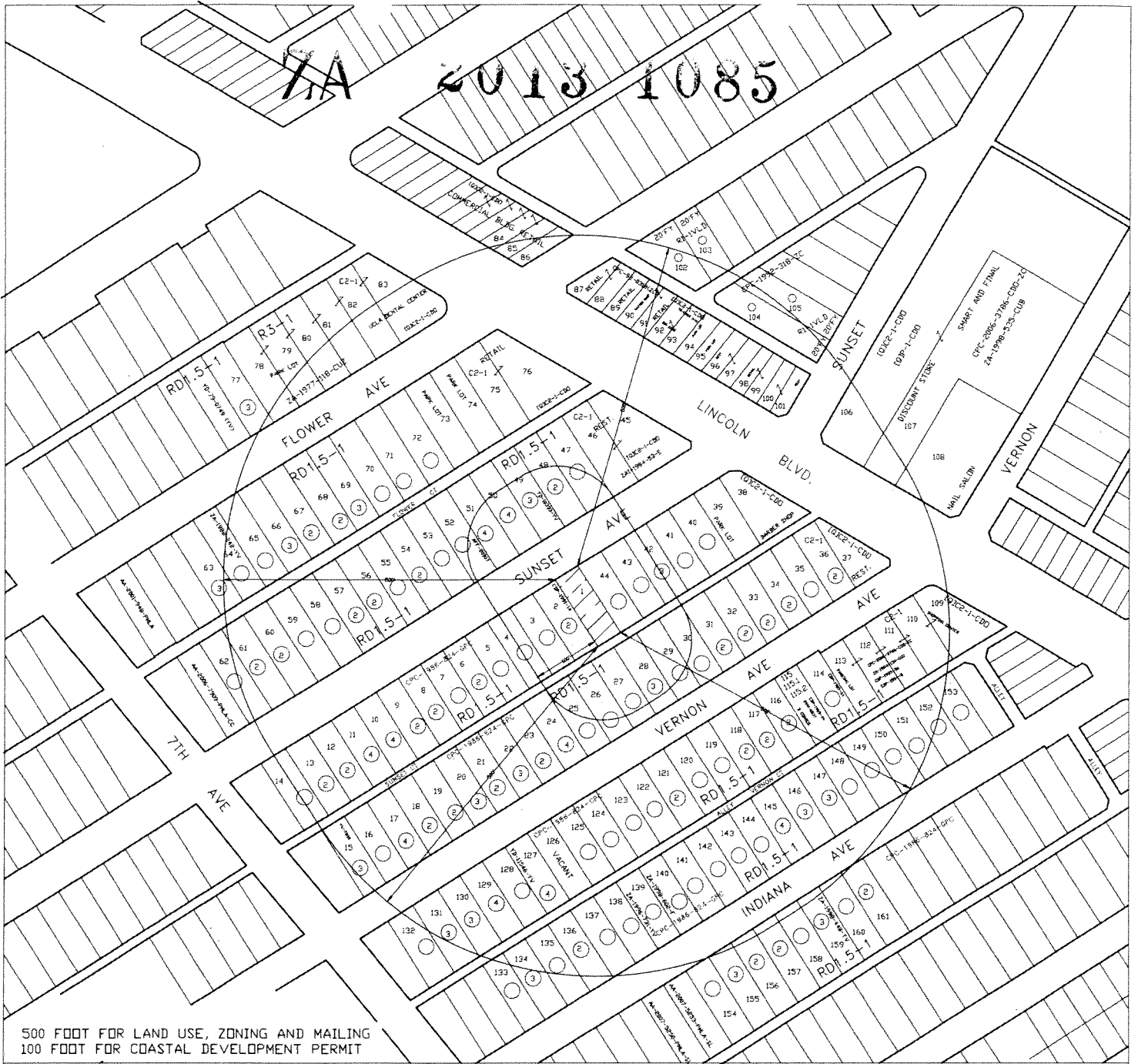

EXHIBIT 2



500 FOOT FOR LAND USE, ZONING AND MAILING
100 FOOT FOR COASTAL DEVELOPMENT PERMIT

PRELIMINARY PARCEL MAP (SMALL LOT)
AND COASTAL DEVELOPMENT PERMIT
500 FOOT RADIUS MAP

CASE NUMBERS:
Recent Activity DIR-2008-4703-DI
City Planning Commission CPC-2000-8632-CA
City Planning Commission CPC-2009-4046-CA
City Planning Commission CPC-1998-119-LCP
City Planning Commission CPC-1987-648-1CD
City Planning Commission CPC-1986-824-GPC
Ordinance DRD-175694
Ordinance DRD-175693
Ordinance DRD-178937
Ordinance DRD-172019
Ordinance DRD-164844-SA1160
Environmental ENV-2005-8253-ND
Environmental ENV-2002-6636-SF
Environmental ENV-2001-846-ND-MND

PARCEL LEGAL DESCRIPTION:
Site Address 760 E SUNSET AVE
Site Address 758 E SUNSET AVE
ZIP Code 90291
PIN Number 111B145 888
Lot/Parcel Area (Calculated) 4,802.2 (sq ft)
Thomas Brothers Grid PAGE 671 - GRID H4
Assessor Parcel No. (APN) 4240016046
Tract TR 1693
Map Reference M B 21-54/55
Block None
Lot 15
Arb (Lot Cut Reference) None
Map Sheet 111B145

SITE ADDRESS:
758 E SUNSET AVE.
760 E SUNSET AVE.
VENICE, CA 90291

DATE: 04/11/2013
SCALE: 1" = 100'

APPLICANT INFORMATION:
RUPESH LUNIA AND RICHARD
758 SUNSET AVE
VENICE, CA 90291

CONTACT PERSON:
SEAN NGUYEN
EZ PERMITS, LLC
7251 N. DWENSMOUTH #2
CANOGA PARK, CA 91303
213-880-6289
E-MAIL: SEAN@EZPERMITSLLC.COM
WWW.EZPERMITSLLC.COM

PREPARED BY:
EZ PERMITS, LLC
7251 N. DWENSMOUTH #2
CANOGA PARK, CA 91303
213-880-6289

Community Plan Area Venice
Area Planning Commission West Los Angeles
Neighborhood Council Venice
Council District CD 11 - Bill Rosendahl
Census Tract # 2732.00
LADBS District Office West Los Angeles

