

ORDINANCE NO. \_\_\_\_\_

An ordinance amending Section 12.04 of the Los Angeles Municipal Code by amending the Zoning map.

THE PEOPLE OF THE CITY OF LOS ANGELES DO ORDAIN AS FOLLOWS:

**Section 1.** Section 12.04 of the Los Angeles Municipal Code is hereby amended by changing the zone classifications on the properties shown upon a portion of the zone maps attached thereto and made a part of Article 2, Chapter 1 of the Los Angeles Municipal Code, so that such portion of the zoning map shall set forth the zones and height districts as shown on the attached zoning map. This ordinance supersedes portions of Subarea 34 in Ordinance No. 176825.

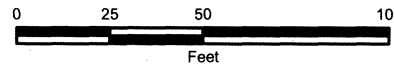
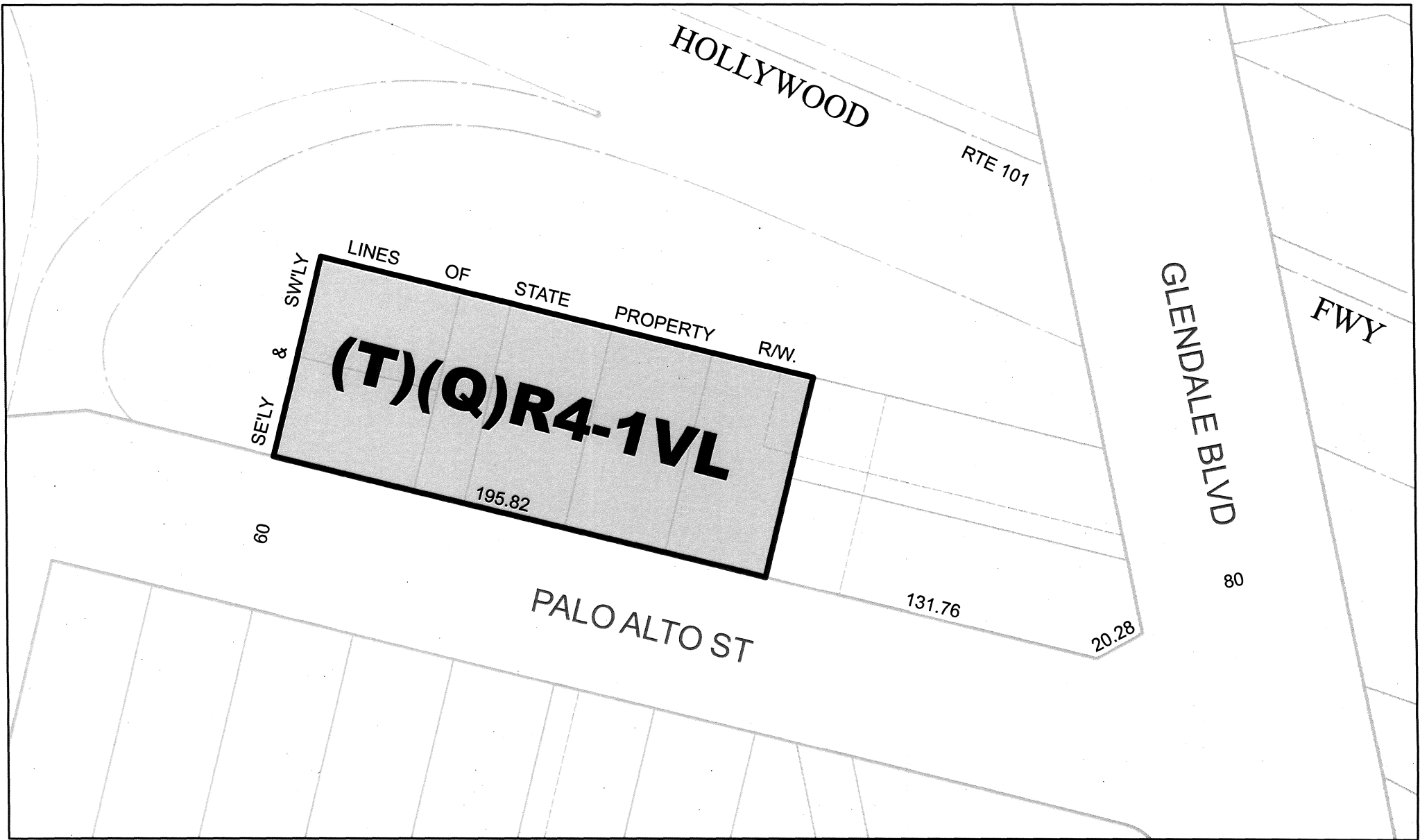

CPC-2015-3313-ZC-CU-ZV

AA/af

122116

City of Los Angeles

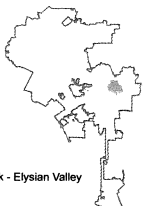

Silver Lake - Echo Park - Elysian Valley

## (Q) QUALIFIED CONDITIONS OF APPROVAL

Pursuant to Section 12.32-G of the Municipal Code, the following limitations are hereby imposed upon the use of the subject property, subject to the "Q" Qualified classification:

1. **Site Plan.** Except as modified herein, the project shall be in substantial conformance with the plans and materials stamped "Exhibit A" and dated August 4, 2016, and attached to the subject case file. No change to the plans will be made without prior review by the Department of City Planning, and written approval by the Director of Planning, with each change being identified and justified in writing. Minor deviations may be allowed in order to comply with provisions of the Municipal Code, the subject conditions, and the intent of the subject permit authorization.
2. **Hotel Use.** Authorized herein is the construction, use and maintenance of a maximum four-story hotel with up to 88 rooms. The total floor area on the project site shall not exceed 49,470 square feet.

**Section** \_\_. The City Clerk shall certify to the passage of this ordinance and have it published in accordance with Council policy, either in a daily newspaper circulated in the City of Los Angeles or by posting for ten days in three public places in the City of Los Angeles: one copy on the bulletin board located at the Main Street entrance to the Los Angeles City Hall; one copy on the bulletin board located at the Main Street entrance to the Los Angeles City Hall East; and one copy on the bulletin board located at the Temple Street entrance to the Los Angeles County Hall of Records.

I hereby certify that the foregoing ordinance was introduced at the Council of the City of Los Angeles at the meeting of \_\_\_\_\_

Holly L. Wolcott, City Clerk

By \_\_\_\_\_ Deputy

Approved \_\_\_\_\_

\_\_\_\_\_  
Mayor

Pursuant to Section 558 of the City Charter, the Los Angeles City Planning Commission on December 8, 2017 recommended this ordinance be adopted by the City Council.



\_\_\_\_\_  
James K. Williams, Commission Executive Assistant II  
City Planning Commission

File No.: \_\_\_\_\_