

ORDINANCE NO. \_\_\_\_\_

An ordinance amending Section 12.04 of the Los Angeles Municipal Code by amending the zoning map.

THE PEOPLE OF THE CITY OF LOS ANGELES DO ORDAIN AS FOLLOWS:

Section 1. Section 12.04 of the Los Angeles Municipal Code is hereby amended by changing the zone and zone boundaries shown upon a portion of the zone map attached thereto and made a part of Article 2, Chapter 1 of the Los Angeles Municipal Code, so that such portion of the zoning map shall be as follows:

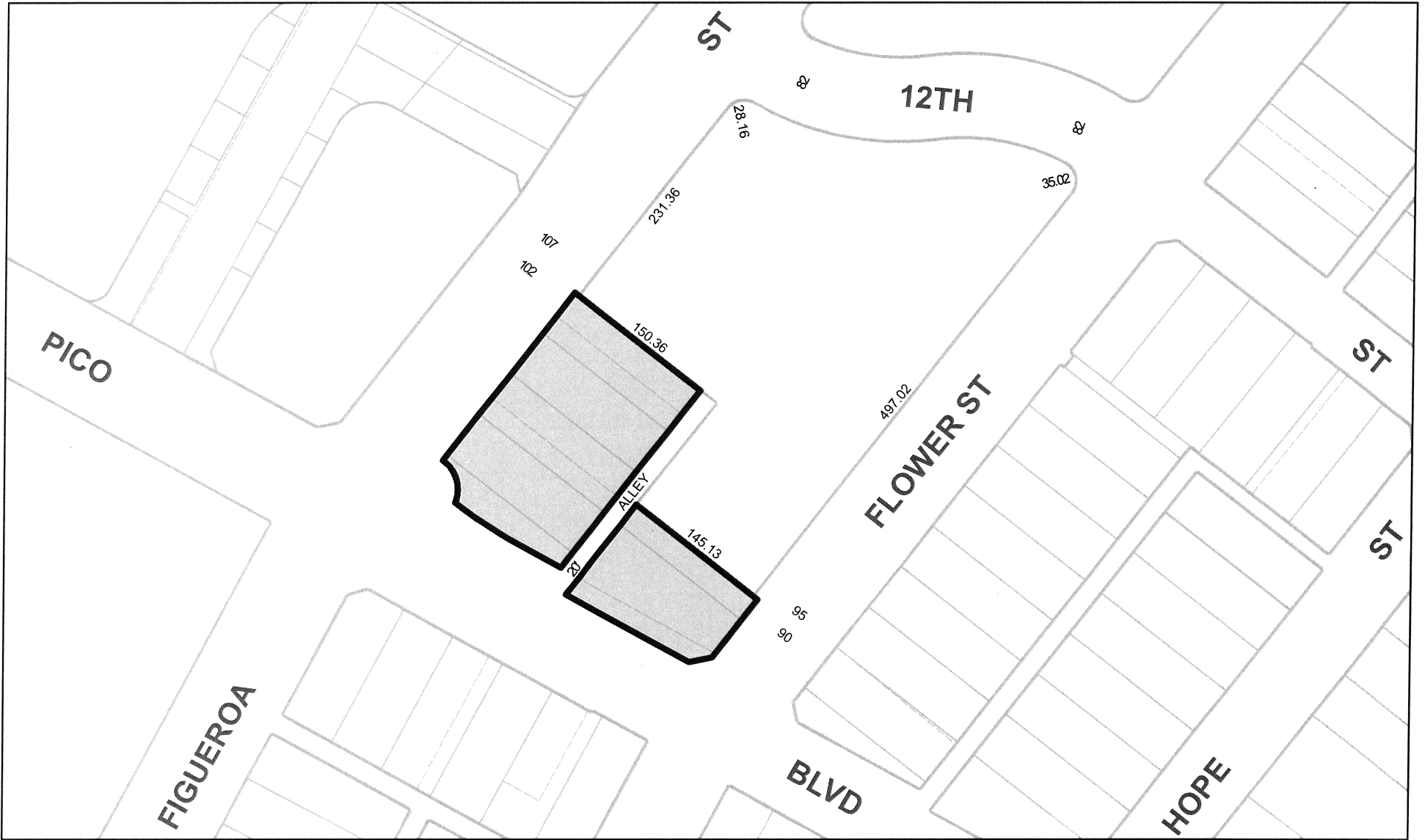

 **(T)(Q)C2-4D-O-SN**

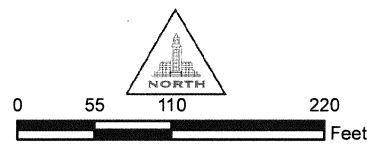

CPC-2016-4219-GPA-ZC  
 MY/CF 031318

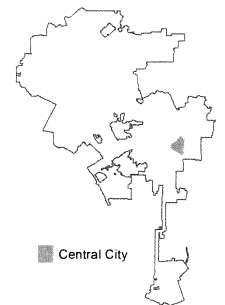

## (Q) QUALIFIED CONDITIONS OF APPROVAL

Pursuant to Section 12.32-G of the Municipal Code, the following limitations are hereby imposed upon the use of the subject property, subject to the “Q” Qualified classification.

### A. Development Conditions:

1. **Site Development.** The use and development of the property shall be in substantial conformance with the Site Plans, Floor Plans, Building Elevations, Landscape Plan (Exhibit A, dated March 8, 2018, with revised page A0.002) of the subject case file, and the required design changes identified below. No change to the plans will be made without prior review by the Department of City Planning, and written approval by the Director of Planning. Each change shall be identified and justified in writing. Minor deviations may be allowed in order to comply with the provisions of the Municipal Code or the project conditions. The project shall be constructed in a manner consistent with the following:
  - A maximum of 1,153 hotel guest rooms (775 guest rooms in “Hotel A/B Tower”; 378 guest rooms in “Hotel C Tower”)
  - A maximum of 13,145 square feet of ground-floor commercial uses within the two hotel towers (“Hotel A/B Tower” and “Hotel C Tower”)
- a) **Roof Design.** Project plans shall be revised to eliminate the flat roof design and replace it with a varied or sculptural roof design, in order to meet the following Downtown Design Guide standard, to the satisfaction of the Director of City Planning:

“A building’s top should be delineated with a change of detail and meet the sky with a thinner form, or tapered overhang. Towers should have tapered sculptural crowns and make an appropriate contribution to the quality and character of the Downtown skyline. Flat roofs are not recommended.”
- b) **Blank Walls.** A wall system with trellises and a decorative metal green screen shall be constructed along any blank walls at the ground-level. The trellises shall include live plantings and a maintenance plan of the wall shall be submitted for review and approval by the Director of City Planning.
2. **Signage.** Signage shall be subject to the requirements of the Figueroa and Pico Sign District and Los Angeles Municipal Code, as applicable.
3. **Development Services Center.** Prior to sign-off on building permits by the Department of City Planning’s Development Services Center for the project, the Department of City Planning’s Major Projects Section shall confirm, via signature, that the project’s building plans substantially conform to the conceptual plans stamped as Exhibit “A”, as approved by the City Planning Commission.

**Note to Development Services Center:** The plans presented to, and approved by, the City Planning Commission (CPC) included specific architectural details that were significant to the approval of the project. Plans submitted at plan check for condition clearance shall include a signature and date from Major Projects Section planning staff to ensure plans are consistent with those presented at CPC.

4. **Parking/Electric Vehicle Charging Stations.** Vehicular and bicycle parking shall be provided in accordance with the Municipal Code. The project shall encourage carpooling and the use of electric vehicles by providing that at least 20 percent of the total code-required parking spaces, but in no case less than one location, be capable of supporting future electric vehicle supply equipment (EVSE). Plans shall indicate the proposed type and location(s) of EVSE and also include raceway method(s), wiring schematics and electrical calculations to verify that the electrical system has sufficient capacity to simultaneously charge all electric vehicles at all designated EV charging locations at their full rated amperage. Plan design shall be based upon Level 2 or greater EVSE at its maximum operating capacity. Of the 20 percent EV Ready, five (5) percent of the total Code-required parking spaces shall be further provided with EV chargers to immediately accommodate electric vehicles within the parking area. Otherwise, only raceways and related components are required to be installed at the time of construction. When the application of the 20 percent results in a fractional space, round up to the next whole number. A label stating "EV CAPABLE" shall be posted in a conspicuous place at the service panel or subpanel and next to the raceway termination point.
5. **Landscaping.** All open areas not used for buildings, driveways, parking areas, recreational facilities or walks shall be attractively landscaped, including an automatic irrigation system, and maintained in accordance with a landscape plan prepared by a licensed landscape architect or licensed architect, and submitted for approval to the Department of City Planning.
6. **Lighting.** All outdoor lighting shall be shielded and down-casted within the site in a manner that prevents the illumination of adjacent public rights-of-way, adjacent properties, and the night sky (unless otherwise required by the Federal Aviation Administration (FAA) or for other public safety purposes). Areas where retail and restaurant uses are located shall be maintained to provide sufficient illumination of the immediate environment so as to render objects or persons clearly visible for the safety of the public and emergency response personnel.
7. **Ordinance 164,307.** The Q conditions of Ordinance 164,307 do not apply to the site. In addition, the floor area ratio limitations of Footnote 3 and any accompanying Floor Area Ratio map in the Central City Community Plan Land Use Map which references the Ordinance, do not apply to the site.
8. **Transfer of Floor Area Rights.** The property is exempt from Los Angeles Municipal Code Sections 14.5.1-14.5.12 (Transfer of Floor Area Rights).
9. **Tribal Cultural Resource Inadvertent Discovery.** In the event that objects or artifacts that may be tribal cultural resources are encountered during the course of any ground disturbance activities (including the following: excavating, digging, trenching, plowing, drilling, tunneling, quarrying, grading, leveling, removing peat, clearing, pounding posts, auguring, backfilling, blasting, stripping topsoil or a similar activity), all such activities shall temporarily cease on the project site until the potential tribal cultural resources are properly assessed and addressed pursuant to the process set forth below:
  - Upon a discovery of a potential tribal cultural resource, the project Permittee shall immediately stop all ground disturbance activities and contact the following: (1) all California Native American tribes that have informed the City they are traditionally and culturally affiliated with the geographic area of the proposed project; (2) and the

- Department of City Planning at (213) 978-1454.
- If the City determines, pursuant to Public Resources Code Section 21074 (a)(2), that the object or artifact appears to be tribal cultural resource, the City shall provide any effected tribe a reasonable period of time, not less than 14 days, to conduct a site visit and make recommendations to the Project permittee and the City regarding the monitoring of future ground disturbance activities, as well as the treatment and disposition of any discovered tribal cultural resources.
  - The project Permittee shall implement the tribe's recommendations if a qualified archaeologist, retained by the City and paid for by the project Permittee, reasonably concludes that the tribe's recommendations are reasonable and feasible.
  - The project Permittee shall submit a tribal cultural resource monitoring plan to the City that includes all recommendations from the City and any effected tribes that have been reviewed and determined by the qualified archaeologist to be reasonable and feasible. The project Permittee shall not be allowed to recommence ground disturbance activities until this plan is approved by the City.
  - If the project Permittee does not accept a particular recommendation determined to be reasonable and feasible by the qualified archaeologist, the project Permittee may request mediation by a mediator agreed to by the Permittee and the City who has the requisite professional qualifications and experience to mediate such a dispute. The project Permittee shall pay any costs associated with the mediation.
  - The project Permittee may recommence ground disturbance activities outside of a specified radius of the discovery site, so long as this radius has been reviewed by the qualified archaeologist and determined to be reasonable and appropriate.
  - Copies of any subsequent prehistoric archaeological study, tribal cultural resources study or report, detailing the nature of any significant tribal cultural resources, remedial actions taken, and disposition of any significant tribal cultural resources shall be submitted to the South Central Coastal Information Center (SCCIC) at California State University, Fullerton.
  - Notwithstanding the above, any information determined to be confidential in nature, by the City Attorney's office, shall be excluded from submission to the SCCIC or the general public under the applicable provisions of the California Public Records Act, California Public Resources Code, and shall comply with the City's AB 52 Confidentiality Protocols.
10. **Public Benefits.** Prior to the issuance of a building permit or the recordation of the final map, the Department of Building and Safety shall confirm that the public benefits, as identified in the Development Agreement from Case No. CPC-2016-2595-DA-CU-MCUP-CUX-SPR, have been satisfied.
11. **Street Tree Maintenance.** Street trees along the street frontages of site shall be trimmed by the Urban Forestry Division of the Bureau of Street Services. Street tree trimming by private parties shall be prohibited, in order to ensure that street trees are not damaged for the purpose of increasing sign visibility.
12. **Ground-Floor Outdoor Speakers.** Outdoor speakers at the ground-floor of the project site shall be non-operational between the hours of midnight and 7:00 a.m., and shall comply with all applicable noise regulations of the Municipal Code.

B. Environmental Conditions.

1. **Mitigation Monitoring Program.** The project shall be in substantial conformance with the mitigation measures in the attached MMP and stamped "Exhibit B" and attached to

the subject case file. The implementing and enforcing agencies may determine substantial conformance with mitigation measures in the MMP. If substantial conformance results in effectively deleting or modifying the mitigation measure, the Director of Planning shall provide a written justification supported by substantial evidence as to why the mitigation measure, in whole or in part, is no longer needed and its effective deletion or modification will not result in a new significant impact or a more severe impact to a previously identified significant impact.

If the Project is not in substantial conformance to the adopted mitigation measures or MMP, a modification or deletion shall be treated as a new discretionary action under CEQA Guidelines, Section 15162(c) and will require preparation of an addendum or subsequent CEQA clearance. Under this process, the modification or deletion of a mitigation measure shall not require a Tract Map Modification unless the Director of Planning also finds that the change to the mitigation measures results in a substantial change to the Project or the non-environmental conditions of approval.

2. **Mitigation Monitor (Construction).** During the construction phase and prior to the issuance of building permits, the Applicant shall retain an independent Construction Monitor (either via the City or through a third-party consultant, the election of which is in the sole discretion of the Applicant), approved by the City of Los Angeles Department of City Planning which approval shall not be reasonably withheld, who shall be responsible for monitoring implementation of project design features and mitigation measures during construction activities consistent with the monitoring phase and frequency set forth in this MMP.

The Construction Monitor shall also prepare documentation of the Applicant's compliance with the project design features and mitigation measures during construction every 90 days in a form satisfactory to the Department of City Planning. The documentation must be signed by the Applicant and Construction Monitor and be included as part of the Applicant's Compliance Report. The Construction Monitor shall be obligated to report to the Enforcement Agency any non-compliance with mitigation measures and project design features within two businesses days if the Applicant does not correct the non-compliance within a reasonable time of written notification to the Applicant by the monitor or if the non-compliance is repeated. Such non-compliance shall be appropriately addressed by the Enforcement Agency.

C. Administrative Conditions:

1. **Approval, Verification and Submittals.** Copies of any approvals, guarantees or verification of consultations, review or approval, plans, etc., as may be required by the subject conditions, shall be provided to the Planning Department for placement in the subject file.
2. **Code Compliance.** Area, height and use regulations of the zone classification of the subject property shall be complied with, except where herein conditions are more restrictive.
3. **Covenant.** Prior to the issuance of any permits relative to this matter, an agreement concerning all the information contained in these conditions shall be recorded in the County Recorder's Office. The agreement shall run with the land and shall be binding on any subsequent property owners, heirs or assign. The agreement must be submitted to the Planning Department for approval before being recorded. After recordation, a

copy bearing the Recorder's number and date shall be provided to the Planning Department for attachment to the file.

4. **Definition.** Any agencies, public officials or legislation referenced in these conditions shall mean those agencies, public officials, legislation or their successors, designees or amendment to any legislation.
5. **Enforcement.** Compliance with these conditions and the intent of these conditions shall be to the satisfaction of the Planning Department and any designated agency, or the agency's successor and in accordance with any stated laws or regulations, or any amendments thereto.
6. **Building Plans.** Page 1 of the grants and all the conditions of approval shall be printed on the building plans submitted to the City Planning Department and the Department of Building and Safety.
7. **Project Plan Modifications.** Any corrections and/or modifications to the Project plans made subsequent to this grant that are deemed necessary by the Department of Building and Safety, Housing Department, or other Agency for Code compliance, and which involve a change in site plan, floor area, parking, building height, yards or setbacks, building separations, or lot coverage, shall require a referral of the revised plans back to the Department of City Planning for additional review and final sign-off prior to the issuance of any building permit in connection with said plans. This process may require additional review and/or action by the appropriate decision-making authority including the Director of Planning, City Planning Commission, Area Planning Commission, or Board.
8. **Indemnification and Reimbursement of Litigation Costs.** The Applicant shall do all of the following:
  - (i) Defend, indemnify and hold harmless the City from any and all actions against the City relating to or arising out of, in whole or in part, the City's processing and approval of this entitlement, including but not limited to, an action to attack, challenge, set aside, void, or otherwise modify or annul the approval of the entitlement, the environmental review of the entitlement, or the approval of subsequent permit decisions, or to claim personal property damage, including from inverse condemnation or any other constitutional claim.
  - (ii) Reimburse the City for any and all costs incurred in defense of an action related to or arising out of, in whole or in part, the City's processing and approval of the entitlement, including but not limited to payment of all court costs and attorney's fees, costs of any judgments or awards against the City (including an award of attorney's fees), damages, and/or settlement costs.
  - (iii) Submit an initial deposit for the City's litigation costs to the City within 10 days' notice of the City tendering defense to the Applicant and requesting a deposit. The initial deposit shall be in an amount set by the City Attorney's Office, in its sole discretion, based on the nature and scope of action, but in no event shall the initial deposit be less than \$50,000. The City's failure to notice or collect the deposit does not relieve the Applicant from responsibility to reimburse the City pursuant to the requirement in paragraph (ii).
  - (iv) Submit supplemental deposits upon notice by the City. Supplemental deposits may be required in an increased amount from the initial deposit if found necessary by the City to protect the City's interests. The City's failure to notice or

collect the deposit does not relieve the Applicant from responsibility to reimburse the City pursuant to the requirement in paragraph (ii).

- (v) If the City determines it necessary to protect the City's interest, execute an indemnity and reimbursement agreement with the City under terms consistent with the requirements of this condition.

The City shall notify the applicant within a reasonable period of time of its receipt of any action and the City shall cooperate in the defense. If the City fails to notify the applicant of any claim, action, or proceeding in a reasonable time, or if the City fails to reasonably cooperate in the defense, the applicant shall not thereafter be responsible to defend, indemnify or hold harmless the City.

The City shall have the sole right to choose its counsel, including the City Attorney's office or outside counsel. At its sole discretion, the City may participate at its own expense in the defense of any action, but such participation shall not relieve the applicant of any obligation imposed by this condition. In the event the Applicant fails to comply with this condition, in whole or in part, the City may withdraw its defense of the action, void its approval of the entitlement, or take any other action. The City retains the right to make all decisions with respect to its representations in any legal proceeding, including its inherent right to abandon or settle litigation.

For purposes of this condition, the following definitions apply:

"City" shall be defined to include the City, its agents, officers, boards, commissions, committees, employees, and volunteers.

"Action" shall be defined to include suits, proceedings (including those held under alternative dispute resolution procedures), claims, or lawsuits. Actions includes actions, as defined herein, alleging failure to comply with any federal, state or local law.

Nothing in the definitions included in this paragraph are intended to limit the rights of the City or the obligations of the Applicant otherwise created by this condition.



## D LIMITATIONS

Pursuant to Section 12.32-G of the Municipal Code, the following limitations are hereby imposed upon the use of the subject property, subject to the D limitation.

A. Development Limitations:

1. **Floor Area Ratio.** Floor area over the entire site, as identified in the Ordinance Map, shall not exceed ten times the buildable area of the site, not to exceed a total of 505,335 square-feet of floor area.
2. **Building Height.** Building height shall be limited to 465 feet for the portion of the site west of the mid-block alleyway along Pico Boulevard between Figueroa Street and Flower Street. Building height shall be limited to 350 feet for the portion of the site east of the mid-block alleyway along Pico Boulevard between Figueroa Street and Flower Street.
3. **Ordinance 164,307.** The D limitations of Ordinance 164,307 do not apply to the site. In addition, the floor area ratio limitations of Footnote 3 and any accompanying Floor Area Ratio map in the Central City Community Plan Land Use Map which references the Ordinance, do not apply to the site.

Sec. XX. The City Clerk shall certify to the passage of this ordinance and have it published in accordance with Council policy, either in a daily newspaper circulated in the City of Los Angeles or by posting for ten days in three public places in the City of Los Angeles: one copy on the bulletin board located at the Main Street entrance to the Los Angeles City Hall; one copy on the bulletin board located at the Main Street entrance to the Los Angeles City Hall East; and one copy on the bulletin board located at the Temple Street entrance to the Los Angeles County Hall of Records.

Pursuant to Section 558 of the City Charter, the City Planning Commission on **March 8, 2018** recommends this ordinance **BE ADOPTED** by the City Council.

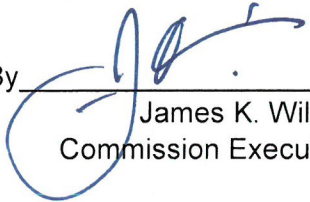
By  \_\_\_\_\_  
James K. Williams  
Commission Executive Assistant II

File No. \_\_\_\_\_

I hereby certify that the foregoing ordinance was passed by a **vote of not less than two-thirds of all its members** by the Council of the City of Los Angeles.

CITY CLERK

MAYOR

\_\_\_\_\_

\_\_\_\_\_

Ordinance Passed \_\_\_\_\_

Approved \_\_\_\_\_