

ORDINANCE NO. \_\_\_\_\_

An ordinance amending Section 12.04 of the Los Angeles Municipal Code by amending the zoning map.

THE PEOPLE OF THE CITY OF LOS ANGELES DO ORDAIN AS FOLLOWS:

Section 1. Section 12.04 of the Los Angeles Municipal Code is hereby amended by changing the zone and zone boundaries shown upon a portion of the zone map attached thereto and made a part of Article 2, Chapter 1 of the Los Angeles Municipal Code, so that such portion of the zoning map shall be as follows:

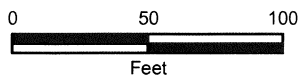
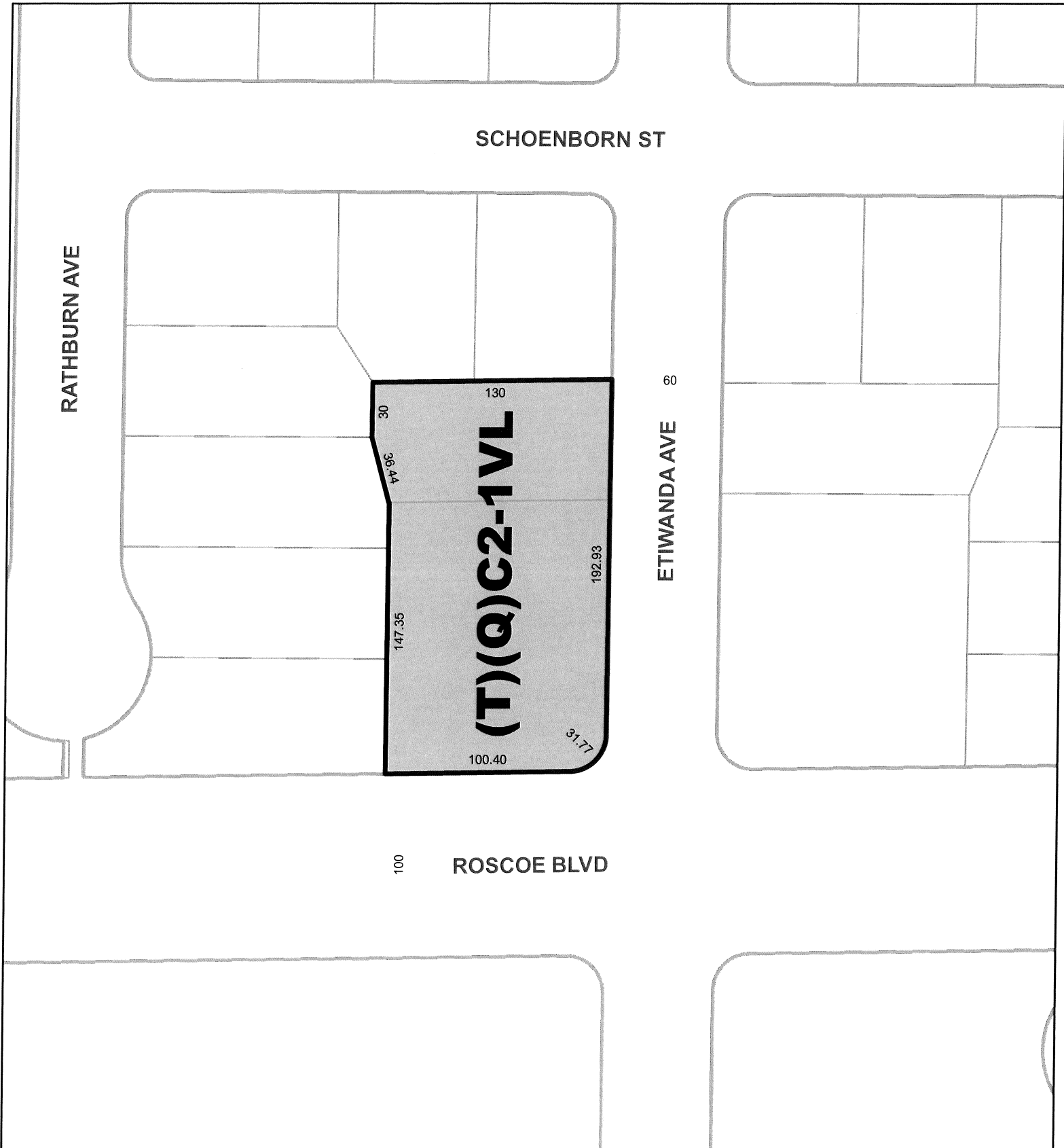

APCNV-2017-4684-VZC-BL-WDI

AAI of

031519

City of Los Angeles

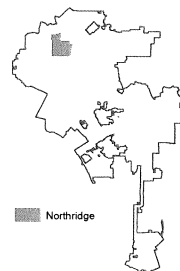

## (Q) QUALIFIED CONDITIONS OF APPROVAL

### Development Conditions:

1. **Site Plan.** Except as modified herein, the project shall be in substantial conformance with the plans and materials stamped "Exhibit A" and dated February 20, 2019, and attached to the subject case file. No change to the plans will be made without prior review by the Department of City Planning, and written approval by the Director of Planning. Minor deviations may be allowed in order to comply with the provisions of the Municipal Code, the subject conditions, and the intent of the subject permit authorization.
2. **Use.** The use of the subject property shall be limited to a 9,304 square foot medical office/clinic building.
3. **Height.** The medical office building shall not exceed 20 feet and 7 inches in height, as shown on the plans dated February 20, 2019, and labeled "Exhibit A," attached to this case. Any roof-top air conditioning units and other equipment and/or utilities shall be fully screened from view of any abutting residential properties.
4. **Landscaping (Open Areas).** All open areas not used for buildings, driveways, parking areas, recreational facilities, or walks shall be attractively landscaped, including an automatic irrigation system, and maintained in accordance with a landscape plan prepared by a licensed landscape architect or licensed architect, and submitted for approval to the Department of City Planning. Additionally, landscaping is required to complement the building design and shall comply with the City of Los Angeles Landscape Ordinance No. 170,978 and Section 12.40 of the LAMC. The parking lot landscaping shall comply with Landscape Ordinance "GUIDELINES K—VEHICULAR USE AREAS".
5. **Wall.** Prior to a Certificate of Occupancy, a minimum 6-foot tall slumpstone or decorative masonry wall shall be constructed adjacent to neighboring residences, if no such wall already exists, except in the yards facing Etiwanda Avenue and Roscoe Boulevard.

### Environmental Conditions (ENV-2017-4685-MND):

6. **Aesthetics (Light).** Outdoor lighting shall be designed and installed with shielding, such that the light source cannot be seen from adjacent residential properties, the public right-of-way, nor from above.
7. **Aesthetics (Glare).** The exterior of the proposed structure shall be constructed of such materials as such, but not limited to, high-performance and/or non-reflective tinted glass (no mirror-like tints or films) and pre-cast concrete or fabricated wall surfaces to minimize the glare and reflected heat.
8. **Habitat Modification (Nesting Birds, Non-Hillside or Urban Areas).** Proposed project activities (including disturbances to native and non-native vegetation, structures and substrates) should take place outside of the breeding bird season which generally runs from March 1-August 31 (as early as February 1 for raptors) to avoid take (including

disturbances which would cause abandonment of active nests containing eggs and/or young). Take means to hunt, pursue, capture, or kill, or attempt to hunt, pursue, capture or kill (Fish and Game Section 86).

9. **Habitat Modification (Nesting Birds, Non-Hillside or Urban Areas).** If project activities cannot feasibly avoid the breeding bird season, beginning thirty days prior to the disturbance of suitable nesting habitat, the applicant shall:
  - a. Arrange for weekly bird surveys to detect any protected native birds in the habitat to be removed and any other such habitat within properties adjacent to the project site, as access to adjacent areas allows. The surveys shall be conducted by a qualified biologist with experience in conducting breeding bird surveys. The surveys shall continue on a weekly basis with the last survey being conducted no more than 3 days prior to the initiation of clearance/construction work.
  - b. If a protected native bird is found, the applicant shall delay all clearance/construction disturbance activities within 300 feet of suitable nesting habitat for the observed protected bird species until August 31.
  - c. Alternatively, the Qualified Biologist could continue the surveys in order to locate any nests. If an active nest is located, clearing and construction within 300 feet of the nest or as determined by a qualified biological monitor, shall be postponed until the nest is vacated and juveniles have fledged and when there is no evidence of a second attempt at nesting. The buffer zone from the nest shall be established in the field with flagging and stakes. Construction personnel shall be instructed on the sensitivity of the area.
  - d. The applicant shall record the results of the recommended protective measures described above to document compliance with applicable State and Federal laws pertaining to the protection of native birds. Such record shall be submitted and received into the case file for the associated discretionary action permitting the project.
10. **Tree Removal (Non-Protected Trees).** Prior to the issuance of any permit, a plot plan shall be prepared indicating the location, size, type, and general condition of all existing trees on site and within the adjacent public right(s)-of-way.
11. **Tree Removal (Non-Protected Trees).** Removal or planting of any tree in the public right-of-way requires approval of the Board of Public Works. Contact Urban Forestry Division at: 213-847-3077. All trees in the public right-of-way shall be provided per the current standards of the Urban Forestry Division, Bureau of Street Services, Department of Public Works.
12. **Safety Hazards (Traffic Signs).** The developer shall install appropriate traffic signs around the site to ensure pedestrian, bicycle, and vehicle safety.

13. **Safety Hazards (Parking and Driveway Plan).** The applicant shall submit a parking and driveway plan that incorporates design features that reduce accidents, to the Bureau of Engineering and the Department of Transportation for approval.
14. **Inadequate Safety Access.** The applicant shall submit a parking and driveway plan to the Bureau of Engineering and the Department of Transportation for approval that provides code-required emergency access.
15. **Transportation/Traffic.** Applicant shall plan construction and construction staging as to maintain pedestrian access on adjacent sidewalks throughout all construction phases. This requires the applicant to maintain adequate and safe pedestrian protection, including physical separation (including utilization of barriers such as K-Rails or scaffolding, etc.) from work space and vehicular traffic and overhead protection, due to sidewalk closure or blockage, at all times.
16. **Transportation/Traffic.** Temporary pedestrian facilities should be adjacent to the project site and provide safe, accessible routes that replicate nearly as practical as the most desirable characteristics of the existing facility.
17. **Transportation/Traffic.** Covered walkways shall be provided where pedestrians are exposed to potential injury from falling objects.
18. **Transportation/Traffic.** Applicant shall keep sidewalk open during construction until only when it is absolutely necessary to require close or block sidewalk for construction staging. Sidewalk shall be reopened as soon as reasonably feasible taking construction and construction staging into account.

**Administrative Conditions:**

19. **Approval, Verification and Submittals.** Copies of any approvals, guarantees or verification of consultations, review or approval, plans, etc., as may be required by the subject conditions, shall be provided to the Department of City Planning for placement in the subject file.
20. **Code Compliance.** The area, height and use regulations of the zone classification of the subject property shall be complied with, except where conditions herein are more restrictive.
21. **Covenant.** Prior to the issuance of any permits relative to this matter, a covenant acknowledging and agreeing to comply with all the terms and conditions established herein shall be recorded in the County Recorder's Office. The agreement (standard master covenant and agreement form CP-6770) shall run with the land and shall be binding on any subsequent owners, heirs or assigns. The agreement with the conditions attached must be submitted to the Development Services Center for approval before being recorded. After recordation, a certified copy bearing the Recorder's number and date shall be provided to the Department of City Planning for attachment to the subject case file.

22. **Definition.** Any agencies, public officials or legislation referenced in these conditions shall mean those agencies, public officials, legislation or their successors, designees or amendment to any legislation.
23. **Enforcement.** Compliance with these conditions and the intent of these conditions shall be to the satisfaction of the Department of City Planning and any designated agency, or the agency's successor and in accordance with any stated laws or regulations, or any amendments thereto.
24. **Building Plans.** Page 1 of the grant and all the conditions of approval shall be printed on the building plans submitted to the Department of City Planning and Department of Building and Safety.
25. **Corrective Conditions.** The authorized use shall be conducted at all times with due regard for the character of the surrounding district, and the right is reserved to the Area Planning Commission, or the Director pursuant to Section 12.27.1 of the Municipal Code, to impose additional corrective conditions if, in the Commission's or Director's opinion, such conditions are proven necessary for the protection of persons in the neighborhood or occupants of adjacent property.
26. **Tribal Cultural Resources Inadvertent Discovery.** In the event that objects or artifacts that may be tribal cultural resources are encountered during the course of any ground disturbance activities (excavating, digging, trenching, plowing, drilling, tunneling, quarrying, grading, leveling, removing peat, clearing, driving posts, augering, backfilling, blasting, stripping topsoil or a similar activity), all such activities shall temporarily cease on the project site until the potential tribal cultural resources are properly assessed and addressed pursuant to the process set forth below:
- a. Upon a discovery of a potential tribal cultural resource, the Applicant shall immediately stop all ground disturbance activities and contact the following: (1) all California Native American tribes that have informed the City they are traditionally and culturally affiliated with the geographic area of the proposed project; (2) and the Department of City Planning at (818) 374-5072.
  - b. If the City determines, pursuant to Public Resources Code Section 21074 (a)(2), that the object or artifact appears to be a tribal cultural resource, the City shall provide any effected tribe a reasonable period of time, not less than 30 days, to conduct a site visit and make recommendations to the Applicant and the City regarding the monitoring of future ground disturbance activities, as well as the treatment and disposition of any discovered tribal cultural resources.
  - c. The Applicant shall implement the tribe's recommendations if a qualified archaeologist and by a culturally affiliated tribal monitor, both retained by the City and paid for by the Applicant, reasonably concludes that the tribe's recommendations are reasonable and feasible.

- d. The Applicant shall submit a tribal cultural resource monitoring plan to the City that includes all recommendations from the City and any effected tribes that have been reviewed and determined by the qualified archaeologist and by a culturally affiliated tribal monitor to be reasonable and feasible. The Applicant shall not be allowed to recommence ground disturbance activities until this plan is approved by the City.
  - e. If the Applicant does not accept a particular recommendation determined to be reasonable and feasible by the qualified archaeologist or by a culturally affiliated tribal monitor, the Applicant may request mediation by a mediator agreed to by the Applicant and the City who has the requisite professional qualifications and experience to mediate such a dispute. The Applicant shall pay any costs associated with the mediation.
  - f. The Applicant may recommence ground disturbance activities outside of a specified radius of the discovery site, so long as this radius has been reviewed by the qualified archaeologist and by a culturally affiliated tribal monitor and determined to be reasonable and appropriate.
  - g. Copies of any subsequent prehistoric archaeological study, tribal cultural resources study or report, detailing the nature of any significant tribal cultural resources, remedial actions taken, and disposition of any significant tribal cultural resources shall be submitted to the South Central Coastal Information Center (SCCIC) at California State University, Fullerton.
27. **Human Remains Inadvertent Discovery.** In the event that human skeletal remains are encountered at the project site during construction or the course of any ground disturbance activities, all such activities shall halt immediately, pursuant to State Health and Safety Code Section 7050.5 which requires that no further ground disturbance shall occur until the County Coroner has made the necessary findings as to the origin and disposition pursuant to California Public Resources Code Section 5097.98. In the event human skeletal remains are discovered during construction or during any ground disturbance actives, the following procedures shall be followed:
- a. Stop immediately and contact the County Coroner:  
1104 N. Mission Road  
Los Angeles, CA 90033  
323-343-0512 (8 a.m. to 5 p.m. Monday through Friday) or  
323-343-0714 (After Hours, Saturday, Sunday, and Holidays)
  - b. If the remains are determined to be of Native American descent, the Coroner has 24 hours to notify the Native American Heritage Commission (NAHC).
  - c. The NAHC will immediately notify the person it believes to be the most likely descendent of the deceased Native American.

- d. The most likely descendent has 48 hours to make recommendations to the Applicant, for the treatment or disposition, with proper dignity, of the human remains and grave goods.
- e. If the Applicant does not accept the descendant's recommendations, the owner or the descendent may request mediation by the NAHC.

**28. Archaeological Resources Inadvertent Discovery.** In the event that any subsurface cultural resources are encountered at the project site during construction or the course of any ground disturbance activities, all such activities shall halt immediately, pursuant to State Health and Safety Code Section 7050.5. At which time the applicant shall notify the City and consult with a qualified archaeologist who shall evaluate the find in accordance with Federal, State, and local guidelines, including those set forth in the California Public Resources Code Section 21083.2 and shall determine the necessary findings as to the origin and disposition to assess the significance of the find. If any find is determined to be significant, appropriate avoidance measures recommended by the consultant and approved by the City must be followed unless avoidance is determined to be unnecessary or infeasible by the City. If avoidance is unnecessary or infeasible, other appropriate measures (e.g., data recovery, excavation) shall be instituted.

**29. Paleontological Resources Inadvertent Discovery.** In the event that any prehistoric subsurface cultural resources are encountered at the project site during construction or the course of any ground disturbance activities, all such activities shall halt immediately, at which time the applicant shall notify the City and consult with a qualified paleontologist to assess the significance of the find. In the case of discovery of paleontological resources, the assessment shall be done in accordance with the Society of Vertebrate Paleontology standards. If any find is determined to be significant, appropriate avoidance measures recommended by the consultant and approved by the City must be followed unless avoidance is determined to be unnecessary or infeasible by the City. If avoidance is unnecessary or infeasible, other appropriate measures (e.g., data recovery, excavation) shall be instituted.

**30. Indemnification and Reimbursement of Litigation Costs.**

The applicant shall do all of the following:

- i. Defend, indemnify and hold harmless the City from any and all actions against the City, in whole or in part, relating to or arising out of the City's processing and approval of this entitlement, including but not limited to, an action to attack, challenge, set aside, void, or otherwise modify or annul the approval of the entitlement, the environmental review of the entitlement, or the approval of subsequent permit decisions, or to claim personal property damage, including from inverse condemnation or any other constitutional claim.
- ii. Reimburse the City for any and all costs incurred in defense of an action related to or arising out of the City's processing and approval of the entitlement, including but not limited to payment of all court costs and attorney's fees, costs of any judgments or awards against the City (including an award of attorney's fees), damages, and/or settlement costs.



- iii. Submit an initial deposit for the City's litigation costs to the City within 10 days' notice of the City tendering defense to the Applicant and requesting a deposit. The initial deposit shall be in an amount set by the City Attorney's Office, in its sole discretion, based on the nature and scope of action, but in no event shall the initial deposit be less than \$50,000. The City's failure to notice or collect the deposit does not relieve the Applicant from responsibility to reimburse the City pursuant to the requirement in paragraph (ii).
- iv. Submit supplemental deposits upon notice by the City. Supplemental deposits may be required in an increased amount from the initial deposit if found necessary by the City to protect the City's interests. The City's failure to notice or collect the deposit does not relieve the Applicant from responsibility to reimburse the City pursuant to the requirement in paragraph (ii).
- v. If the City determines it necessary to protect the City's interest, execute an indemnity and reimbursement agreement with the City under terms consistent with the requirements of this condition.

The City shall notify the applicant within a reasonable period of time of its receipt of any action and the City shall cooperate in the defense. If the City fails to notify the applicant of any claim, action, or proceeding in a reasonable time, or if the City fails to reasonably cooperate in the defense, the applicant shall not thereafter be responsible to defend, indemnify or hold harmless the City.

The City shall have the sole right to choose its counsel, including the City Attorney's office or outside counsel. At its sole discretion, the City may participate at its own expense in the defense of any action, but such participation shall not relieve the applicant of any obligation imposed by this condition. In the event the Applicant fails to comply with this condition, in whole or in part, the City may withdraw its defense of the action, void its approval of the entitlement, or take any other action. The City retains the right to make all decisions with respect to its representations in any legal proceeding, including its inherent right to abandon or settle litigation.

For purposes of this condition, the following definitions apply:

"City" shall be defined to include the City, its agents, officers, boards, commissions, committees, employees, and volunteers.

"Action" shall be defined to include suits, proceedings (including those held under alternative dispute resolution procedures), claims, or lawsuits. Actions includes actions, as defined herein, alleging failure to comply with any federal, state or local law.

Nothing in the definitions included in this paragraph are intended to limit the rights of the City or the obligations of the Applicant otherwise created by this condition.

**Sec. XX.** The City Clerk shall certify to the passage of this ordinance and have it published in accordance with Council policy, either in a daily newspaper circulated in the City of Los Angeles or by posting for ten days in three public places in the City of Los Angeles: one copy on the bulletin board located at the Main Street entrance to the Los Angeles City Hall; one copy on the bulletin board located at the Main Street entrance to the Los Angeles City Hall East; and one copy on the bulletin board located at the Temple Street entrance to the Los Angeles County Hall of Records.

Pursuant to Section 558 of the City Charter, the Los Angeles City Planning Commission on **March 21, 2019** recommends this ordinance **BE ADOPTED** by the City Council.

By Rafael Vega  
Rafael Vega  
Commission Executive Assistant

File No. \_\_\_\_\_

CITY CLERK

MAYOR

\_\_\_\_\_

\_\_\_\_\_

Ordinance Passed \_\_\_\_\_

Approved \_\_\_\_\_