

ORDINANCE NO. _____

An ordinance amending Section 12.04 of the Los Angeles Municipal Code by amending the zoning map.

THE PEOPLE OF THE CITY OF LOS ANGELES DO ORDAIN AS FOLLOWS:

Section 1. Section 12.04 of the Los Angeles Municipal Code is hereby amended by changing the zone and zone boundaries shown upon a portion of the zone map attached thereto and made a part of Article 2, Chapter 1 of the Los Angeles Municipal Code, so that such portion of the zoning map shall be as follows:

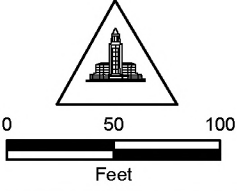
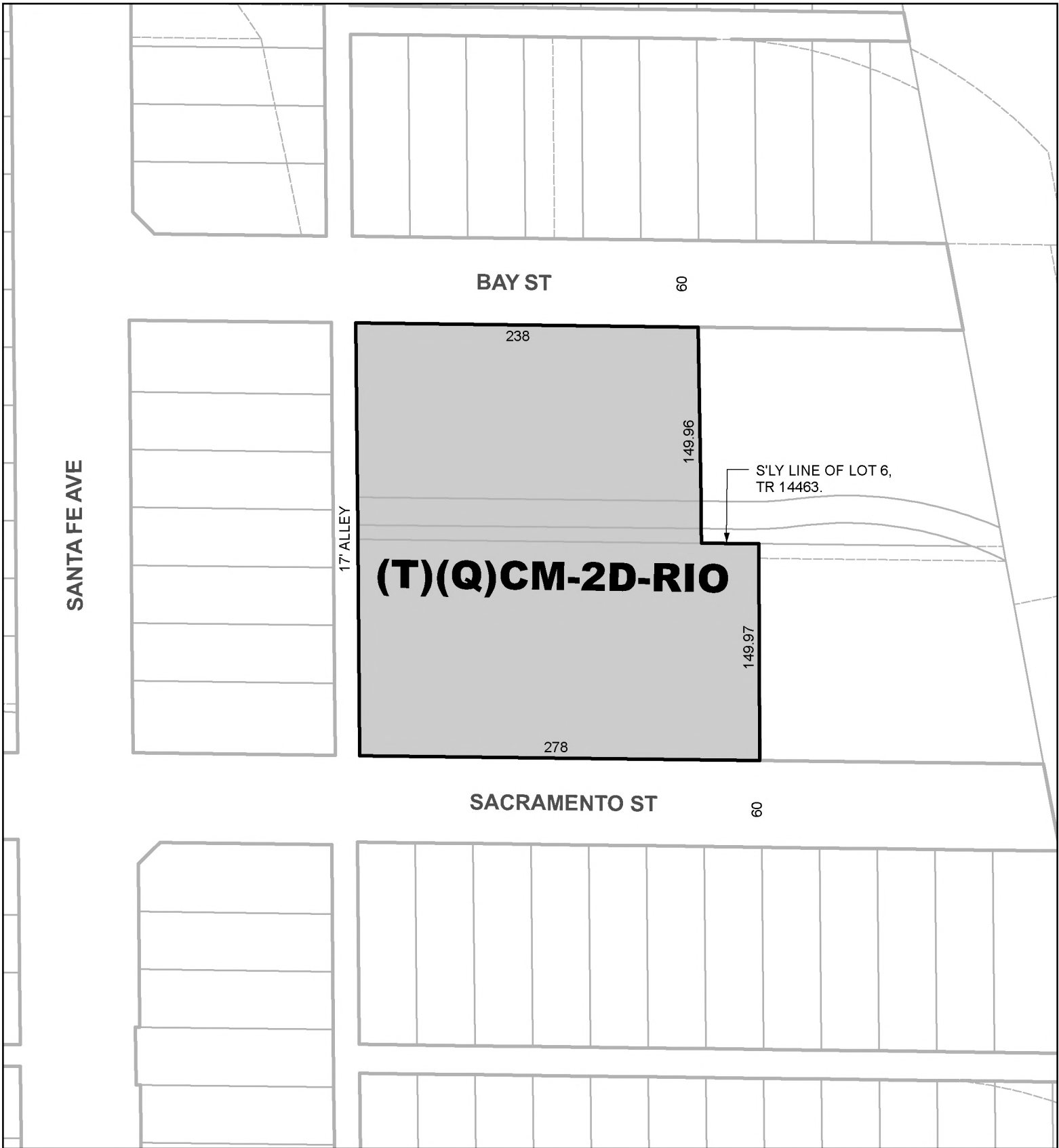

CPC-2016-3479-GPA-VZC-HD-SPR

AAI *cf* 082719

City of Los Angeles

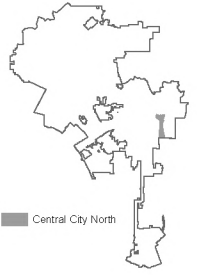

(Q) QUALIFIED CONDITIONS OF APPROVAL

(As modified by the City Planning Commission on November 14, 2019)

Pursuant to Section 12.32-G of the Municipal Code, the following limitations are hereby imposed upon the use of the subject property, subject to the "Q" Qualified classification.

A. Development Conditions:

1. **Site Development.** The use and development of the property shall be in substantial conformance with the Site Plans, Floor Plans, Building Elevations, Landscape Plan (Exhibit A, dated July 31, 2019) of the subject case file. No change to the plans will be made without prior review by the Department of City Planning, and written approval by the Director of Planning. Each change shall be identified and justified in writing. Minor deviations may be allowed in order to comply with the provisions of the Municipal Code or the project conditions.
2. **Development Services Center.** Prior to sign-off on building permits by the Department of City Planning's Development Services Center for the project, the Department of City Planning's Major Projects Section shall confirm, via signature, that the project's building plans substantially conform to the conceptual plans stamped as Exhibit "A", as approved by the City Planning Commission.

Note to Development Services Center: The plans presented to, and approved by, the City Planning Commission (CPC) included specific architectural details that were significant to the approval of the project. Plans submitted at plan check for condition clearance shall include a signature and date from Major Projects Section planning staff to ensure plans are consistent with those presented at CPC.

3. **Affordable Housing.** A minimum of 11 percent of the base density shall be reserved for households earning no more than 50 percent of the Area Median Income for Very Low Income Restricted Affordable Units, as defined by Section 50079.5 of the California Health and Safety Code, and as determined by the Los Angeles Housing and Community Investment Department (HCIDLA).

Prior to issuance of a building permit, the owner shall execute a covenant to the satisfaction of the Los Angeles Housing and Community Investment Department (HCIDLA) to make 11% of total units built available as Very Low Income Units, for sale or rental as determined to be affordable to such households by HCIDLA for a period of 55 years. Enforcement of the terms of said covenant shall be the responsibility of HCIDLA. The applicant will present a copy of the recorded covenant to the Department of City Planning for inclusion in this file. The project shall comply with the Guidelines for the Affordable Housing Incentives Program adopted by the City Planning Commission and with any monitoring requirements established by the HCIDLA.

D LIMITATIONS

Pursuant to Section 12.32-G of the Municipal Code, the following limitations are hereby imposed upon the use of the subject property, subject to the D limitation.

A. Development Limitations:

1. **Floor Area Ratio.** Floor area over the entire site, as identified in the Ordinance Map, shall not exceed 3.9:1, not to exceed a total of 287,137 square-feet of floor area.
2. **Building Height.** Building height shall be limited to a maximum height of 149 feet for the live-work tower and 100.5 feet for the office tower consistent with Exhibit A.

Sec. 2. The City Clerk shall certify to the passage of this ordinance and have it published in accordance with Council policy, either in a daily newspaper circulated in the City of Los Angeles or by posting for ten days in three public places in the City of Los Angeles: one copy on the bulletin board located at the Main Street entrance to the Los Angeles City Hall; one copy on the bulletin board located at the Main Street entrance to the Los Angeles City Hall East; and one copy on the bulletin board located at the Temple Street entrance to the Los Angeles County Hall of Records.

Pursuant to Section 558 of the City Charter, the Los Angeles City Planning Commission on **November 14, 2019** recommends this ordinance **BE ADOPTED** by the City Council.

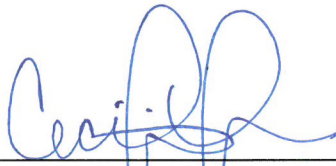
By  _____
Cecilia Lamas
Commission Executive Assistant

File No. _____

CITY CLERK

MAYOR

Ordinance Passed _____

Approved _____