

**BOARD OF TRANSPORTATION
COMMISSIONERS**

ERIC R. EISENBERG
PRESIDENT

TAFARAI BAYNE
VICE PRESIDENT

JOHN LY
CRIS LIBAN
JAZMIN ORTEGA
SHEILA TEJADA
DONNA CHOI

JASMIN SAN LUIS
ACTING COMMISSION EXECUTIVE ASSISTANT

**CITY OF LOS ANGELES
CALIFORNIA**



ERIC GARCETTI
MAYOR

DEPARTMENT OF TRANSPORTATION

100 S. MAIN STREET, 10TH FLOOR
LOS ANGELES, CA 90012

SELETA J. REYNOLDS
GENERAL MANAGER

March 13, 2020

The Honorable City Council
City of Los Angeles
City Hall, Room 395
Attention: City Clerk

Subject: **Establishment of Preferential Parking District No. 291 in the Westchester Area of Council District 11 - Corrected**

At its regular meeting of March 12, 2020, the Board of Transportation Commissioners considered the evidence presented at the public hearing and approved the above-referenced report. A copy of the Board's action is attach and hereby transmitted to the City Council for consideration and approval.

If you need further information, please contact Michelle Cayton, Supervising Transportation Planner – Parking Permits Division, at (213) 972-4935.

Sincerely,

Jasmin San Luis
Acting Commission Executive Assistant

JSL:jsl

Attachment

c: Michelle Cayton

**BOARD REPORT
CITY OF LOS ANGELES
DEPARTMENT OF TRANSPORTATION**

Date: March 12, 2020

To: Board of Transportation Commissioners

From: Seleta J. Reynolds, General Manager
Department of Transportation

Subject: **ESTABLISHMENT OF PREFERENTIAL PARKING DISTRICT NO. 291 IN THE WESTCHESTER AREA OF COUNCIL DISTRICT 11**

SUMMARY

The Los Angeles Department of Transportation (LADOT) recommends the establishment of Preferential Parking District (PPD) No. 291 in the Westchester area of Council District (CD) 11.

RECOMMENDATIONS

1. FIND that customers and employees of the businesses in the adjacent commercial district cause adverse parking impacts on the residential blocks from which the residents deserve immediate relief.
2. FIND that the establishment of PPD No. 291, pursuant to Los Angeles Municipal Code (LAMC) Section 80.58.d, is exempt from the California Environmental Quality Act (CEQA) as a Class 1 Categorical Exemption, under Article III.1.a.3 of the 2002 Los Angeles City CEQA Guidelines.
3. ADOPT the accompanying Resolution establishing the boundaries of PPD No. 291, pursuant to the City Council's March 16, 2016, "Rules and Procedures for Preferential Parking Districts," to include all blocks within the residential area bounded by the blocks indicated below:
 - both sides of Knowlton Street between La Tijera Boulevard and La Cienega Boulevard
 - centerline to the west side of La Cienega Boulevard between the alley immediately north of Knowlton Street and Thornburn Street
 - both sides of Thornburn Street between La Cienega Boulevard and La Tijera Boulevard
 - centerline to the east side of La Tijera Boulevard between Thornburn Street and Knowlton Street
4. AUTHORIZE the following parking restrictions for use on the residential portions of all streets in PPD No. 291:
 - NO PARKING 6 PM TO 8 AM, 2 HOUR PARKING 8 AM TO 6 PM; VEHICLES WITH DISTRICT NO. 291 PERMITS EXEMPT
 - NO PARKING 8 AM TO 6 PM; VEHICLES WITH DISTRICT NO. 291 PERMITS EXEMPT
 - 2 HOUR PARKING 8 AM TO 6 PM; VEHICLES WITH DISTRICT NO. 291 PERMITS EXEMPT

- NO PARKING 6 PM TO 8 AM; VEHICLES WITH DISTRICT NO. 291 PERMITS EXEMPT
5. INSTRUCT LADOT to initiate the necessary procedures for the preparation and sale of parking permits to residents within PPD No. 291, as specified in Section 80.58 of the LAMC.
 6. DIRECT LADOT to post or remove the authorized parking restrictions on the residential portions of the street segments enumerated in Recommendation No. 3, except for areas where parking is currently prohibited in the interest of traffic flow or public safety.
 7. DIRECT LADOT to post or remove the authorized parking restrictions upon receipt and validation of petitions containing signatures from at least 75 percent of the dwelling units, covering more than 50 percent of the developed frontage on a street segment requesting installation or removal of the parking restrictions set forth in Recommendation No. 4, without further action of the City Council.

BACKGROUND

The Preferential Parking Program is set forth in Section 80.58 of the LAMC. It provides for the establishment of a PPD by Resolution of the City Council, upon recommendation by LADOT, and authorizes the Department to promulgate rules and procedures to implement the City's Preferential Parking Program, which must be approved by the City Council. A request from a representative of the affected neighborhood group or by the area's Councilmember initiates the establishment of a PPD. However, the area must meet the criteria set forth in the "Rules and Procedures for Preferential Parking Districts" adopted by the City Council before establishment or expansion may be allowed.

The "Rules and Procedures for Preferential Parking Districts" approved by the City Council on March 16, 2016, allows LADOT to recommend a PPD provided all the following conditions are met:

1. Submittal and verification of petitions requesting such action signed by the residents of at least 75 percent of the dwelling units, covering more than 50 percent of the developed frontage on a minimum of six blocks.
2. Occupancy of at least 85 percent of the legal on-street parking spaces on a minimum of four blocks as determined by LADOT.
3. Board of Transportation Commissioners conducts a public hearing for the purpose of receiving comments on the preliminary findings and recommendations of LADOT.

Residents of the area designated as a PPD may purchase special parking permits. Vehicles bearing such permits are exempt from the preferential parking restrictions posted within the district for which the permit was issued. The exemption only applies to the preferential parking regulations on those signs, not to regulations of a general nature installed for traffic movement or street cleaning purposes.

Parking is currently allowed in the area, and the establishment of this PPD involves negligible or no expansion to existing use; therefore the establishment of this PPD falls within the Class 1 Categorical exemption of Section 15301(c) of the State CEQA Guidelines and of the 2002 City CEQA Guidelines, Article III.1.a.3.

DISCUSSION

On May 11, 2018, LADOT staff met with CD 11 staff and residents of this Westchester neighborhood to discuss the parking issues affecting the area. The residents sought relief and a solution to the intrusive parking in their neighborhood by the employees and customers of the businesses in the adjacent commercial district. On June 12, 2018, LADOT received the attached letter from Councilmember Mike Bonin, requesting the establishment of PPD No. 291. Councilmember Bonin, LADOT, and the residents of this Westchester community believe the establishment of PPD No. 291 will provide parking relief to the residents of the area.

Residents of the blocks listed below provided signed petitions to establish PPD No. 291 and post their blocks with the parking restriction, "No Parking 6 PM to 8 AM, 2 Hour Parking 8 AM to 6 PM; Vehicles with District No. 291 Permits Exempt", thus satisfying the petition criteria set forth in the "Rules and Procedures for Preferential Parking Districts." A block is defined as a street segment between two intersecting streets. The petitions represent at least 75 percent of dwelling units on both sides of the street covering more than 50 percent of the developed frontage on each block.

- Glasgow Avenue between Kittyhawk Avenue and Ramsgate Avenue
- Ramsgate Avenue between Glasgow Avenue and Ramsgate Place
- Ramsgate Avenue between Glasgow Avenue and the cul de sac east of Glasgow Avenue
- Glasgow Avenue between Ramsgate Avenue and Glasgow Way
- Glasgow Way between Glasgow Avenue and the cul de sac west of Glasgow Avenue
- Knowlton Place between Glasgow Way and Thornburn Street
- Thornburn Street between La Cienega Boulevard and Knowlton Place
- Glasgow Avenue between Glasgow Way and Glasgow Court
- Glasgow Court between Glasgow Avenue and the cul de sac west of Glasgow Avenue
- Glasgow Avenue between Glasgow Court and Thornburn Street
- Thornburn Street between Knowlton Place and Glasgow Avenue
- Thornburn Street between Glasgow Avenue and Ramsgate Avenue
- Kittyhawk Avenue between Thornburn Street and Ramsgate Place

Parking Analysis

LADOT staff conducted a parking study on Thursday, October 10, 2019, between 5:00 PM and 8:00 PM, and determined that at least 85 percent of the parking spaces on the following blocks were occupied, thus satisfying the parking study criteria set forth in the "Rules and Procedures for Preferential Parking Districts."

- Glasgow Avenue between Kittyhawk Avenue and Ramsgate Avenue
- Ramsgate Avenue between Glasgow Avenue and Ramsgate Place

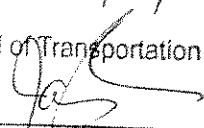
Approved:	<u>3/12/2020</u>
Board of Transportation Commissioners	
	
Commissioner	

- Thornburn Street between Ramsgate Avenue and Kittyhawk Avenue
- Thornburn Street between Kittyhawk Avenue and La Tijera Boulevard
- Kittyhawk Avenue between Thornburn Street and Ramsgate Place
- southern intersection of Kittyhawk Avenue between Ramsgate Place and the northern intersection of Kittyhawk Avenue

FISCAL IMPACT STATEMENT

Revenue from the sale of permits will cover the cost of implementing, administering, and enforcing PPD No. 291. Violations of the posted parking restrictions may result in citation fines deposited into the General Fund.

SJR:MC:at

Attachments

RESOLUTION

ESTABLISHMENT OF PREFERENTIAL PARKING DISTRICT NO. 291 IN THE WESTCHESTER AREA OF COUNCIL DISTRICT 11

WHEREAS, the Los Angeles City Council, by Ordinance No. 152,722, effective September 2, 1979, revised by Ordinance No. 157,425, effective March 18, 1983, amended by Ordinance No. 161,414, effective July 26, 1986, and further revised by Ordinance No. 171,029, effective June 1, 1996, provided for the establishment of Preferential Parking Districts (PPD) by Resolution of the City Council in each case. The latest revision was adopted by City Council on November 6, 2018, Council File 15-0600-S62, under Section 80.58 of the Los Angeles Municipal Code (LAMC); and

WHEREAS, pursuant to LAMC Section 80.58.k, the Los Angeles Department of Transportation (LADOT) promulgated "Rules and Procedures for Preferential Parking Districts", revised by Ordinance No. 177,845, effective September 30, 2006, and an amendment by Ordinance No. 180,059, adopted by the City Council on August 30, 2008, which further updated the Permit fees; and

WHEREAS, residents of this Westchester neighborhood experience difficulty finding parking on their block due to customers and employees of the businesses in the adjacent commercial district parking in the neighborhood; and

WHEREAS, LADOT made the determination that the signed petitions represent residents living in at least 75 percent of the dwelling units comprising more than 50 percent of the developed frontage on at least six blocks; and

WHEREAS, LADOT conducted parking studies which indicated that six blocks in the proposed established area have a parking occupancy of at least 85 percent of the available legal parking spaces, thus meeting the criteria set forth in the "Rules and Procedures for Preferential Parking Districts"; and

WHEREAS, LADOT determined that the petition signatures submitted represent at least 75 percent of the dwelling units on the residential portions of the 13 blocks listed below, thus meeting the criteria set forth in the "Rules and Procedures for Preferential Parking Districts," to warrant the installation of the requested preferential parking restriction signs upon City Council approval of this Resolution:

- Glasgow Avenue between Kittyhawk Avenue and Ramsgate Avenue
- Ramsgate Avenue between Glasgow Avenue and Ramsgate Place
- Ramsgate Avenue between Glasgow Avenue and the cul de sac east of Glasgow Avenue
- Glasgow Avenue between Ramsgate Avenue and Glasgow Way
- Glasgow Way between Glasgow Avenue and the cul de sac west of Glasgow Avenue
- Knowlton Place between Glasgow Way and Thornburn Street
- Thornburn Street between La Cienega Boulevard and Knowlton Place
- Glasgow Avenue between Glasgow Way and Glasgow Court
- Glasgow Court between Glasgow Avenue and the cul de sac west of Glasgow Avenue
- Glasgow Avenue between Glasgow Court and Thornburn Street
- Thornburn Street between Knowlton Place and Glasgow Avenue
- Thornburn Street between Glasgow Avenue and Ramsgate Avenue
- Kittyhawk Avenue between Thornburn Street and Ramsgate Place

NOW THEREFORE BE IT RESOLVED, that the Resolution be adopted by the City Council, establishing PPD No. 291 to include all residential portions of the street segments located within the following boundaries below:

- both sides of Knowlton Street between La Tijera Boulevard and La Cienega Boulevard
- centerline to the west side of La Cienega Boulevard between the alley immediately north of Knowlton Street and Thornburn Street
- both sides of Thornburn Street between La Cienega Boulevard and La Tijera Boulevard
- centerline to the east side of La Tijera Boulevard between Thornburn Street and Knowlton Street

BE IT FURTHER RESOLVED, that LADOT be authorized to post or remove the following preferential parking restrictions on any of the blocks within the district, without further action of the City Council, upon receipt and verification of requisite petition(s) as provided for in the adopted "Rules and Procedures for Preferential Parking Districts":

- NO PARKING 6 PM TO 8 AM, 2 HOUR PARKING 8 AM TO 6 PM; VEHICLES WITH DISTRICT NO. 291 PERMITS EXEMPT
- NO PARKING 8 AM TO 6 PM; VEHICLES WITH DISTRICT NO. 291 PERMITS EXEMPT
- 2 HOUR PARKING 8 AM TO 6 PM; VEHICLES WITH DISTRICT NO. 291 PERMITS EXEMPT
- NO PARKING 6 PM TO 8 AM; VEHICLES WITH DISTRICT NO. 291 PERMITS EXEMPT

BE IT FURTHER RESOLVED, that LADOT be authorized to post or remove the "NO PARKING 6 PM TO 8 AM, 2 HOUR PARKING 8 AM TO 6 PM; VEHICLES WITH DISTRICT NO. 291 PERMITS EXEMPT" restriction on the residential portions of the following blocks, for which residents provided signed petitions which met the petition criteria set forth in the "Rules and Procedures for Preferential Parking districts," without further action of the City Council:

- Glasgow Avenue between Kittyhawk Avenue and Ramsgate Avenue
- Ramsgate Avenue between Glasgow Avenue and Ramsgate Place
- Ramsgate Avenue between Glasgow Avenue and the cul de sac east of Glasgow Avenue
- Glasgow Avenue between Ramsgate Avenue and Glasgow Way
- Glasgow Way between Glasgow Avenue and the cul de sac west of Glasgow Avenue
- Knowlton Place between Glasgow Way and Thornburn Street
- Thornburn Street between La Cienega Boulevard and Knowlton Place
- Glasgow Avenue between Glasgow Way and Glasgow Court
- Glasgow Court between Glasgow Avenue and the cul de sac west of Glasgow Avenue
- Glasgow Avenue between Glasgow Court and Thornburn Street
- Thornburn Street between Knowlton Place and Glasgow Avenue
- Thornburn Street between Glasgow Avenue and Ramsgate Avenue
- Kittyhawk Avenue between Thornburn Street and Ramsgate Place

BE IT FURTHER RESOLVED, that LADOT be directed to take appropriate steps to prepare, issue, and require payments for permits from the residents of PPD No. 291 in accordance with LAMC, and Rules and Procedures adopted by the City Council for PPDs.



MIKE BONIN

City of Los Angeles
Councilmember, Eleventh District

May 29, 2018

Seleta Reynolds, General Manager
Los Angeles Department of Transportation
100 S. Main St, 10th Floor
Los Angeles, CA 90012
Mail Stop 725

Dear Ms. Reynolds,

My staff has been working with residents of Westchester to address ongoing and increasing parking concerns in the area. The residential neighborhood at this location is adjacent to Park Westchester Business Center in the north. The neighbors in this small community are experiencing a regular onslaught of employee related parking in their neighborhood. Rather than pay to park elsewhere, drivers park their vehicles in the neighborhood and crowd residential streets, leaving few, if any, spaces for residents.

On behalf of the community, I am requesting the creation of a Preferential Parking District (PPD) with restrictions, "No Parking 6pm - 8am; 2 hour parking from 8am - 6pm except by permit" for the following street segments:

- Thornburn St between La Cienega Blvd and Knowlton Pl
- Thornburn St between Knowlton Pl and Glasgow Ave
- Thornburn St between Glasgow Ave and Ramsgate Ave
- Thornburn St between Ramsgate Ave and Kittyhawk Ave
- Thornburn St between Kittyhawk Ave and La Tijera Blvd
- Kittyhawk Ave between Thornburn St and Ramsgate Pl
- Kittyhawk Ave between Ramsgate Pl and Kittyhawk Ave
- Glasgow Ave between Kittyhawk Ave and Ramsgate Ave
- Glasgow Ave between Ramsgate Ave and Glasgow Way
- Glasgow Ave between Glasgow Way and Glasgow Ct

Westchester Office
2166 W. Manchester Boulevard
Los Angeles, CA 90045
(310) 568-8772
(310) 410-3946 Fax

City Hall
200 N. Spring Street, Room 475
Los Angeles, CA 90012
(213) 473-7011
(213) 473-6926 Fax

West Los Angeles Office
1645 Corinth Avenue, Room 201
Los Angeles, CA 90025
(310) 575-8461
(310) 575-8305 Fax



- Glasgow Ave between Glasgow Ct and Thornburn St
- Ramsgate Pl between between Kittyhawk Ave and Ramsgate Ave
- Ramsgate Ave between Glasgow Ave and the east end of the cul de sac
- Ramsgate Ave between Glasgow Ave and Thornburn St
- Glasgow Ct between Glasgow Ave and the west end of the cul de sac
- Glasgow Way between Glasgow Ave and the west end of the cul de sac
- Glasgow Way between Glasgow Ave and Knowlton Pl
- Knowlton Pl between Glasgow Way and Thornburn St

Thank you for your assistance with this request. Please contact my Field Deputy Chuy Orozco at chuy.orozco@lacity.org, or (310) 568-8772 should you have any questions.

Regards,

A handwritten signature in black ink, appearing to read "Mike Bonin". The signature is fluid and cursive, with the first name "Mike" and last name "Bonin" clearly distinguishable.

MIKE BONIN

Councilmember, 11th District

cc: Aron Thompson, LADOT Preferential Parking, Mail Stop 735-4



CITY OF LOS ANGELES - DEPARTMENT OF TRANSPORTATION
PREFERENTIAL PARKING DISTRICT NO. 291
COUNCIL DISTRICT NO. 11
Western Enforcement

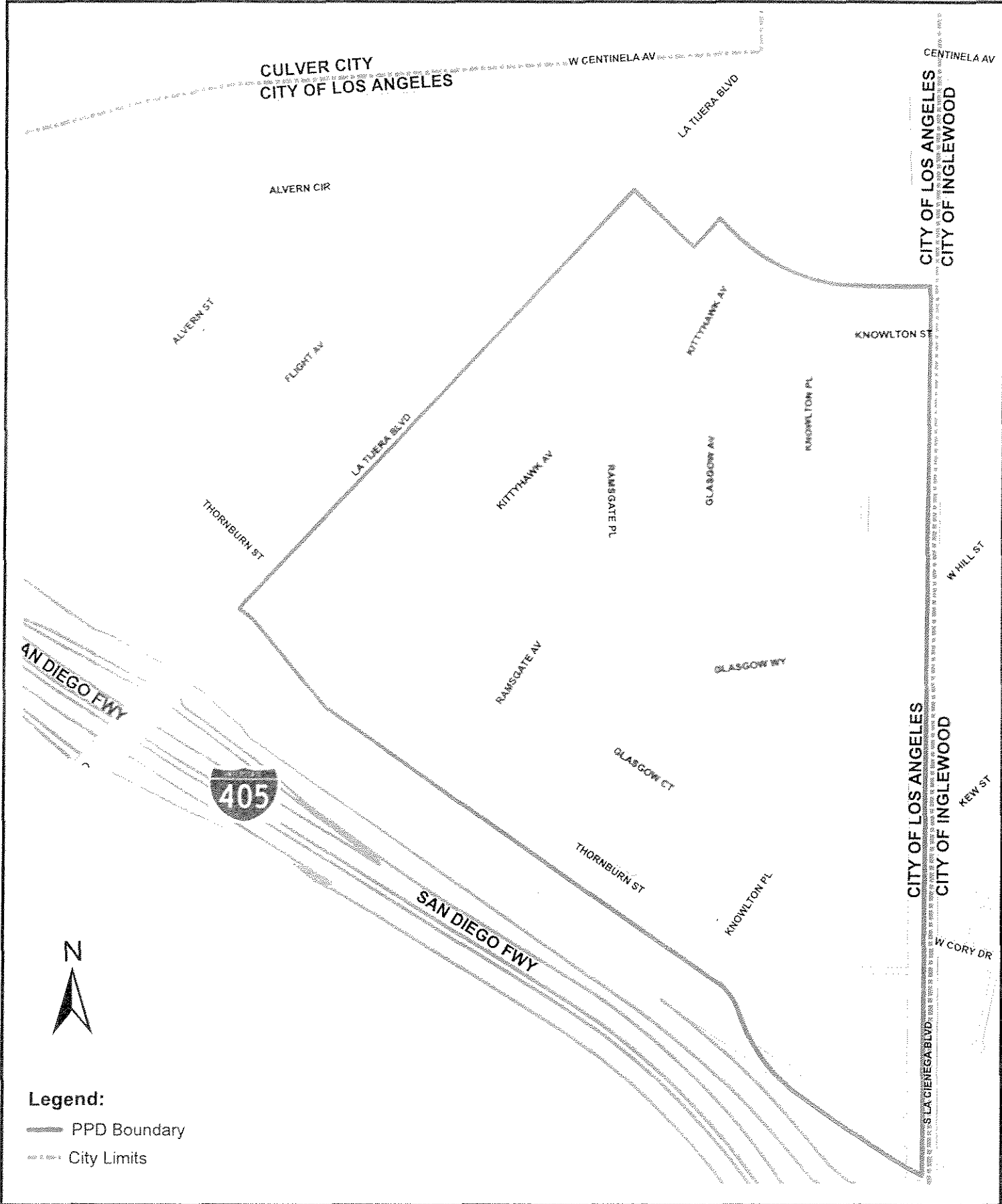

Legend:

- PPD Boundary
- City Limits



CITY OF LOS ANGELES - DEPARTMENT OF TRANSPORTATION
PREFERENTIAL PARKING DISTRICT NO. 291
 COUNCIL DISTRICT NO. 11
 PETITION, PARKING STUDY & LANDUSE

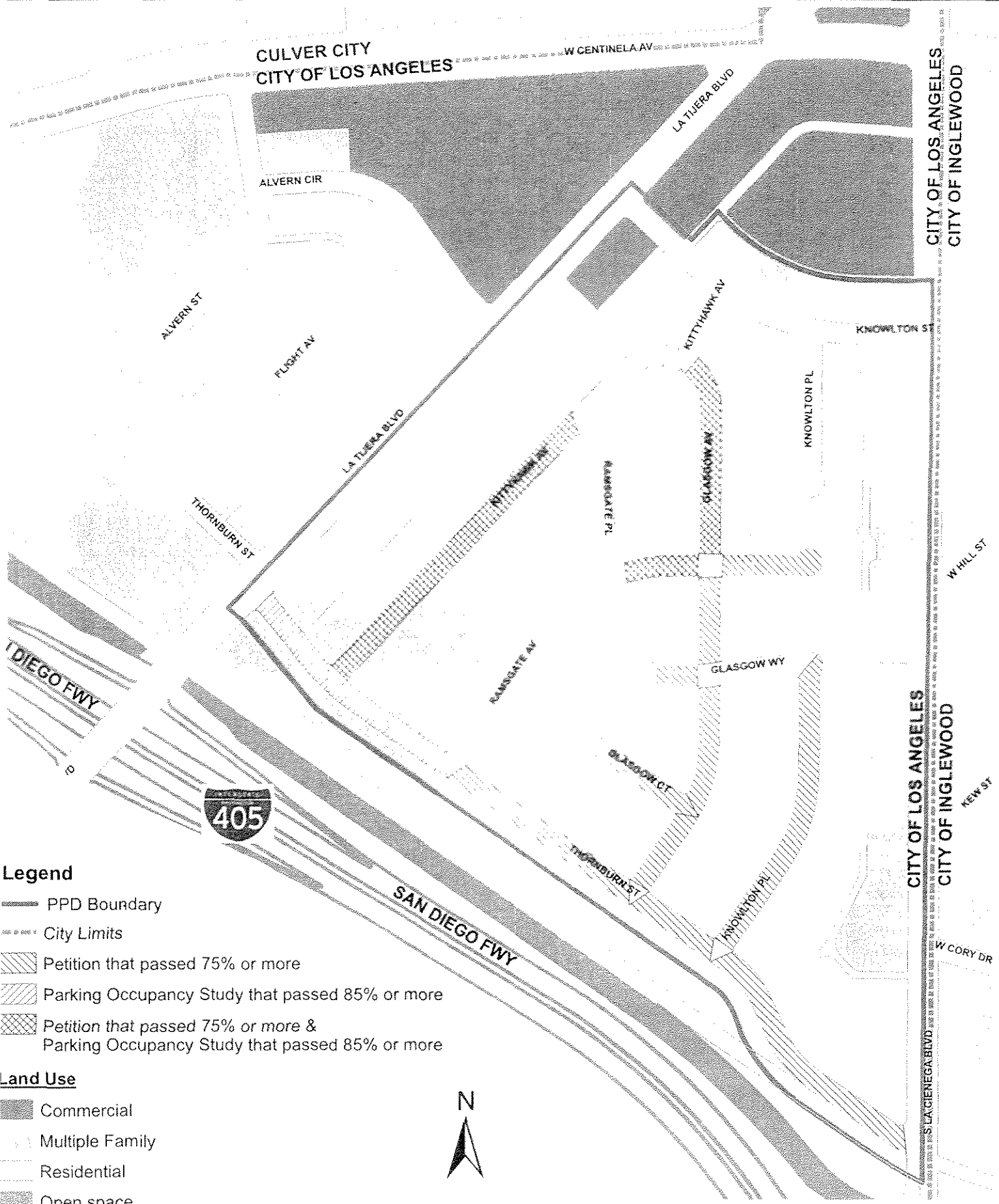

Legend

- PPD Boundary
- City Limits
- Petition that passed 75% or more
- Parking Occupancy Study that passed 85% or more
- Petition that passed 75% or more & Parking Occupancy Study that passed 85% or more

Land Use

- Commercial
- Multiple Family
- Residential
- Open space

