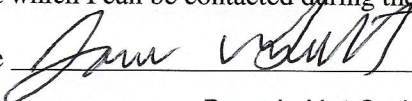

DATE September 27, 2022

BUREAU OF ENGINEERING
PERMIT CASE MANAGEMENT DIVISION
LAND DEVELOPMENT GROUP
201 N. Figueroa Street, Suite 290, Los Angeles, CA 90012

APPLICATION FOR ACCEPTANCE OF FUTURE STREET, ALLEY, OR OTHER
MISCELLANEOUS RIGHT-OF-WAY

1. Applicant (s) Jason Grant (Print)
(Full Name)
- 1999 Avenue of the Stars, Suite 2500 Los Angeles 90067
(Address) (City) (Zip)
- are the owner (s) ___ or representatives (s) X of the owner (s) of the properties shown on the attached sketch or described below.
2. The acceptance is for a () future alley (X) future street () other _____
located at 308-312 N. Oxford Avenue Los Angeles, CA 90004
- Property description: (Lots 25 & 27)(Tract: Allan-Dale)
Lot No., Tract No.
3. The project lies within or is shown on:
- (a) Engineering District: (Check appropriately)
(X) Central () Harbor () Valley () West Los Angeles
- (b) Council District No. 13
4. Document or Map which dedicated the future right-of-way 85-424878 and 85-424880
5. Reasons that the acceptance of the future right-of-way is necessary _____ as the current dedication offer
is inconsistent with the City's Mobility Plan Requirement. Only a 3-foot dedication is needed (see Attachment A)
6. The phone number at which I can be contacted during the day (310) 488-4446
7. Applicant's signature  09/27/22
8. Name and address of the Owner (s) Beverly Hot Springs Inc - Eddie Huh
(Full Name)

308 N. Oxford Avenue Los Angeles, CA 90004

(Address)

(City)

(Zip)

Exhibit A

308-312 N. Oxford Rejection Application

Per documents 85-424878 and 85-424880, two 15-foot dedications are proposed along N Oxford Ave. (see documents included in packet)

Per Navigate LA, North Oxford Avenue is designated as a "Collector" Street.

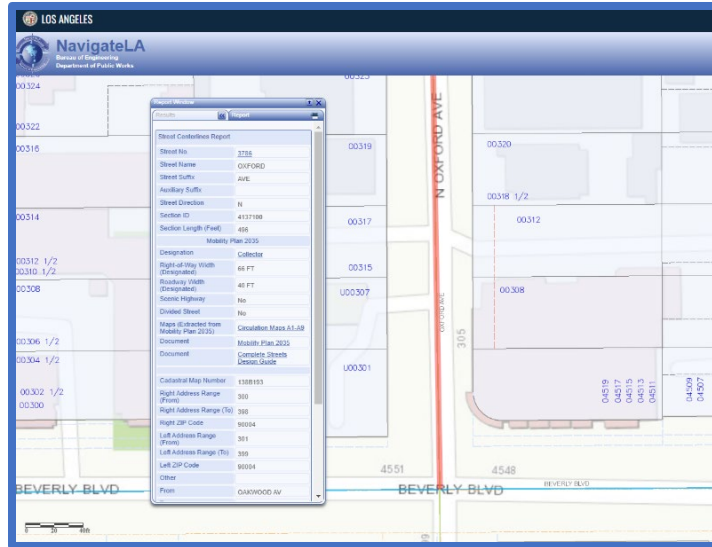

Per the Mobility Plan 2035, collector streets require a 66 ft. right of way width (33 ft. for the site), a 40 ft. roadway width (20 ft. for the site) and a 13 ft. sidewalk.

NON-ARTERIAL STREETS

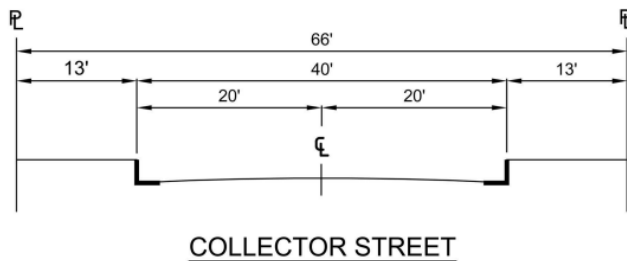

Per the included ALTA Survey plan (titled 308 N Oxford Ave- ALTA Survey), the site is providing a 30 ft. right of way width.

In order to meet the requirements set by the Mobility Plan, a 3 ft. requirement is needed to increase the right of way width to 33 ft.